

Clear Prop!

ADVANCED



PQ-14A/B CULVER

1:72

model # C72036



scale model kit

SPAN: 128.2 mm

LENGTH: 81.9mm

NUMBER OF PARTS: 80 pcs

- 1** stages of assembly
- ?** optional
- A** variants of assembly
- glue by super glue
- A1** part number
- do not glue
- fill with putty
- make a hole
- 1** apply decals
- detach with knife
- apply the adhesive mask
- paint
- bend
- repeat the operation N times

Role	target drone
National origin	USA
Manufactured	Culver Aircraft Company
First flight	1942
Primary users	USAC, USN, USAF.
Produced	1942 - 1946
Number built	2043

The Culver PQ-14 Cadet is a modified version of the Culver LFA Cadet, used as a target drone. In 1940, the US Army Air Corps issued a requirement for a radio-controlled target drone for gunner training anti-aircraft artillery. The first aircraft in the series of target drones was the Culver LFA Cadet modification, which ultimately led to the creation of the PQ-14 series, used throughout World War II the war and after it.

Culver proposed a modification of his civilian LFA Cadet model, which the Army purchased as the PQ-8. Success of the PQ-8 led to the development of "NRD"; the only PQ-8 was converted to a new configuration and tested by the USAF as XPQ-14. Larger and faster than the PQ-8, the PQ-14 also had retractable landing gear, and the fuselage, wings and components. The tail fins were made of wood with a loaded plywood skin. This prototype was followed by the YPQ-14A service test aircraft and 1,348 production PQ-14A models.

Of the latter, 1,198 were transferred to the US Navy, which designated them TD2C-1 with a decidedly unattractive called Turkey. A total of 594 PQ-14Bs served as target drones for the US Air Force. The only PQ-14B was converted to use the O-300-9 engine and designated XPQ-14C.

REQUIRED PAINTS



MR. COLOR 3
RED



MR. COLOR 1
WHITE



MR. COLOR 2
BLACK



MR. COLOR 137
TIRE BLACK



MR. COLOR 8
SILVER



MR. COLOR MC214
DARK IRON



MR. COLOR MC211
CHROME SILVER



MR. COLOR 219
BRASS



MR. COLOR 113
WOOD



MR. COLOR 313
WOOD



MR. COLOR C364
GREY GREEN



MR. COLOR C308
GREY



MR. COLOR 327
RED



MR. COLOR 4
YELLOW

THIS MODEL IS PRODUCED FOR EXPERIENCED MODELERS OVER 14 YEARS

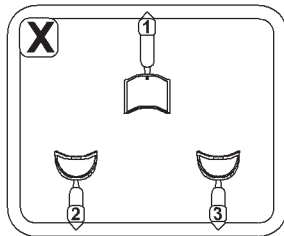
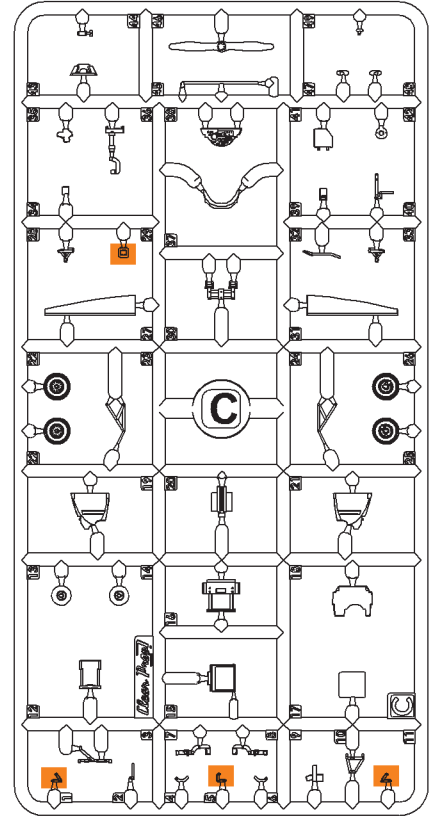
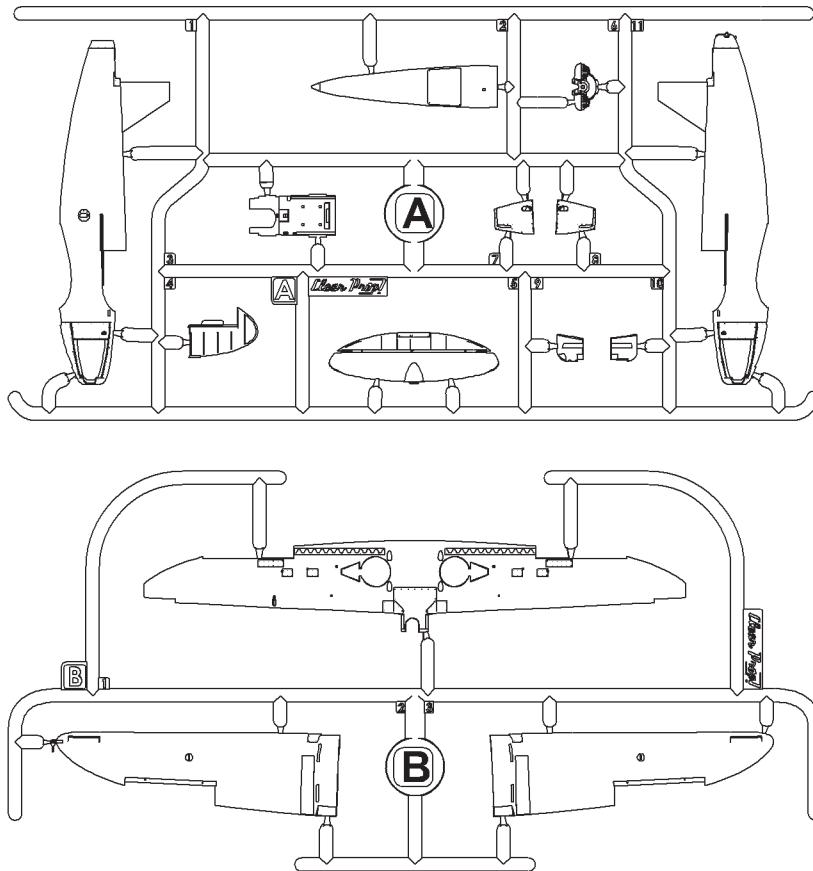

PHOTOETCHED PARTS

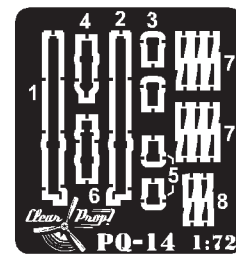

DECAL SHEET

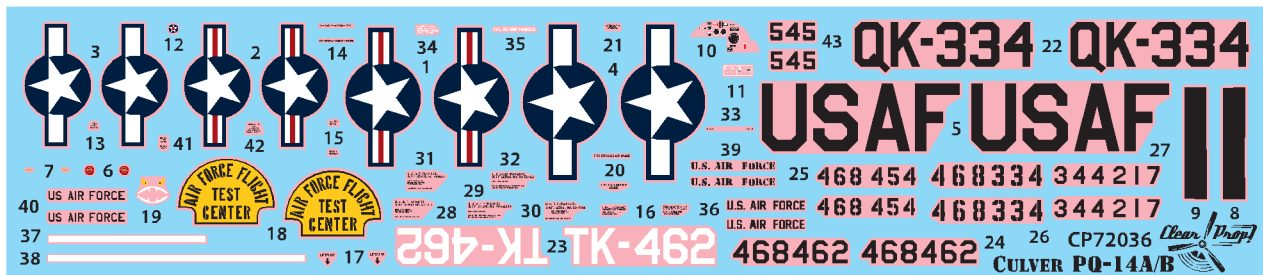

Parts not for use

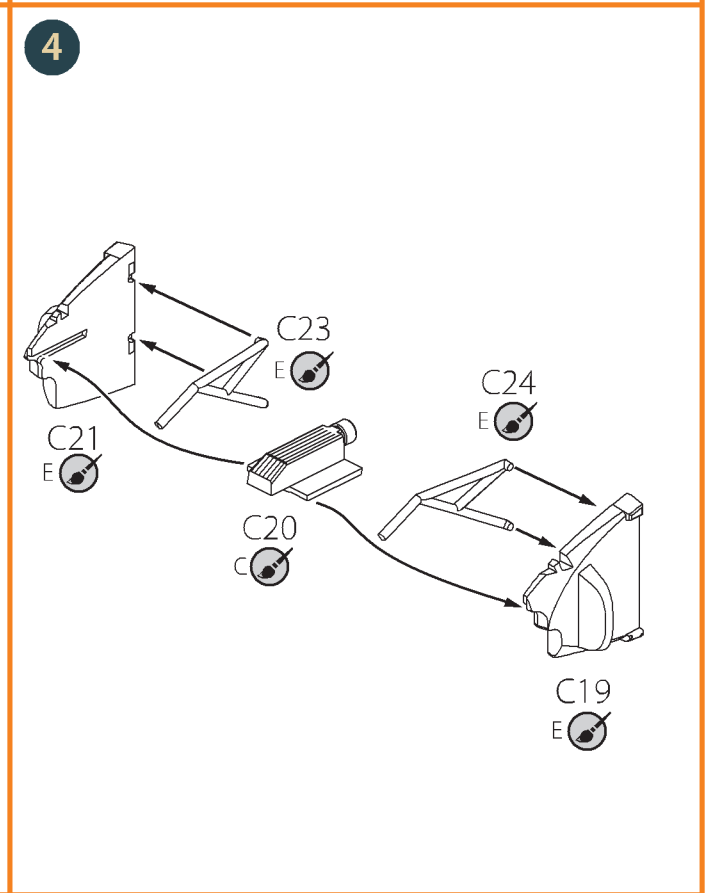
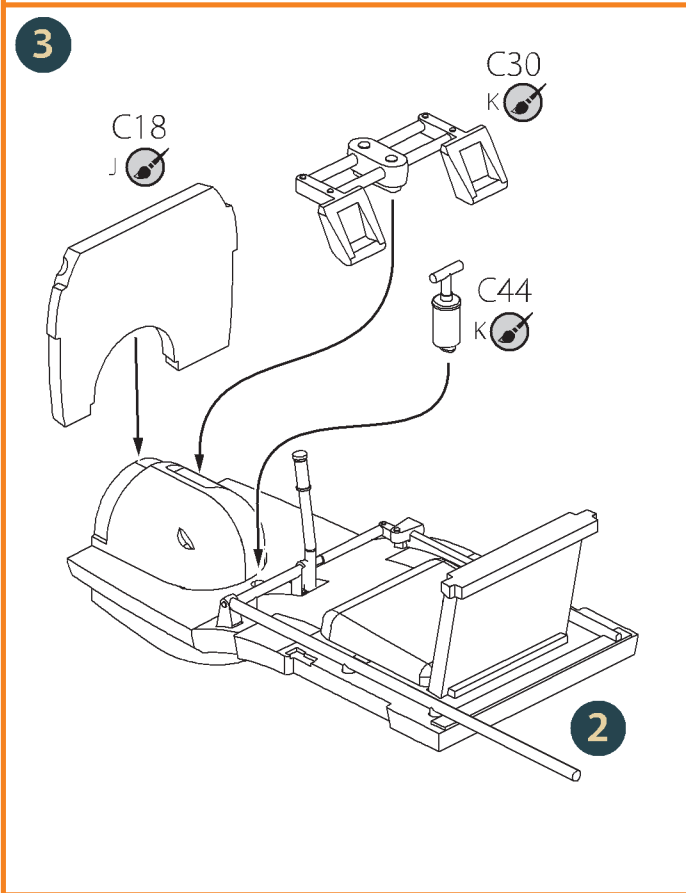
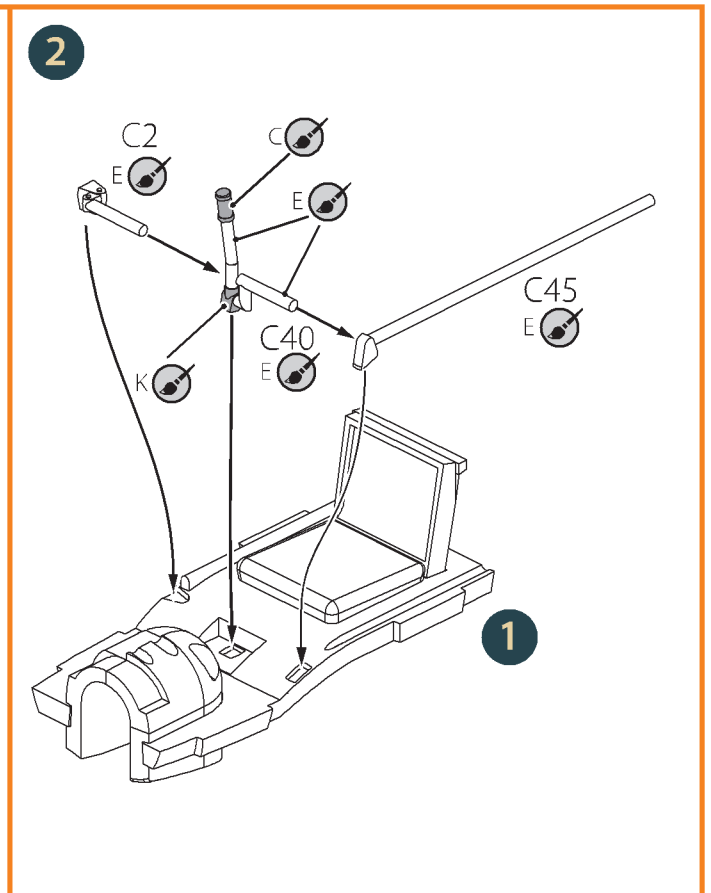
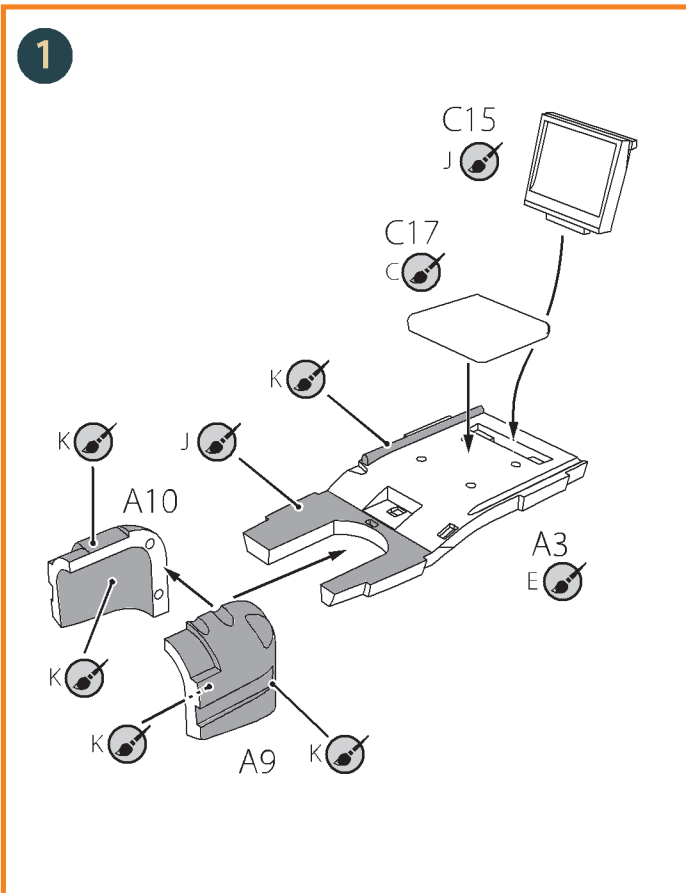

5

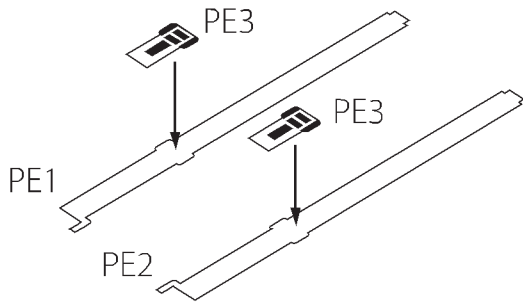

6

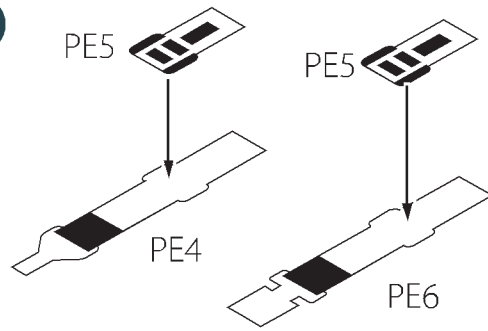

7

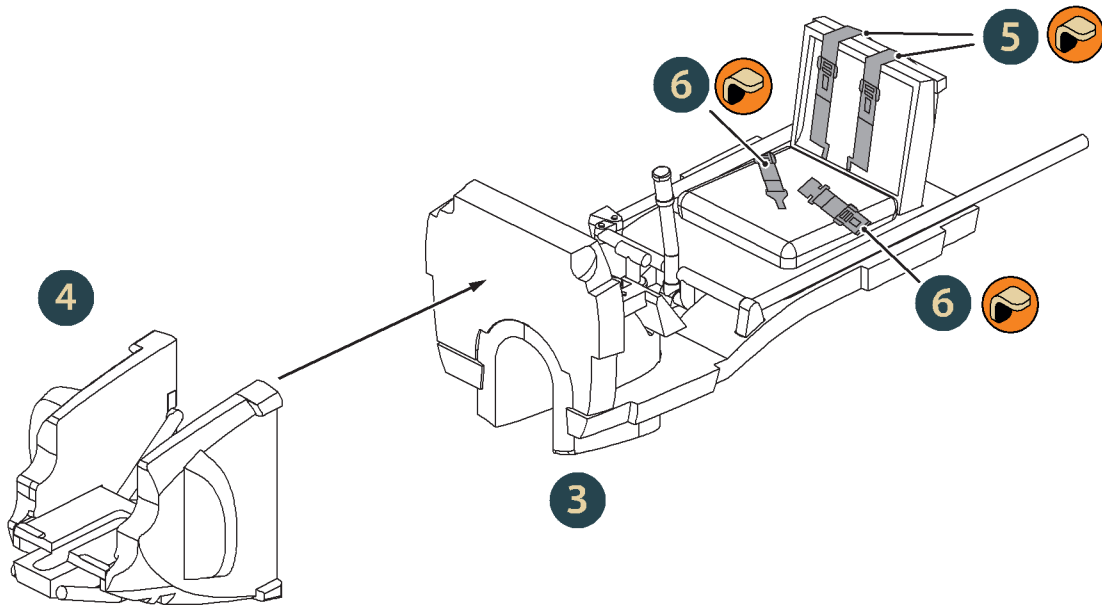

8

FOR PAINT SCHEME ① ② ③

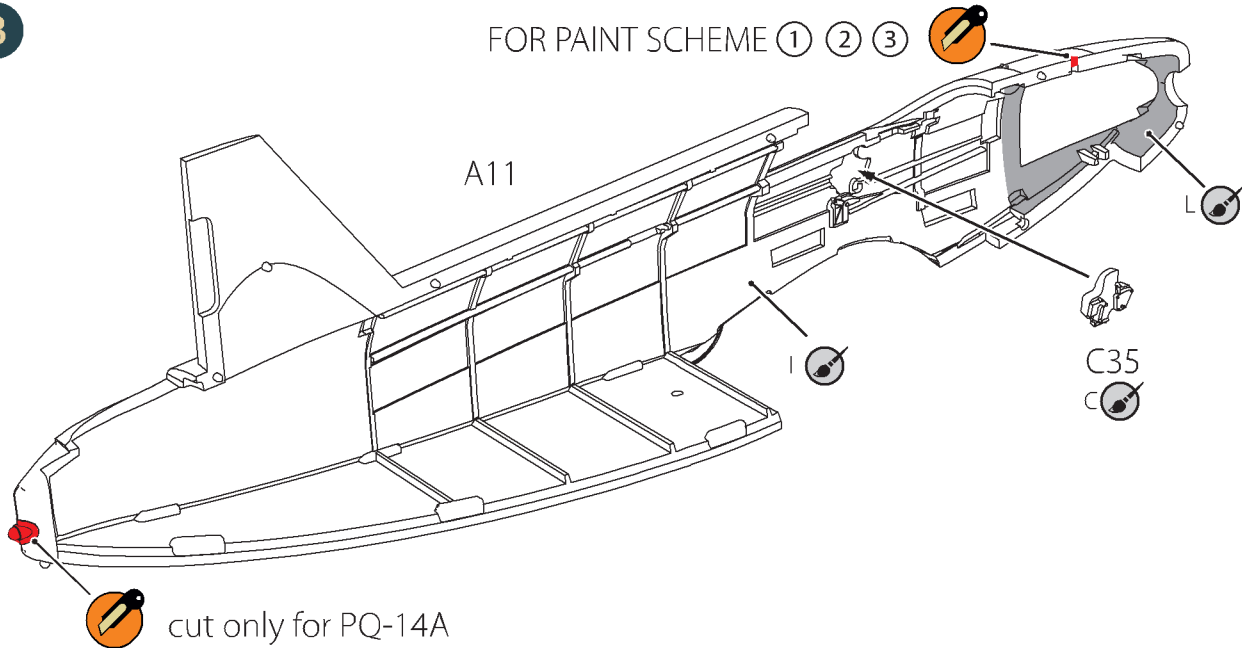

9 FOR PAINT SCHEME ① ② ③

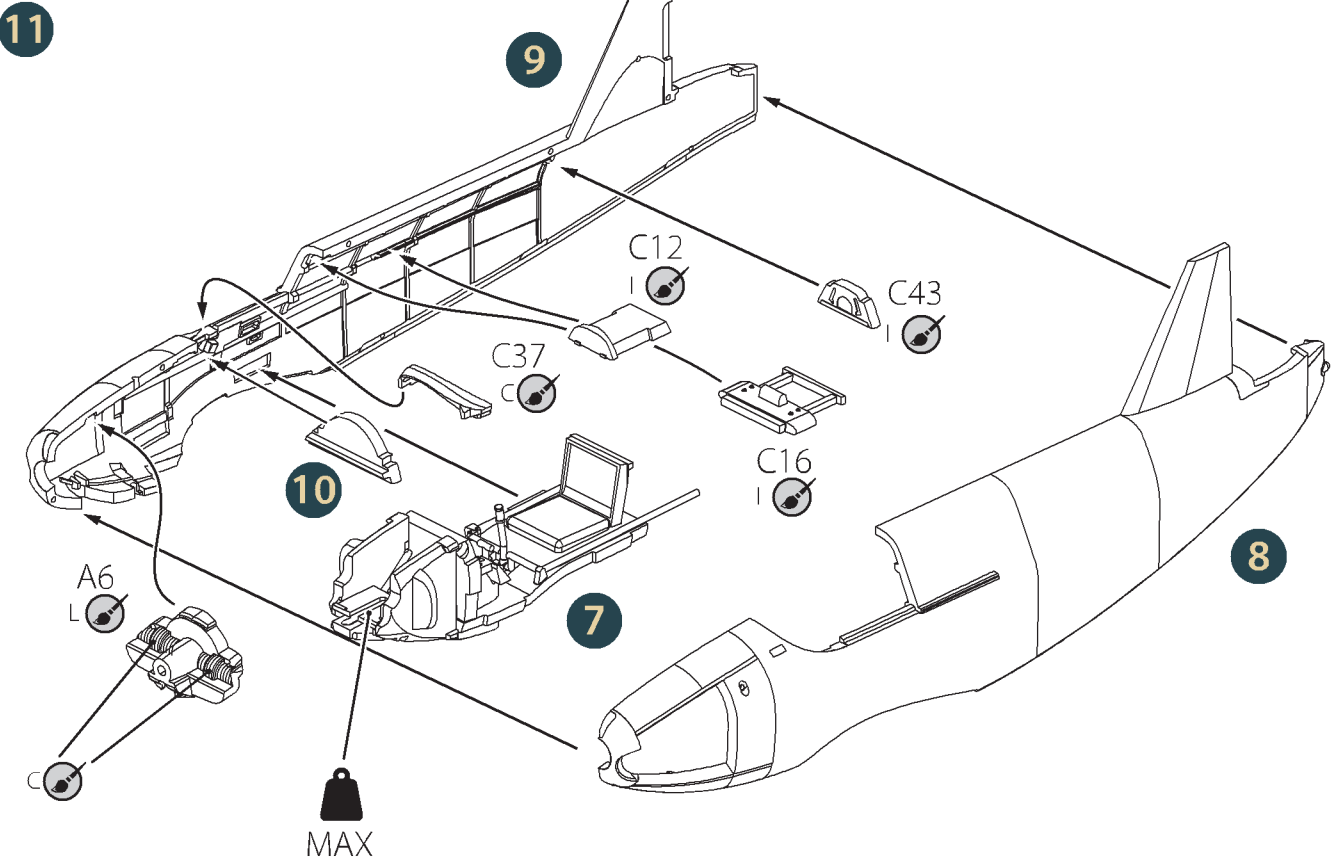
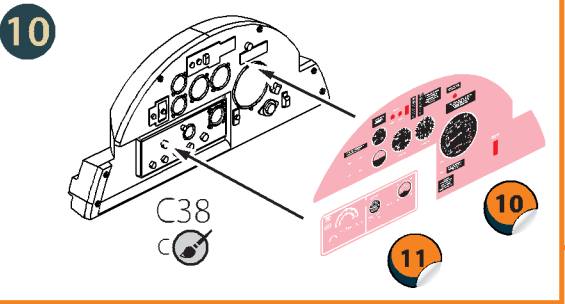
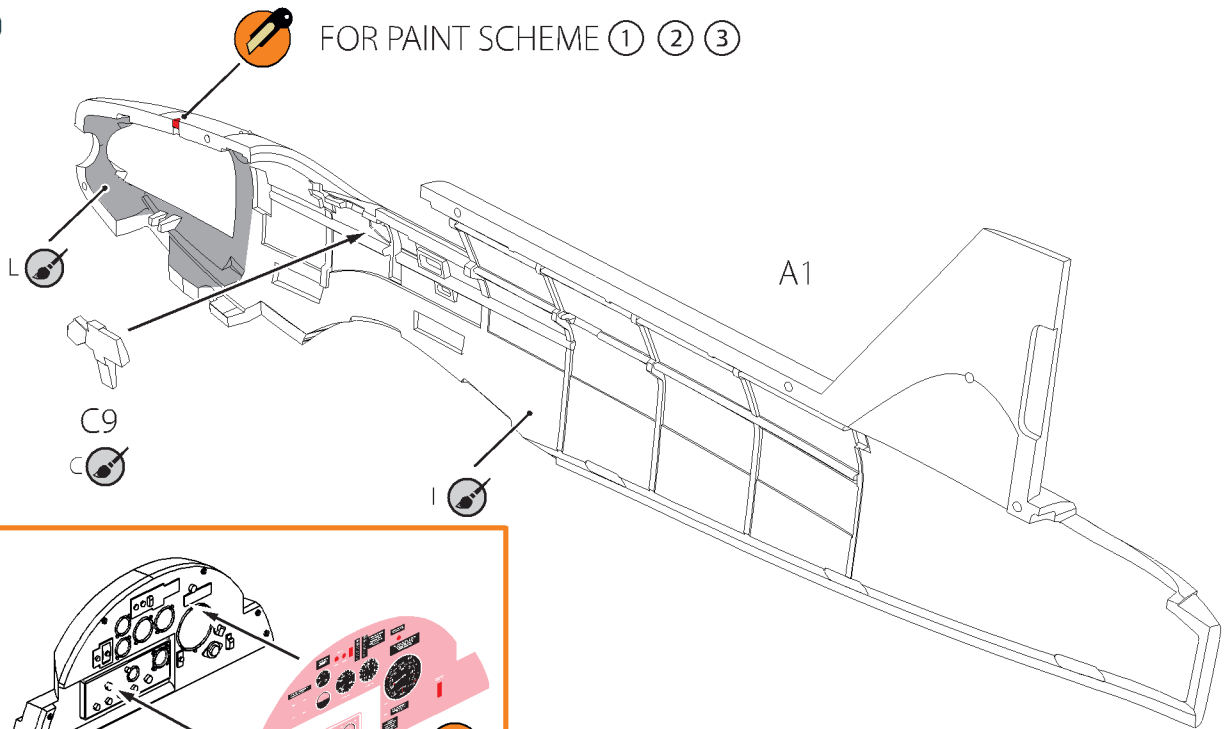

12

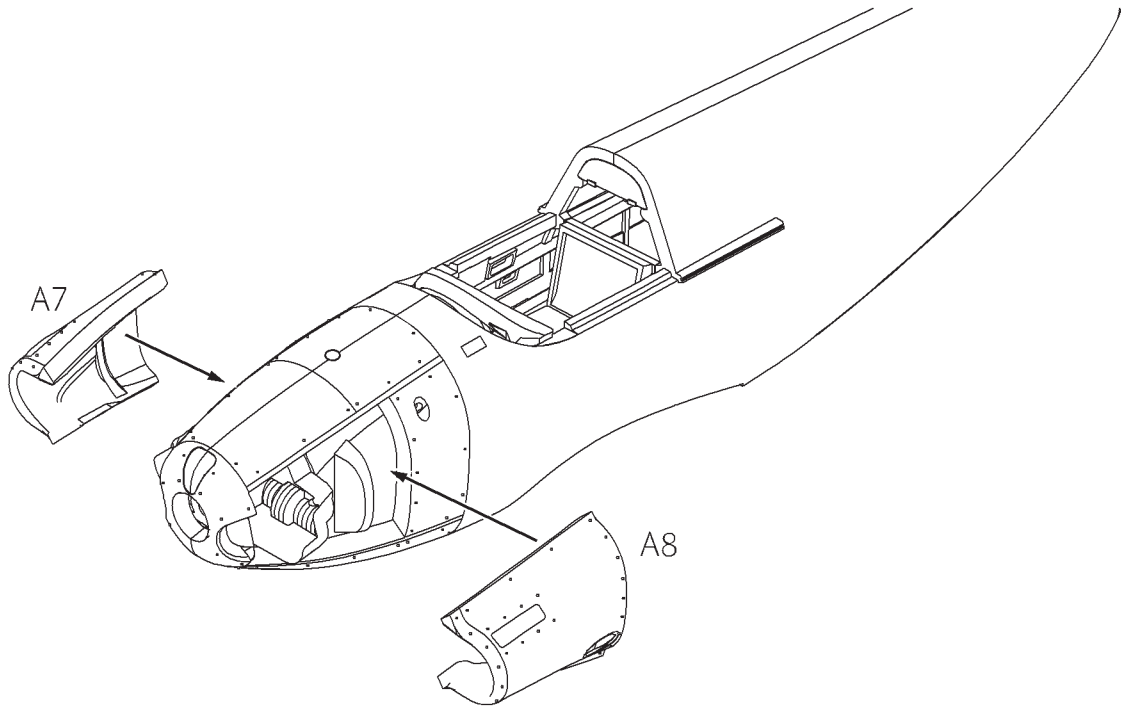

13

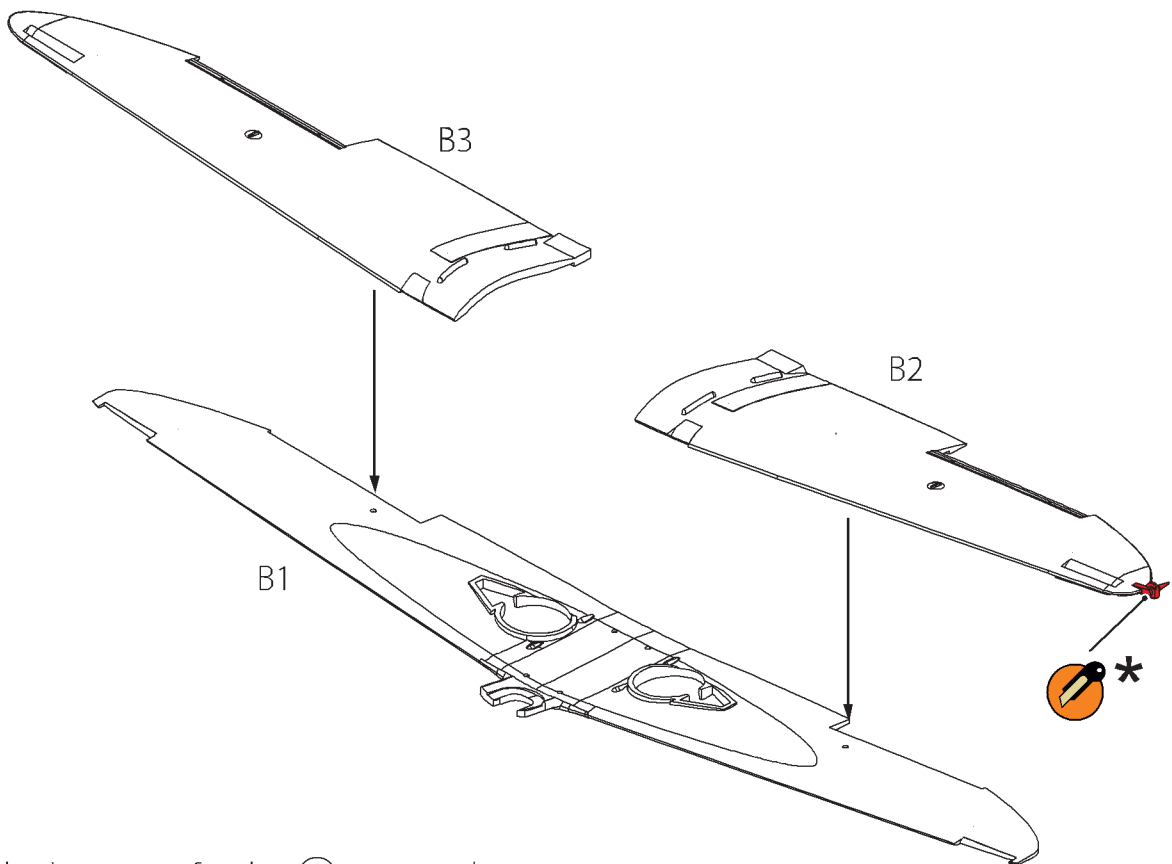

* don't cut just for the ② paint scheme

14

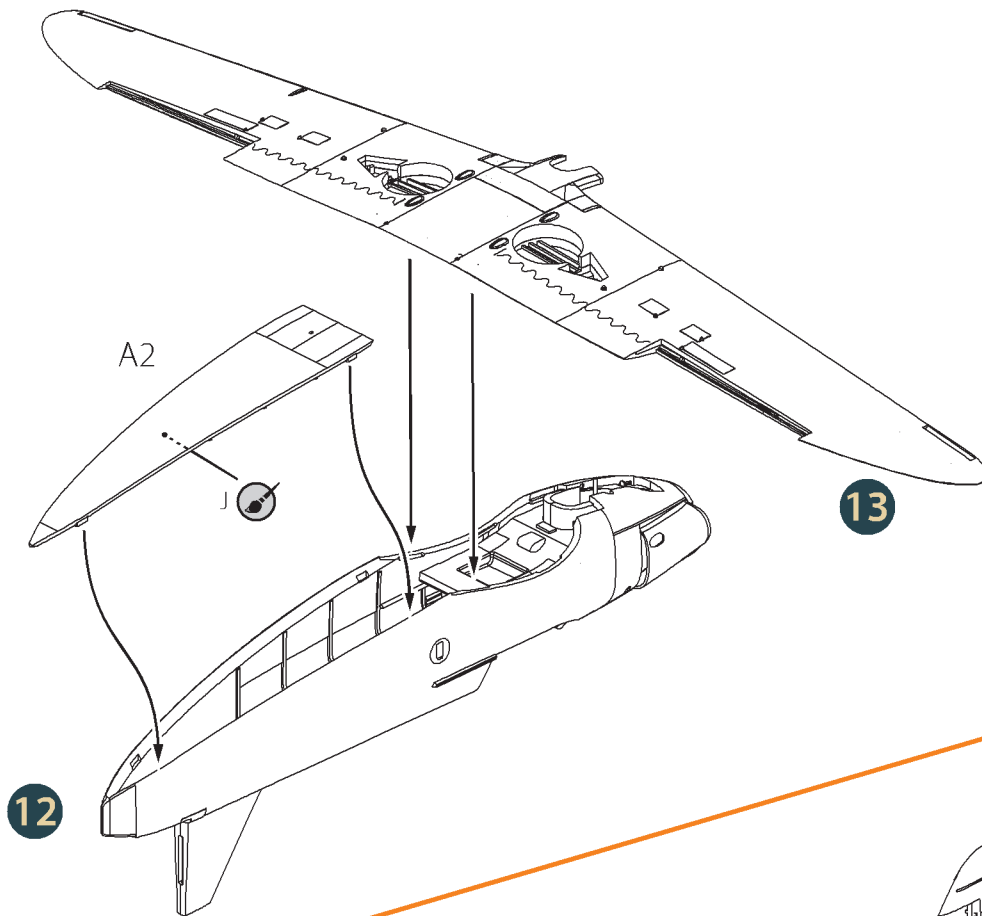

12

13

A2

J

A4

A5

C27

14

C31

15

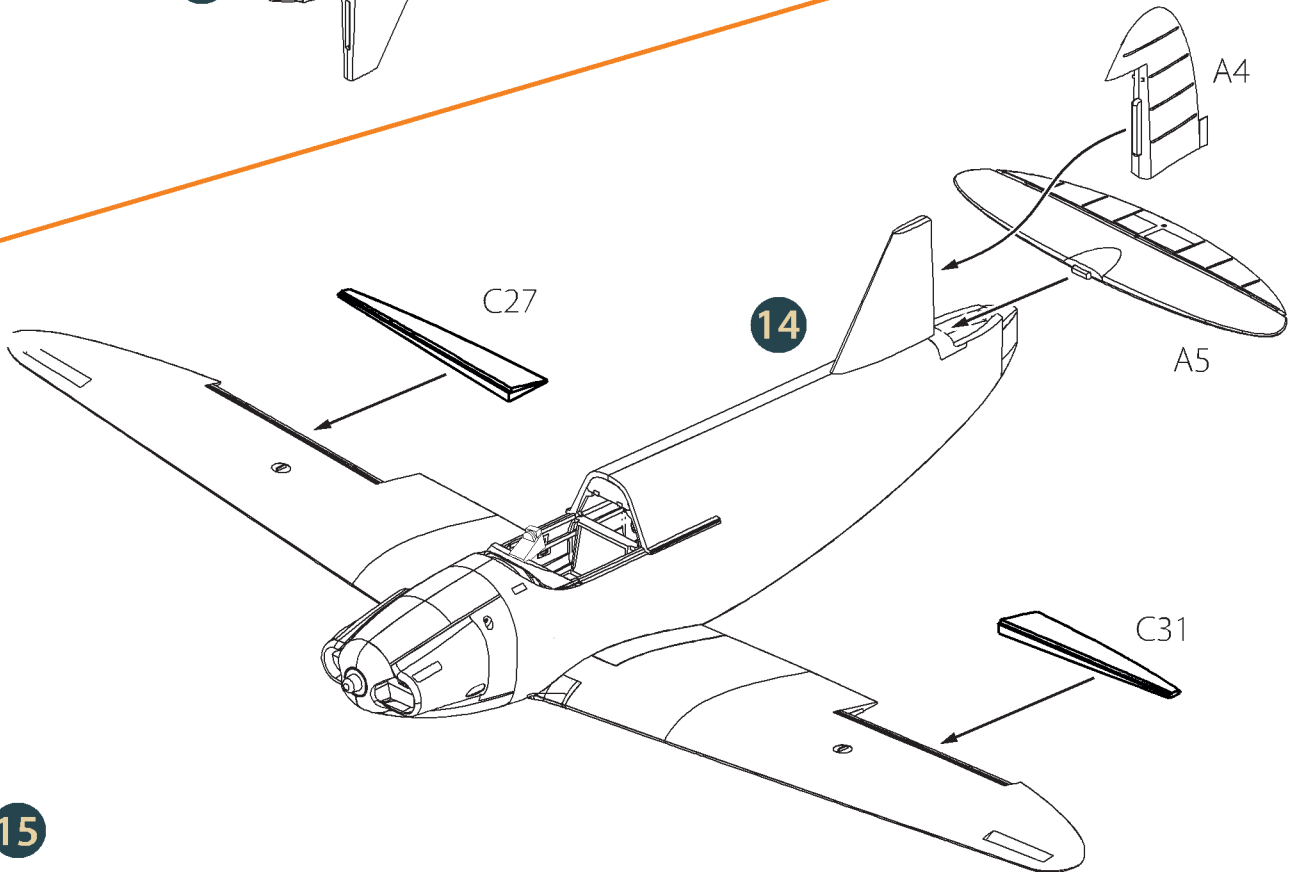

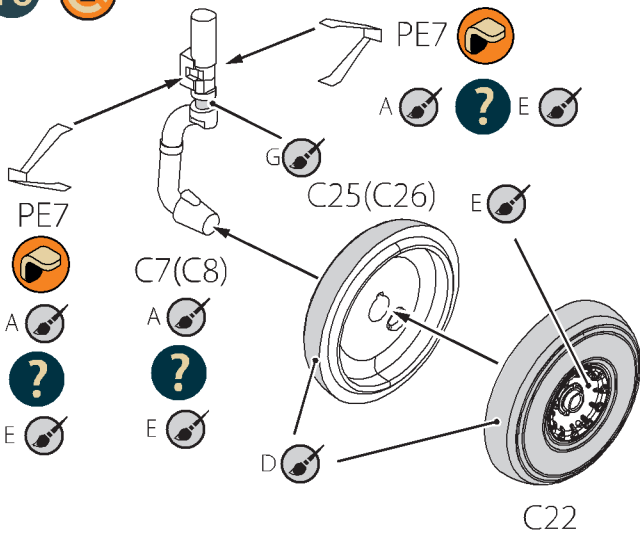
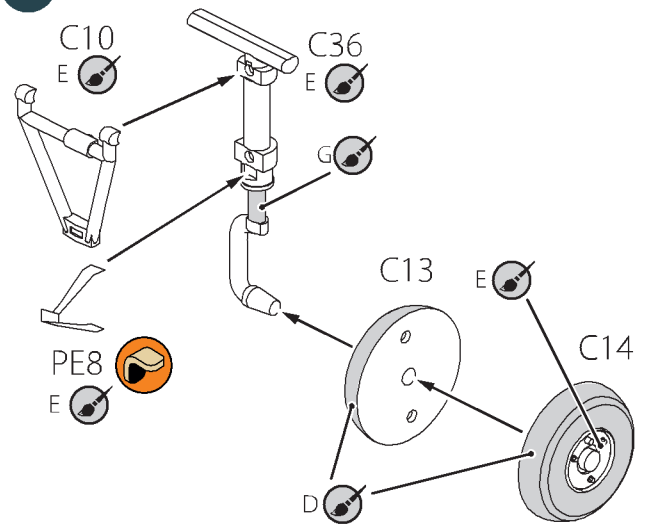
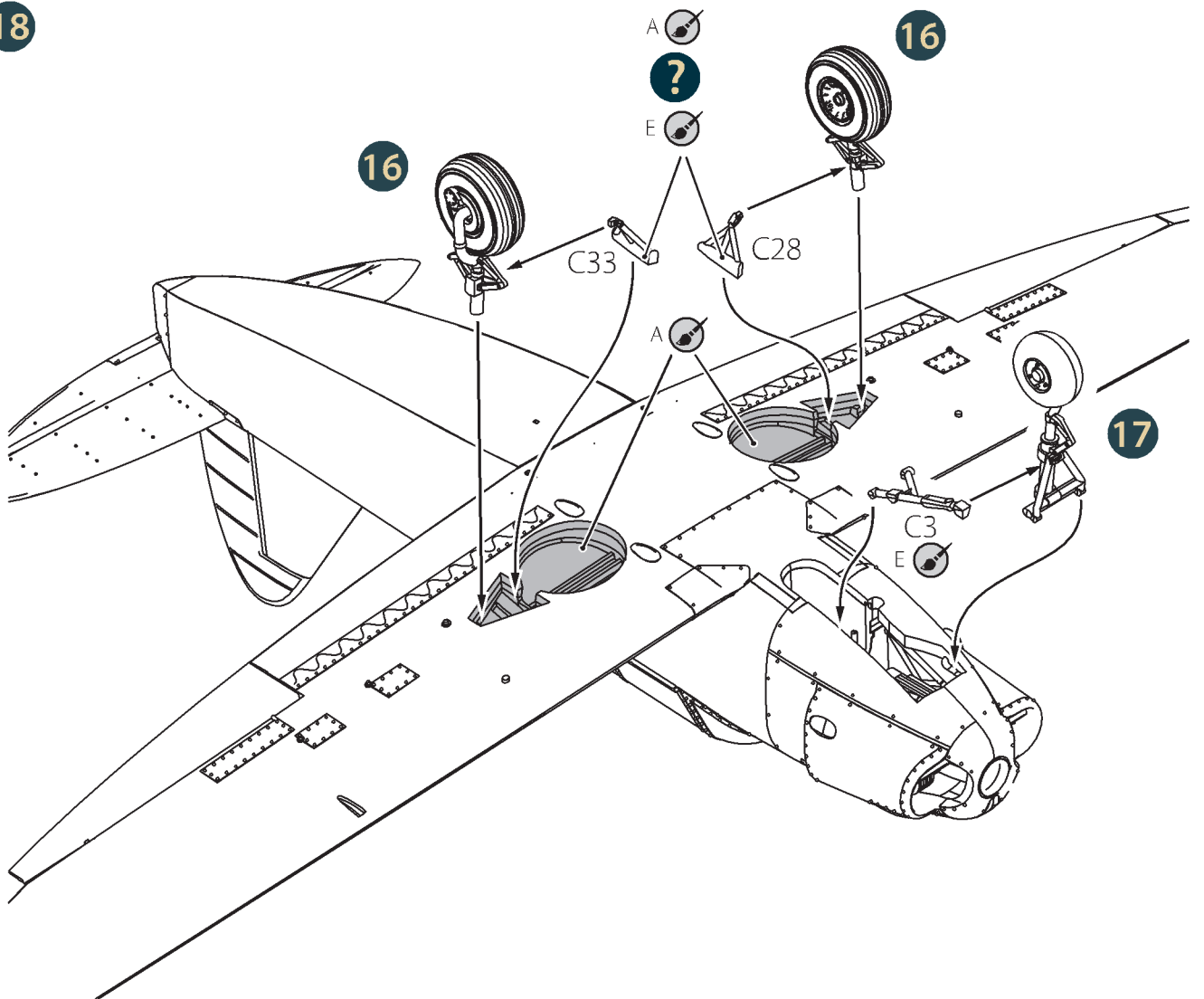
16 **2**

17

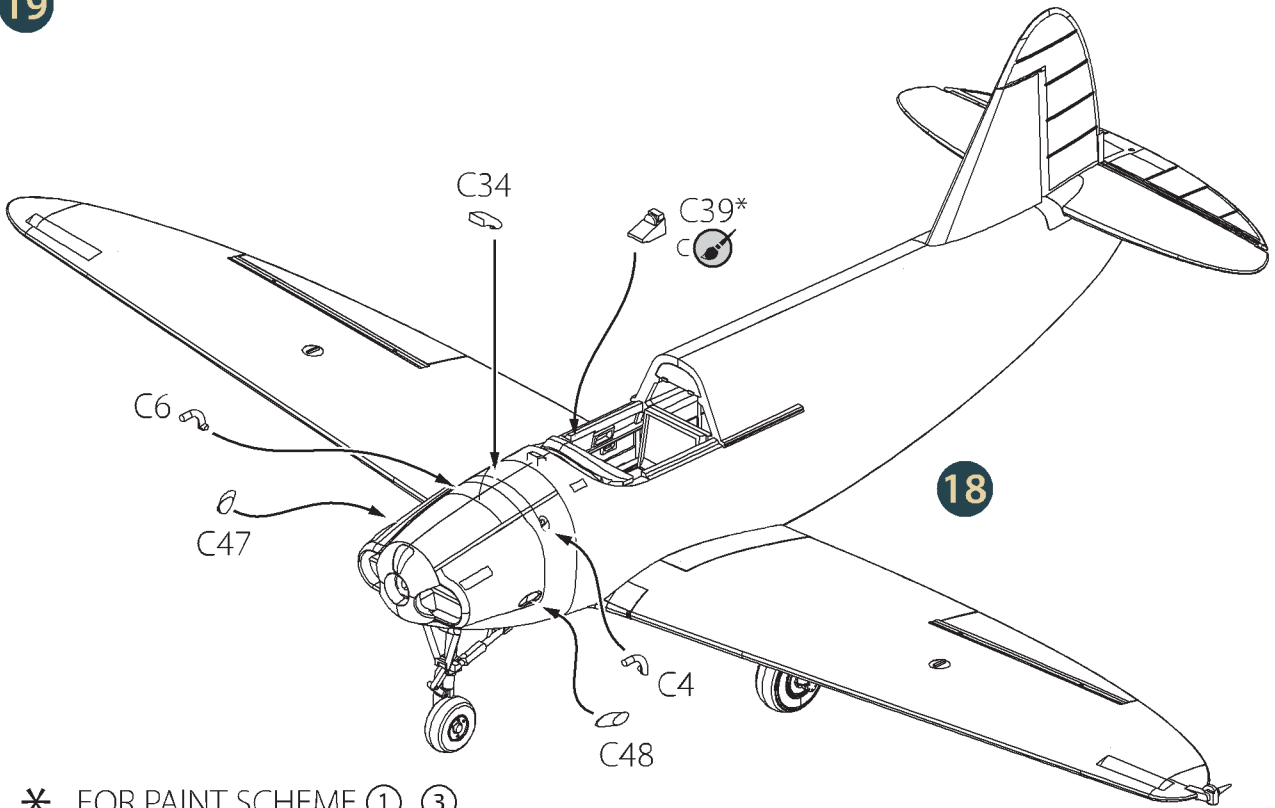
18

19

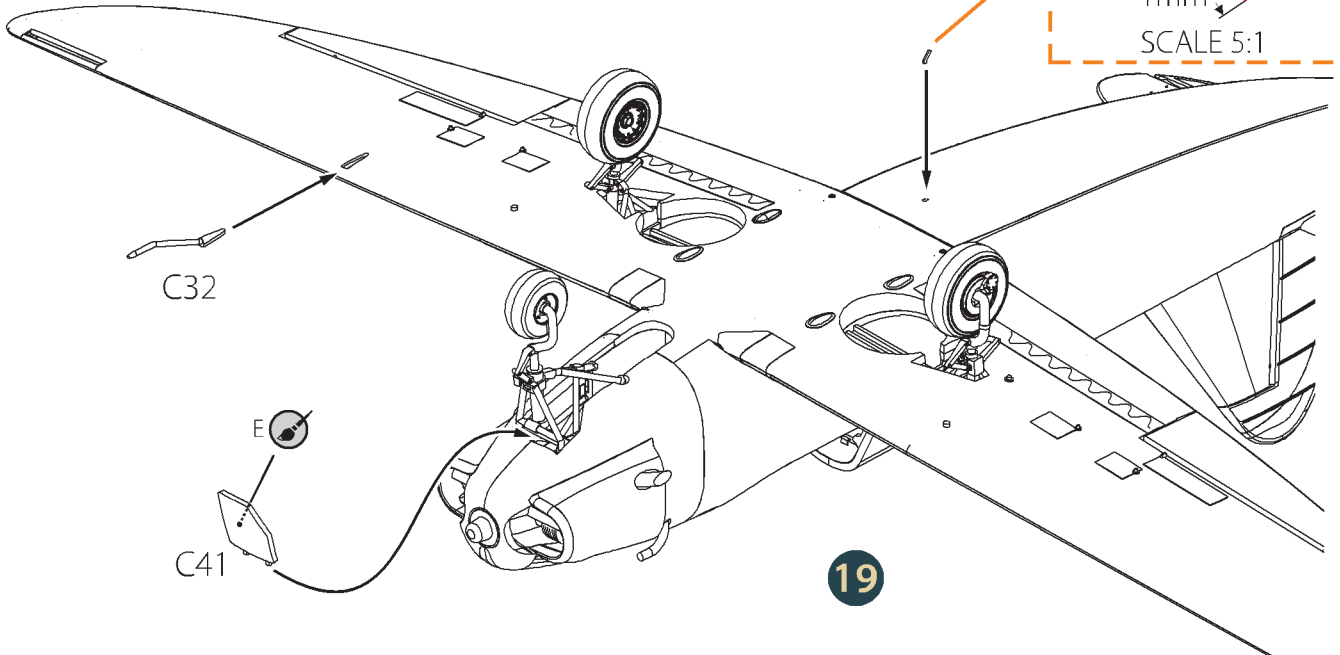
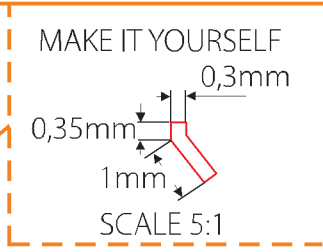
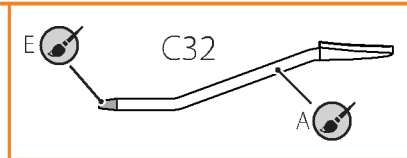

* FOR PAINT SCHEME ① ③

20



21

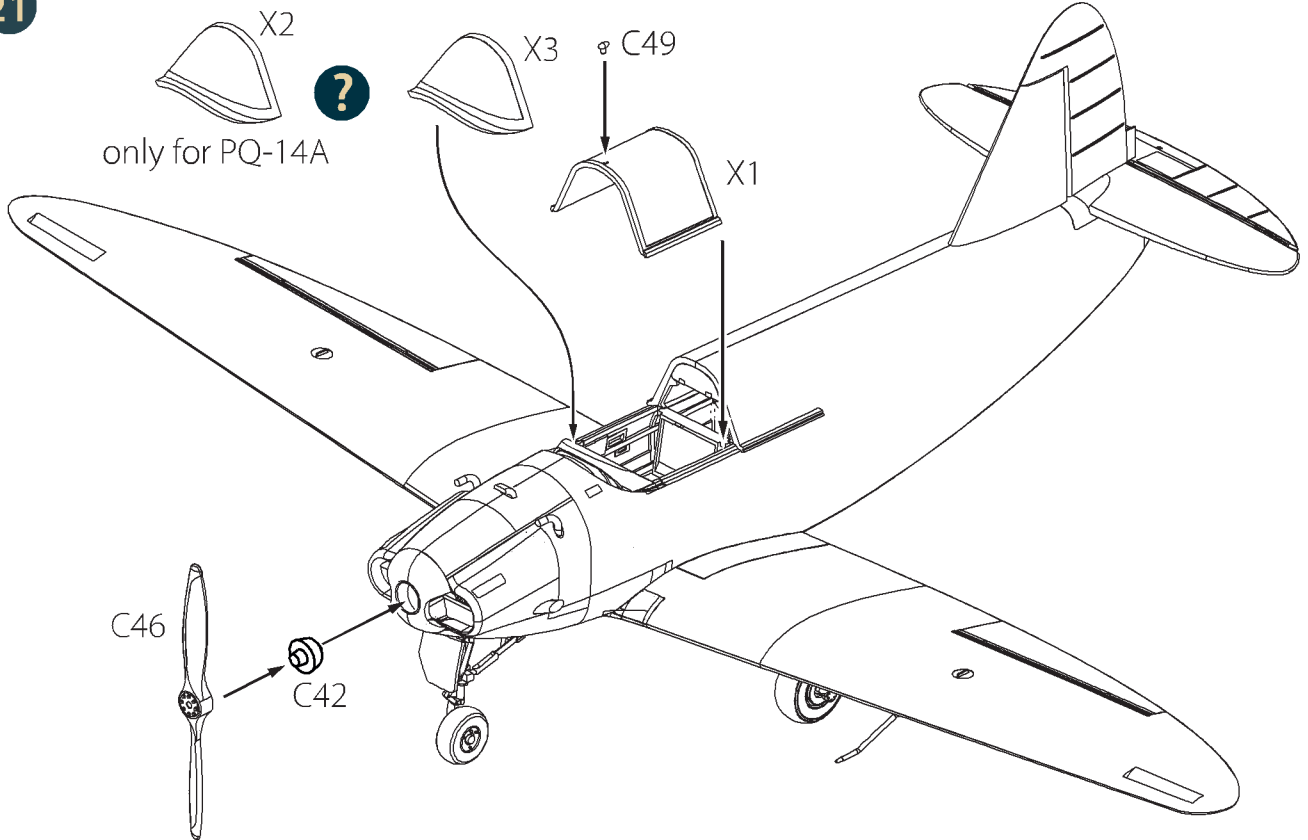

RADIO ANTENNA OPTIONS AND THEIR INSTALLATION

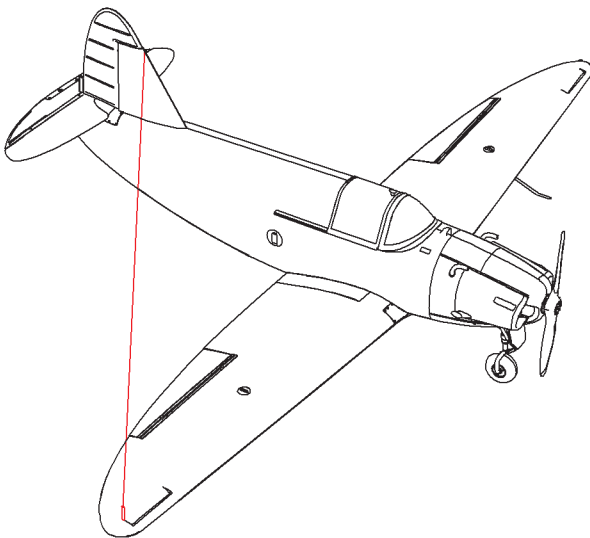

FOR PAINT SCHEME ① ③

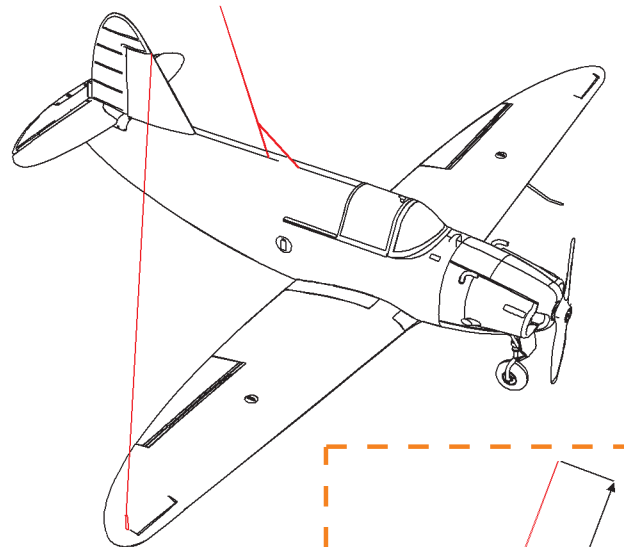

FOR PAINT SCHEME ②

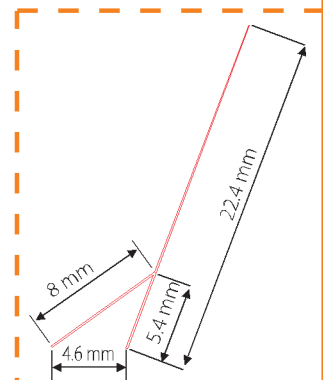

4

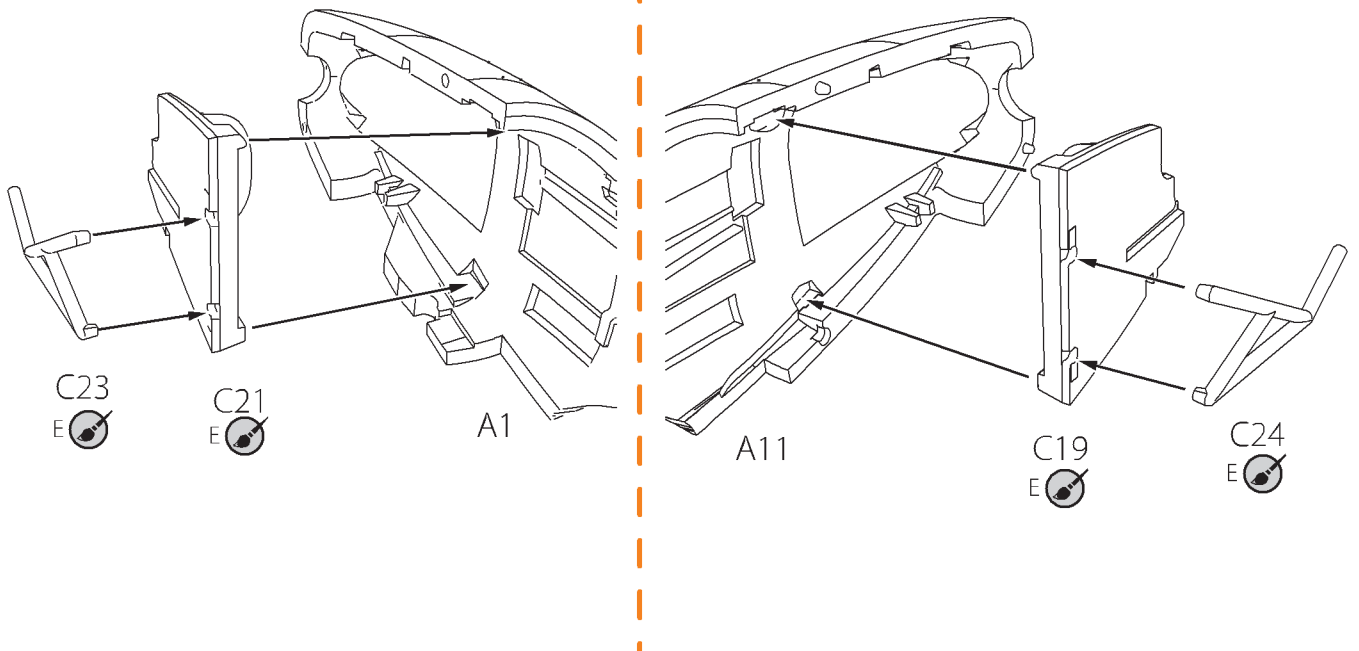

11

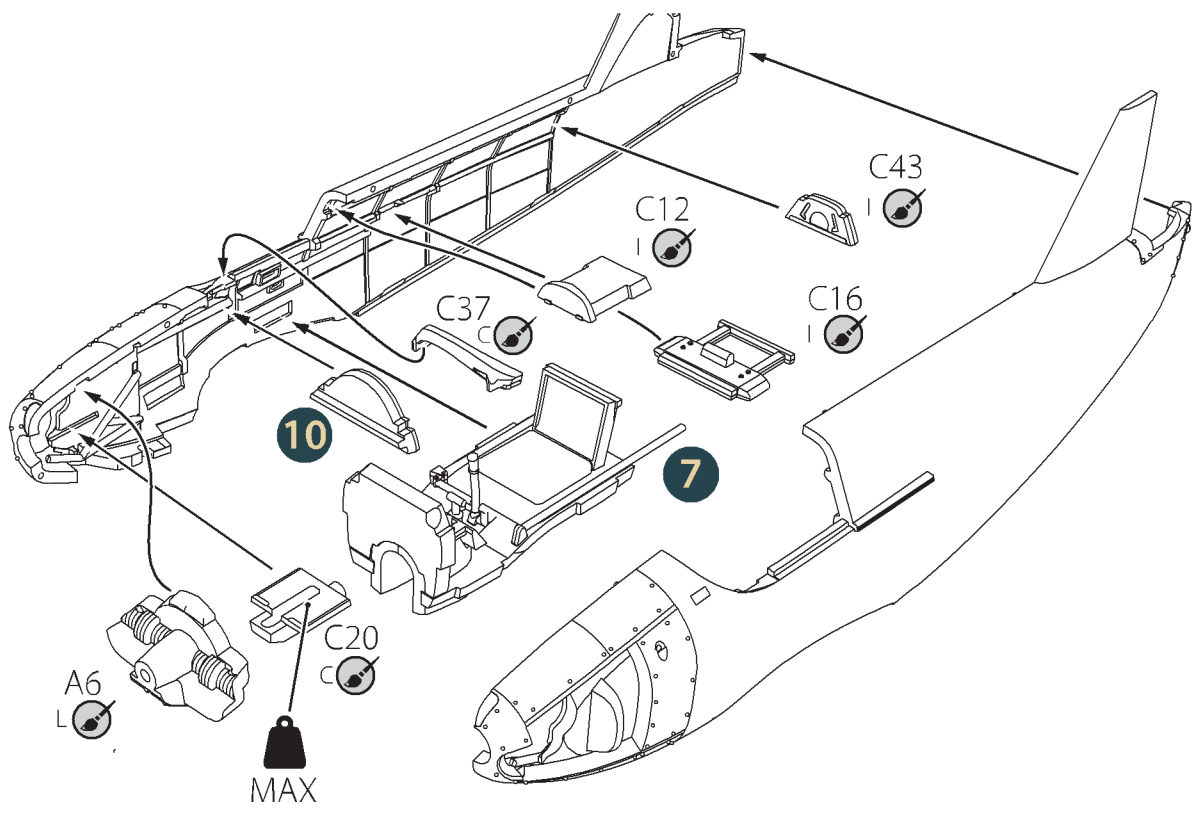



A
MR. COLOR 3
RED



B
MR. COLOR 1
WHITE



F
MR. COLOR MC214
DARK IRON



H
MR. COLOR 219
BRASS



I
MR. COLOR 113
WOOD



J
MR. COLOR 313
WOOD



N
MR. COLOR 329
YELLOW

① PQ-14A bu.no. 43-44217 USAF, 1940-x

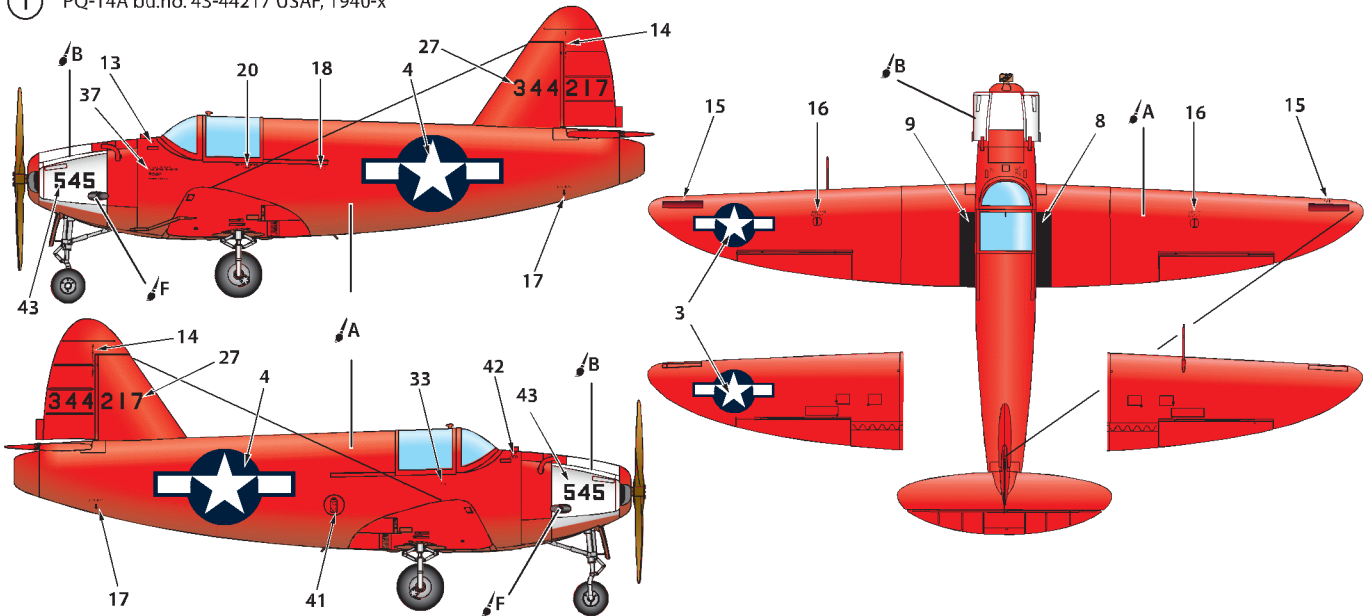

② PQ-14B bu.no. 44-68334 USAF, 1949, Wright Field airbase, used in TIPTOW wing tip experiments

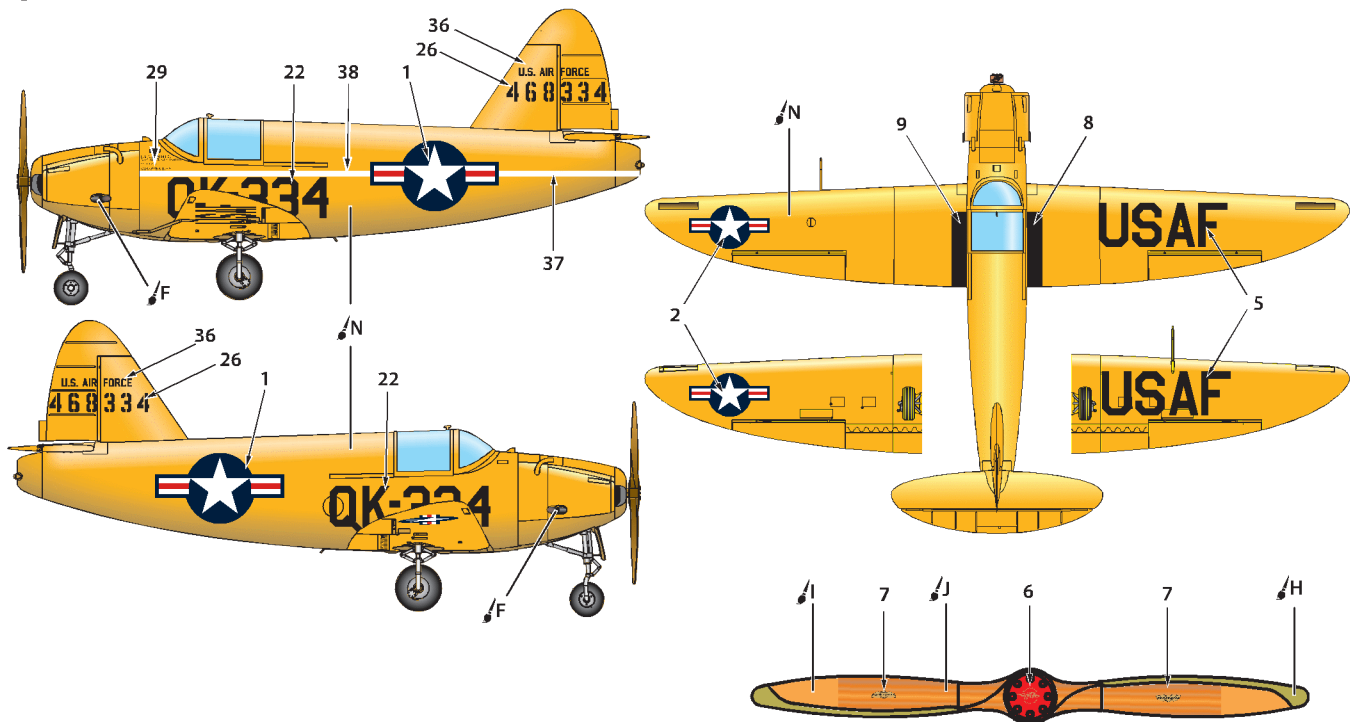

for all variants



F
MR. COLOR MC214
DARK IRON



M
MR. COLOR 327
RED



G
MR. COLOR 3
RED



H
MR. COLOR 219
BRASS



I
MR. COLOR 113
WOOD



J
MR. COLOR 313
WOOD



K
MR. COLOR 4
YELLOW

③ PQ-14B bu.no. 44-68454 USAF, 1940-x Air force flight test center, Muroc airbase

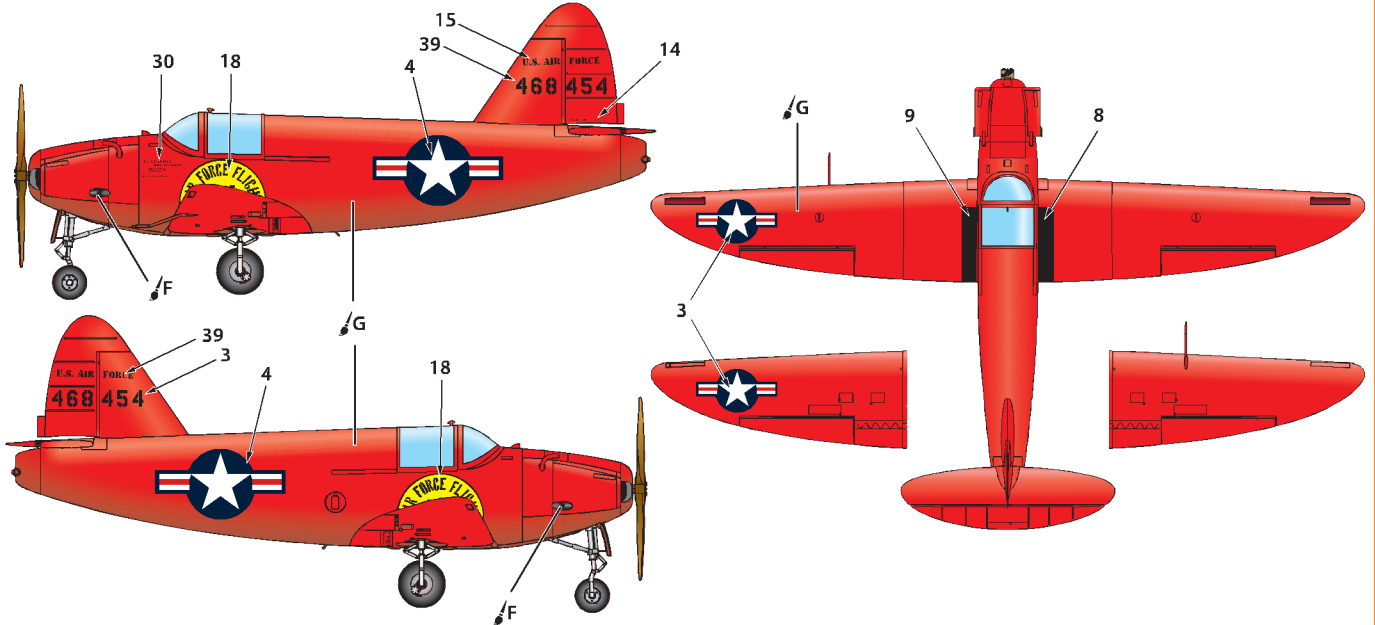

④ PQ-14B bu.no. 44-68462 USAF, 1940-x

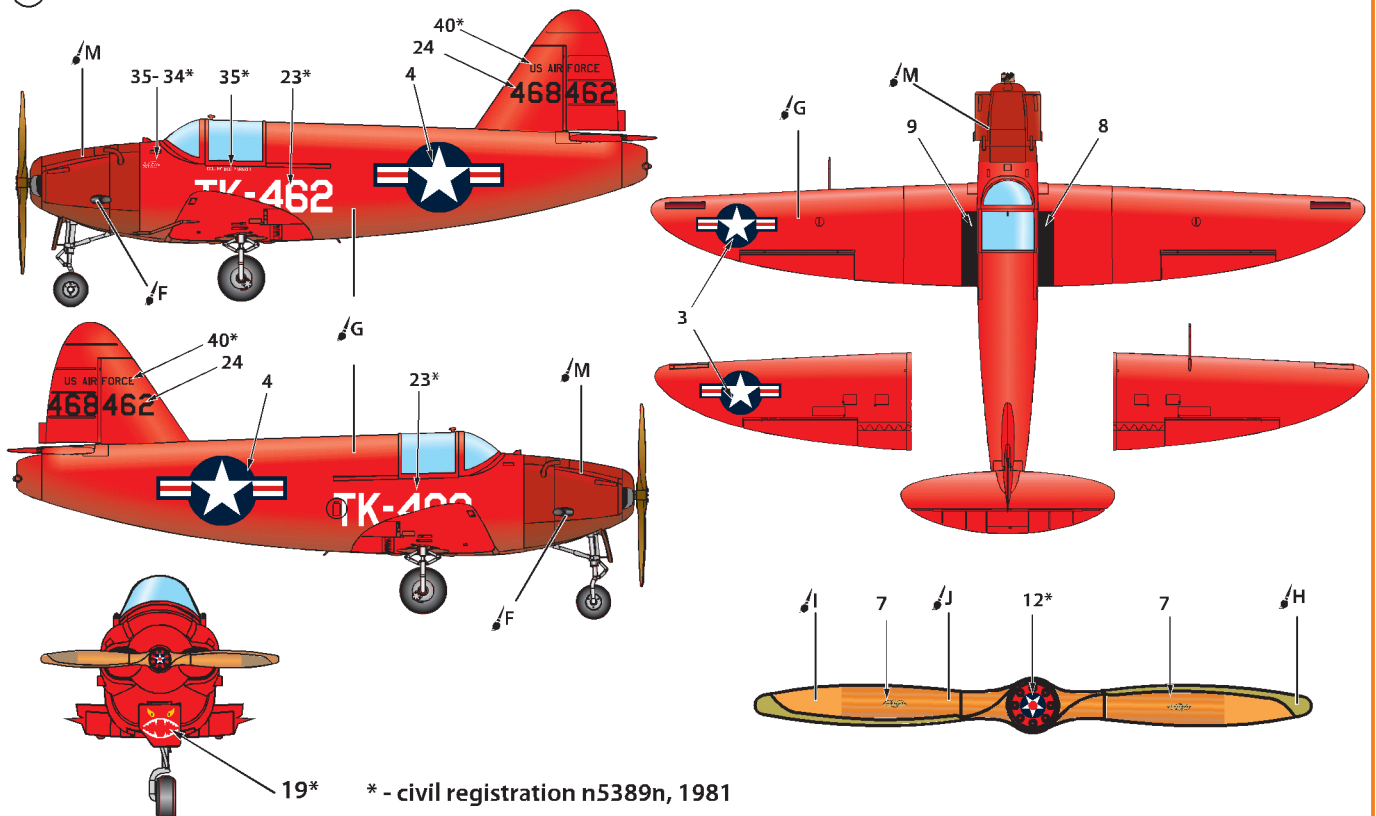

* - civil registration n5389n, 1981