

# Pz.Bef.Wg.III Ausf.K <sup>2IN1</sup> w/Schürzen

三号指挥塔坦克K型 ドイツ軍 III号指揮戦車K型

Border

徐模志  
XU MO ZHI 2009

1/35  
SCALE  
BT-048

- ◆ PE PARTS INCLUDED.
- ◆ 4 SCHEMES OF MARKINGS.
- ◆ METAL GUN BARREL INCLUDED.
- ◆ INCLUDES METAL SCHÜRZEN FOR TURRET & HULL.



## History | 历史介绍

## Pz.Bef.Wg.III Ausf.K w/Schürzen

The Panzer III K command tank should actually be referred to as the Type K Command Tank (Panzerbefehlswagen 266, 267 & 268 Ausf.K, this article will continue to follow the commonly used designation for the sake of ease of writing), which was a command tank developed by Daimler-Benz specifically to meet the military's requirements. This command tank installed and the newer Panzer III with the same 5cm KwK 39 L/60 main gun, turret can be rotated, but also can carry more command radio devices. Produced by Mercedes-Benz's Factory 40 from December 1942 until February 1943, with a total of 50 units produced, the Panzer III K command tank was the only specially designed command tank for the German Army. Because of its unobtrusive appearance and the fact that it had the same firepower as the battle tanks, the Panzer III K was more survivable on the battlefield than the previous Panzer III command tanks that had been converted without a gun. Later in WWII, command tanks based on the Panther and IV designs gradually replaced the III K. Compared to the III K, they had more interior space and were better adapted to the battlefield environment, but as a specialized command tank, the Panzer III K remained in service until the end of the war. Starting in May 1943, some of the Panzer IIIs in frontline service were fitted with Schürzen and additional turret armor. The Schürzen were very peculiar, with the front of the turret resembling that of the Panzer III and the rear that of the Panzer IV. The hull Schürzen was of the perforated type, with triangular folds at the front. Based on historical experience. The number of K-types fitted with additional armor should be quite large. The 1st Armored Division of the Wehrmacht had one of its Panzer III-Ks captured by the Soviets on the Hungarian battlefield in 1945 - the division's report shows that it lost one of its "Panzer III Command Tanks" in the fighting between January 15 and March 15, 1945, and this must be the same one. It is enough to show the survivability of this type of tank on the battlefield.

三号K型指挥坦克其实应当被称为K型指挥坦克 (Panzerbefehlswagen 266, 267&268 Ausf.K, 本文为行文方便, 继续沿用常用称呼), 它是戴姆勒-奔驰公司 (Daimler-Benz) 按军方要求专门开发的一种指挥坦克。这种指挥坦克安装了和较新型的三号坦克相同的5cm KwK 39 L/60主炮, 炮塔可以旋转, 同时还可以搭载较多的指挥用无线电装置。三号K型指挥坦克由奔驰的40号工厂生产, 从1942年12月一直生产到1943年2月, 一共生产了50台, 是德军唯一一种专门设计的指挥坦克。因为外形不突出, 且火力和战斗坦克相同, 三号K的战场生存能力要强于之前那些改造而来, 没有火炮的三号指挥坦克。二战后期, 基于黑豹和四号设计的指挥坦克逐渐替代了三号K的位置, 相较于三号K, 它们的内部空间更大, 也更能适应战场环境, 但作为一种专业的指挥坦克, 三号K还是一直服役到战争结束为止。1943年5月开始, 一部分在前线服役的三号坦克加装了侧裙板和炮塔附加装甲, 这种侧裙板非常奇特, 炮塔部分前端类似PANZER III 而后部则是PANZER IV 的。车体裙甲采用挂孔式, 前端类似PANZER IV H型的三角形折角。根据历史经验来看, 装上附加装甲的三号K型的数量应该不少。国防军第1装甲师的一辆三号K型在1945年的匈牙利战场上被苏军缴获了——该师的报告显示1945年1月15日—3月15日间战斗中损失“三号指挥坦克”一辆, 应该就是这个家伙。足以可见该型坦克在战场的生存能力。



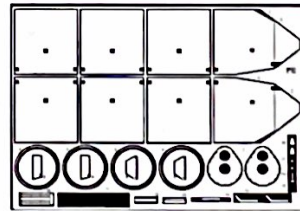
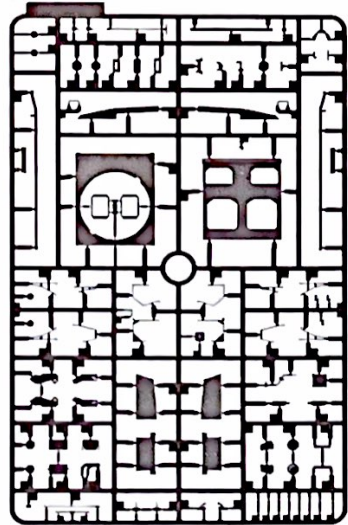
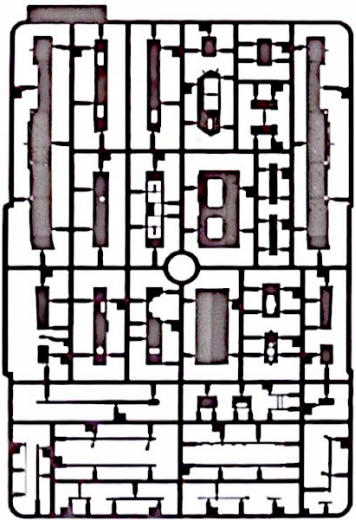
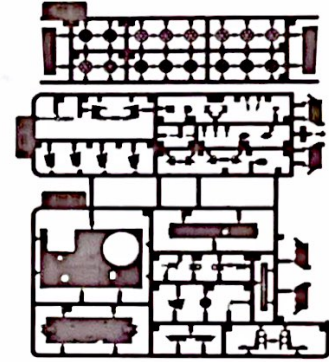
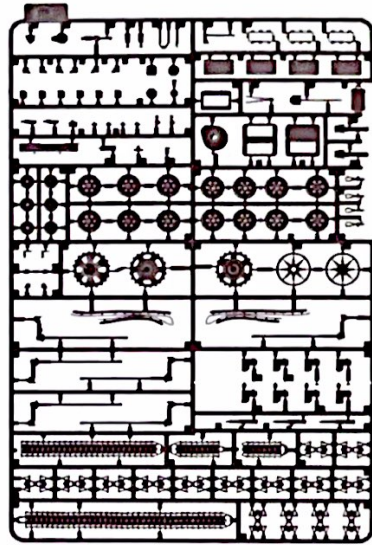
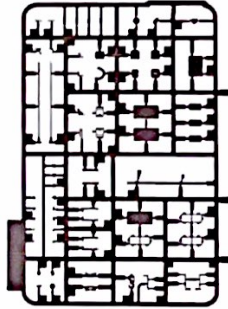
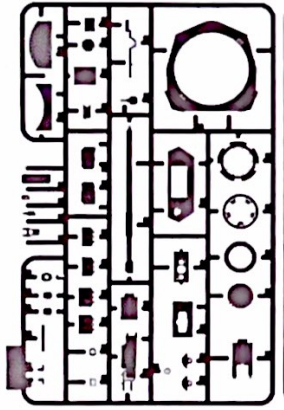
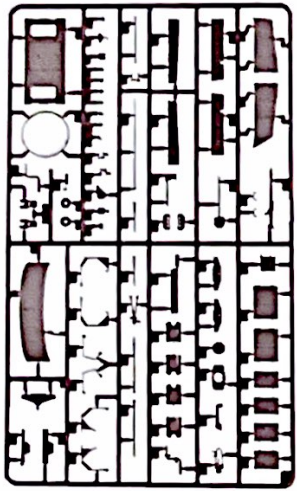

01

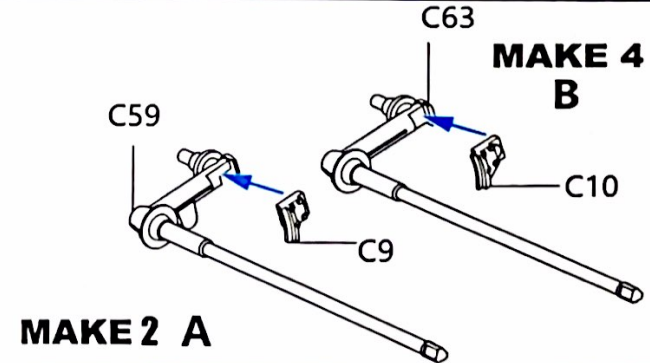
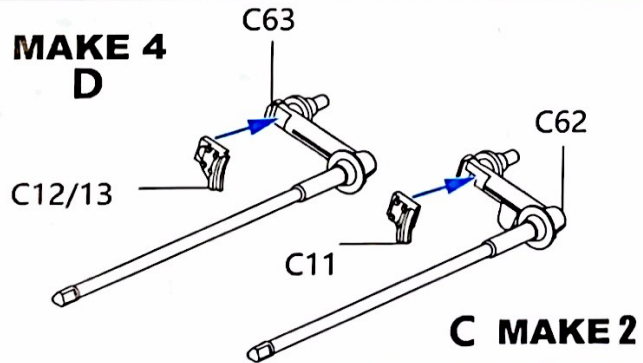
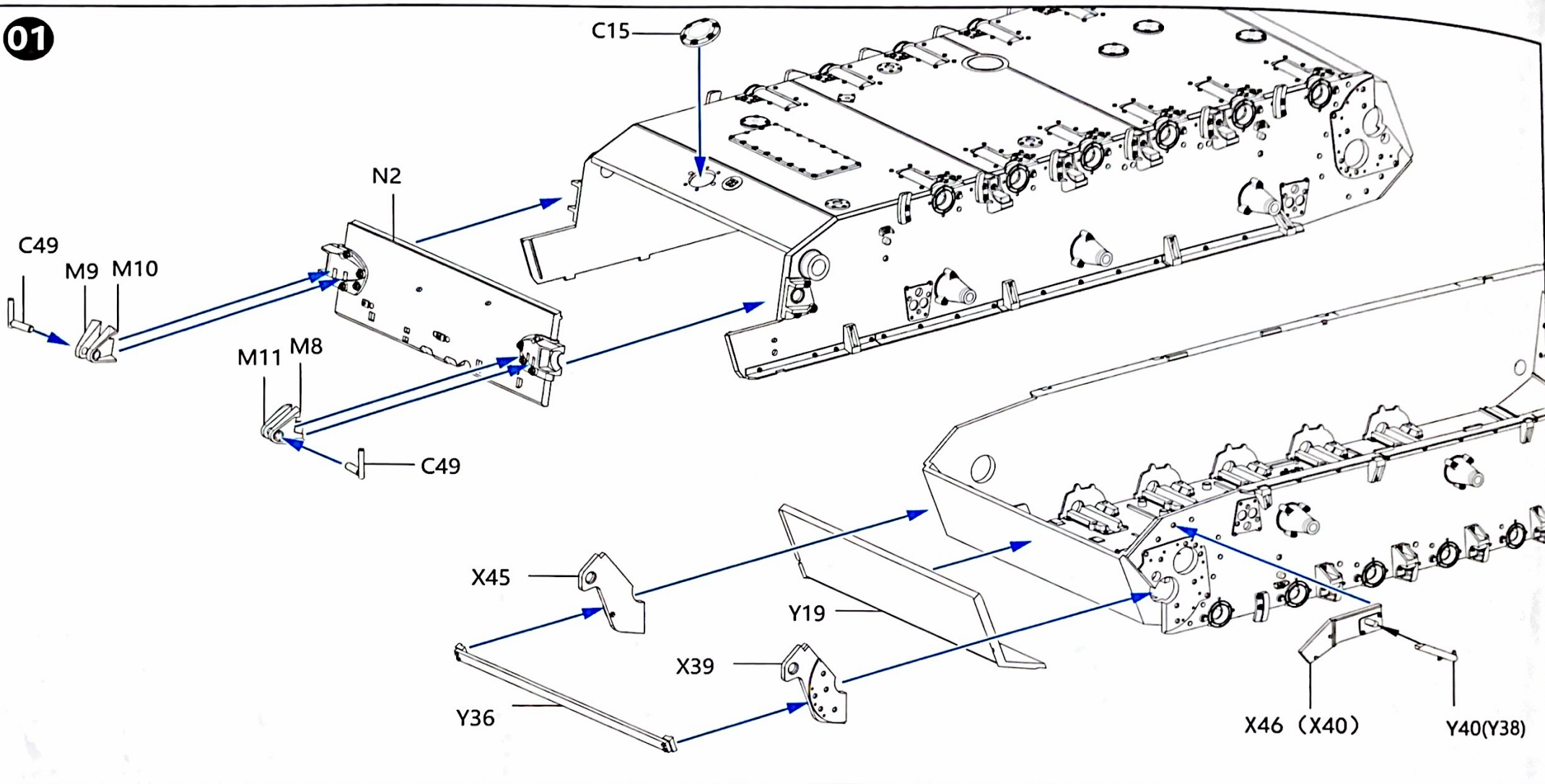

03

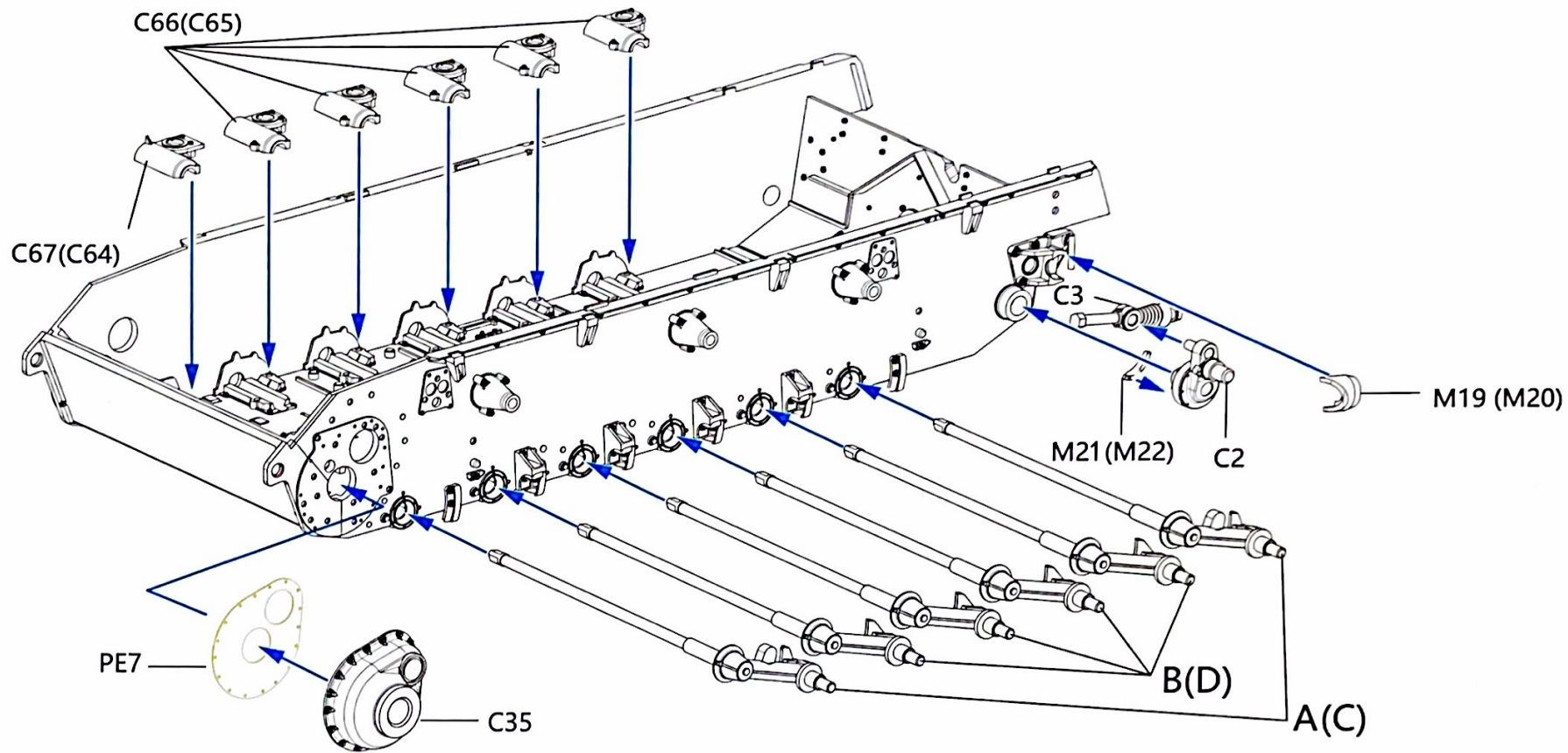

04

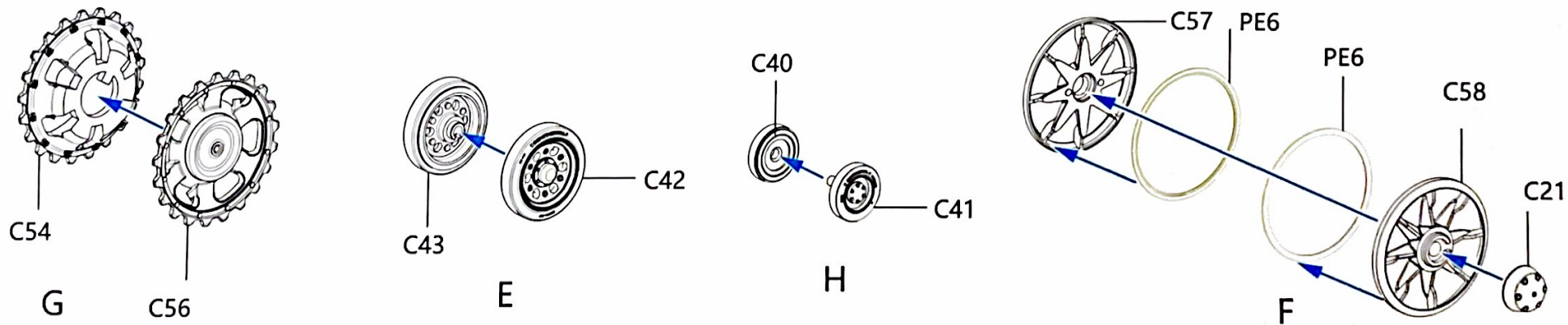

Make 2

Make 12

Make 6

Make 2

05

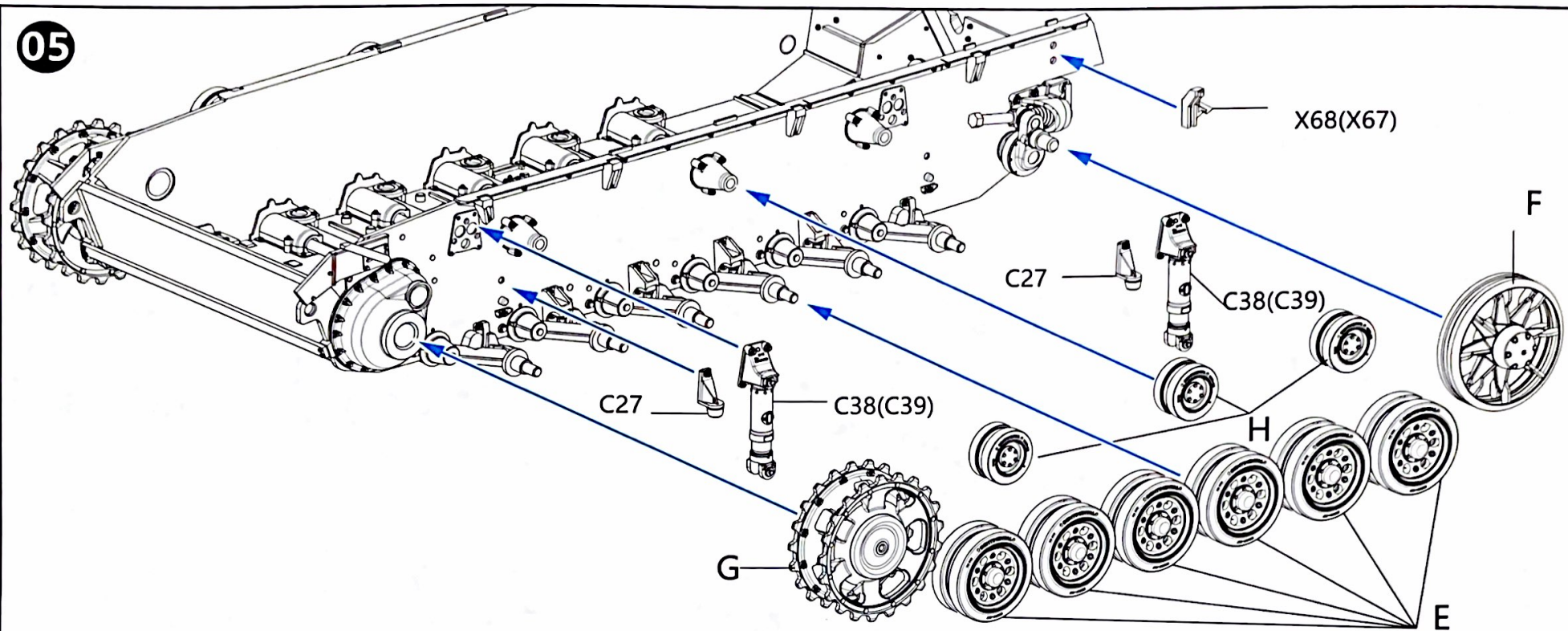

06

打孔  
Drill Hole

打孔  
Drill Hole

打孔  
Drill Hole

打孔  
Drill Hole

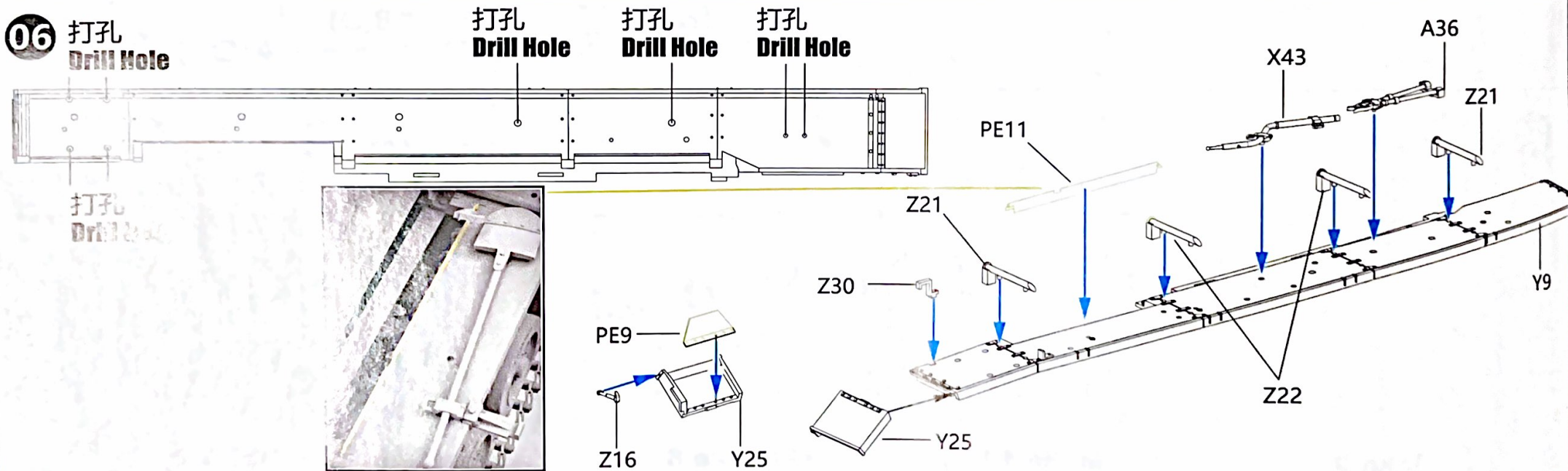

07

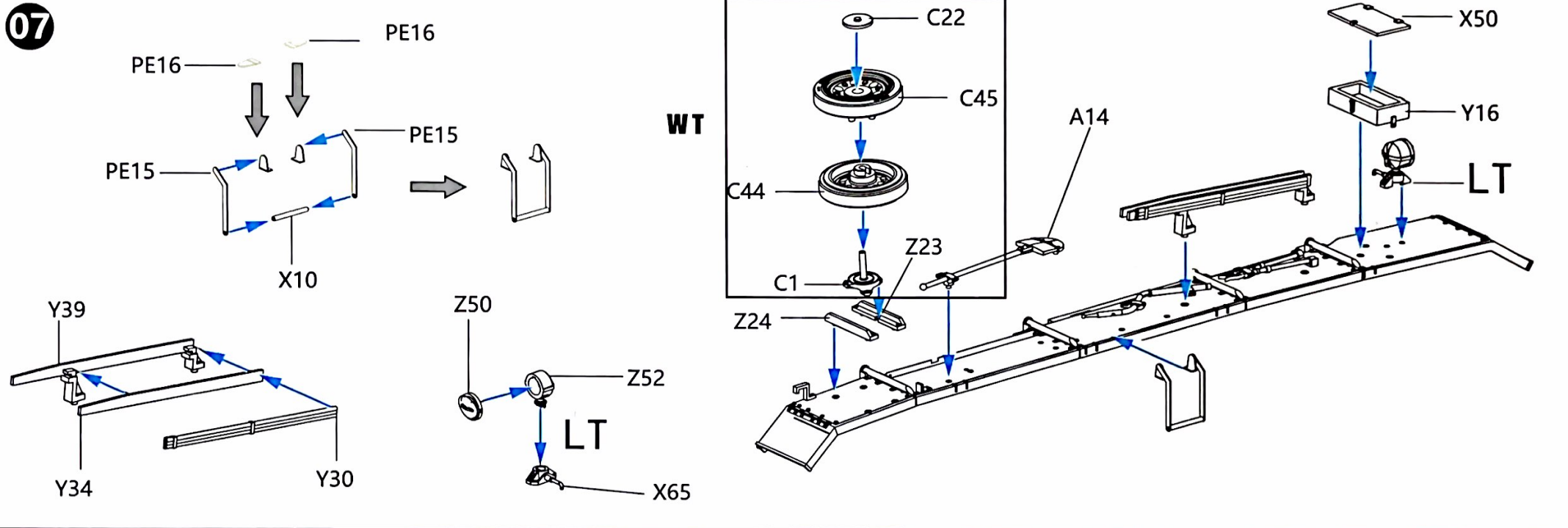

08

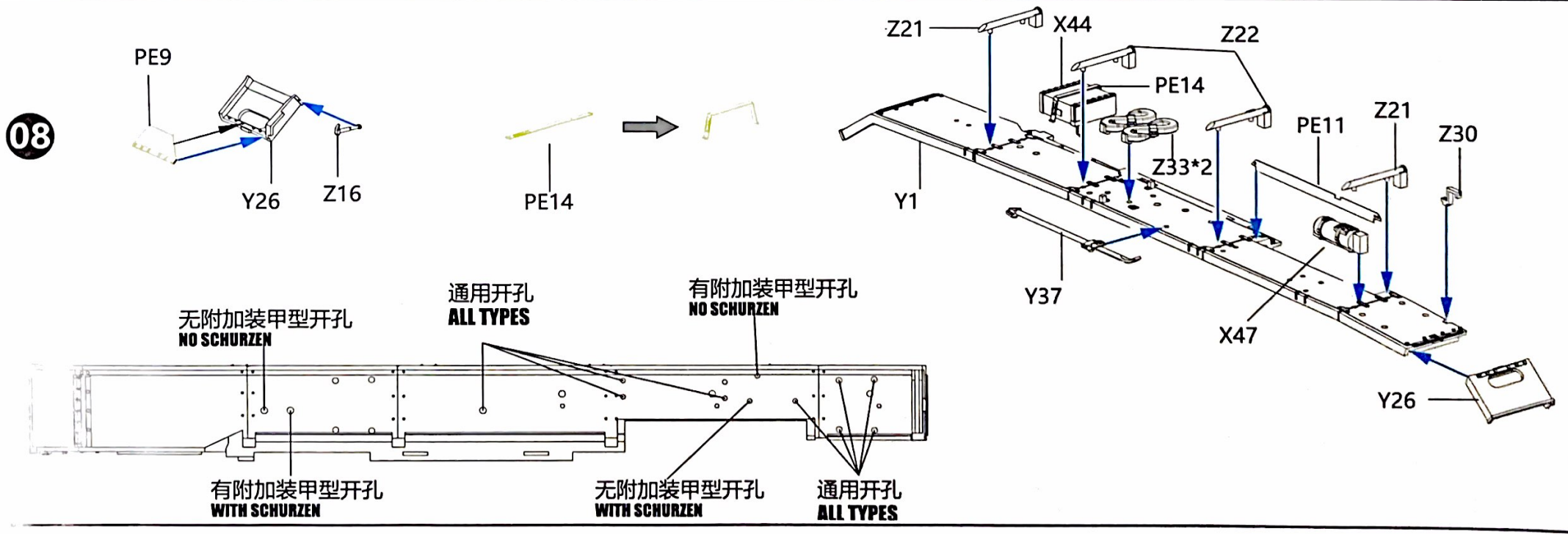

09



PE13

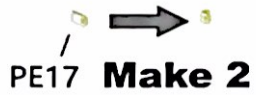

PE17 **Make 2**

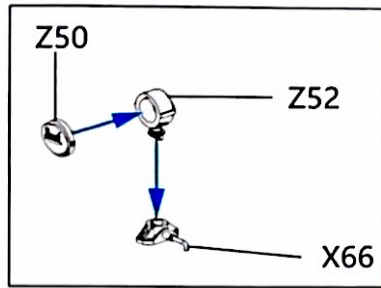

Z50

Z52

X66

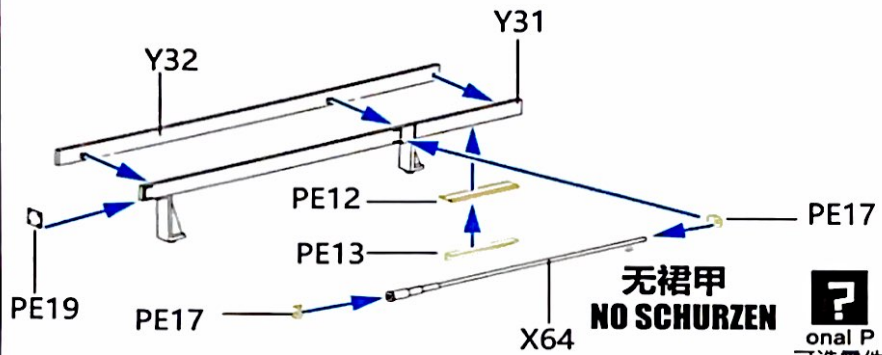

无裙甲  
NO SCHURZEN



onal P  
可选零件

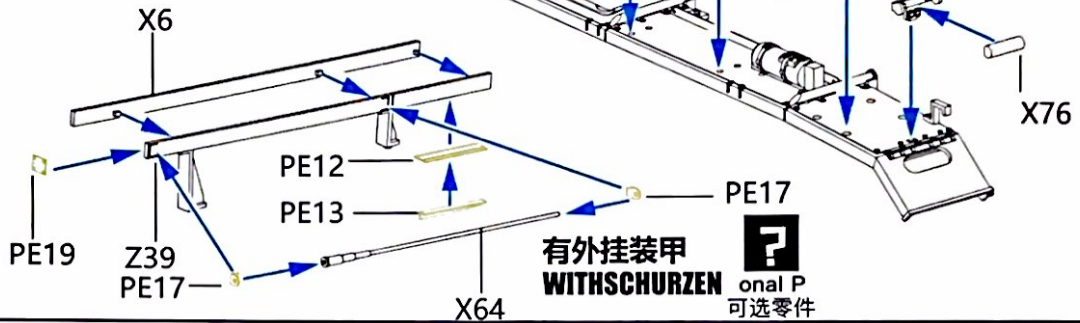

有外挂装甲  
WITHSCHURZEN



onal P  
可选零件

10

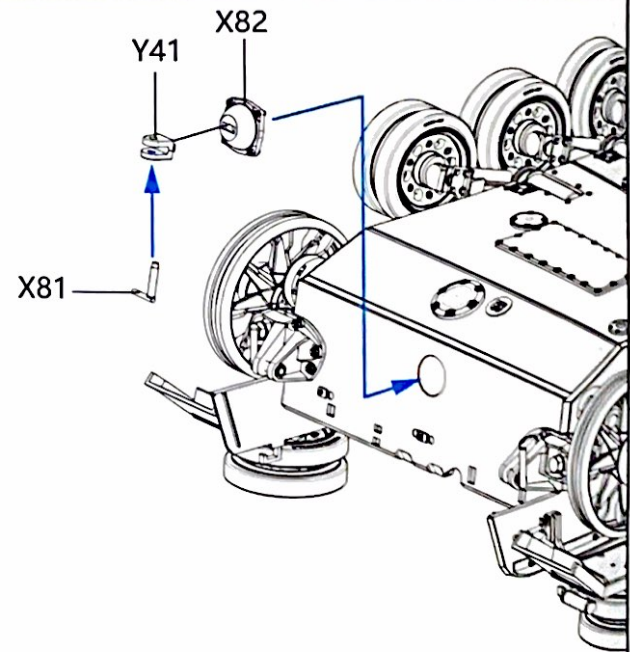
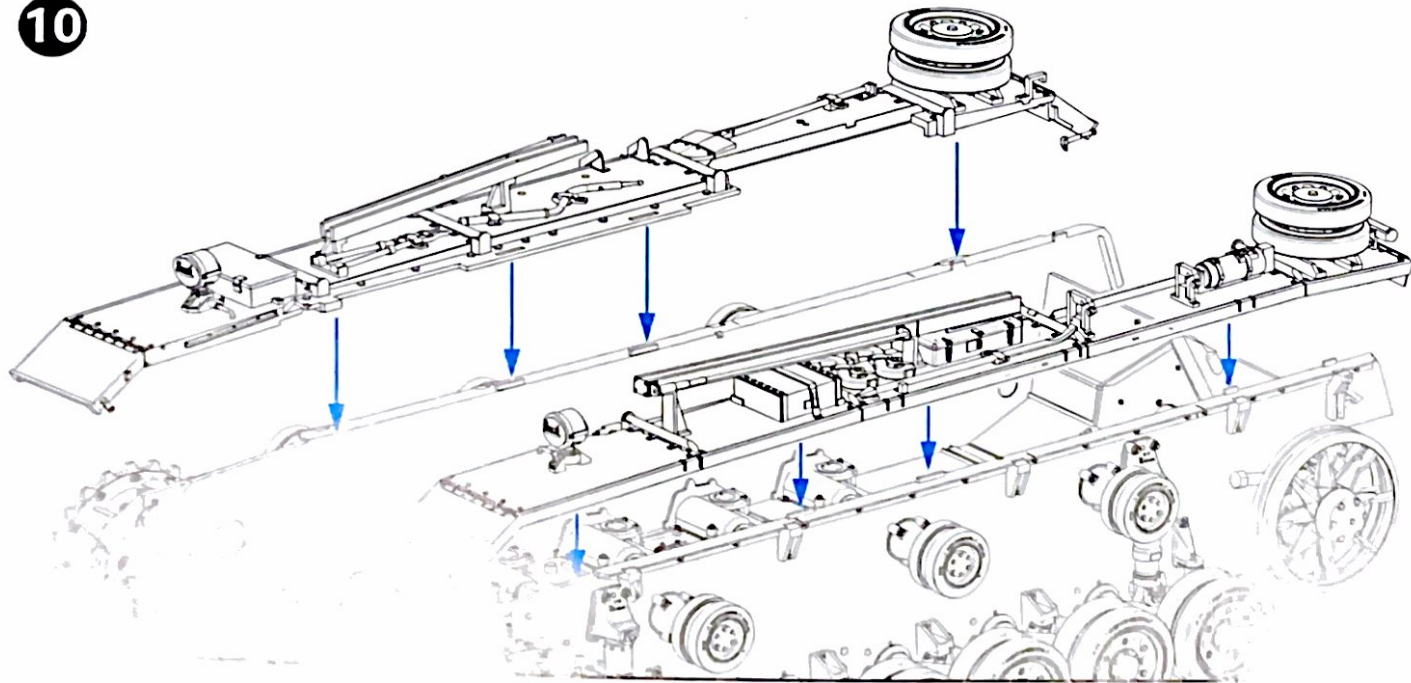

Y41

X82

X81

11

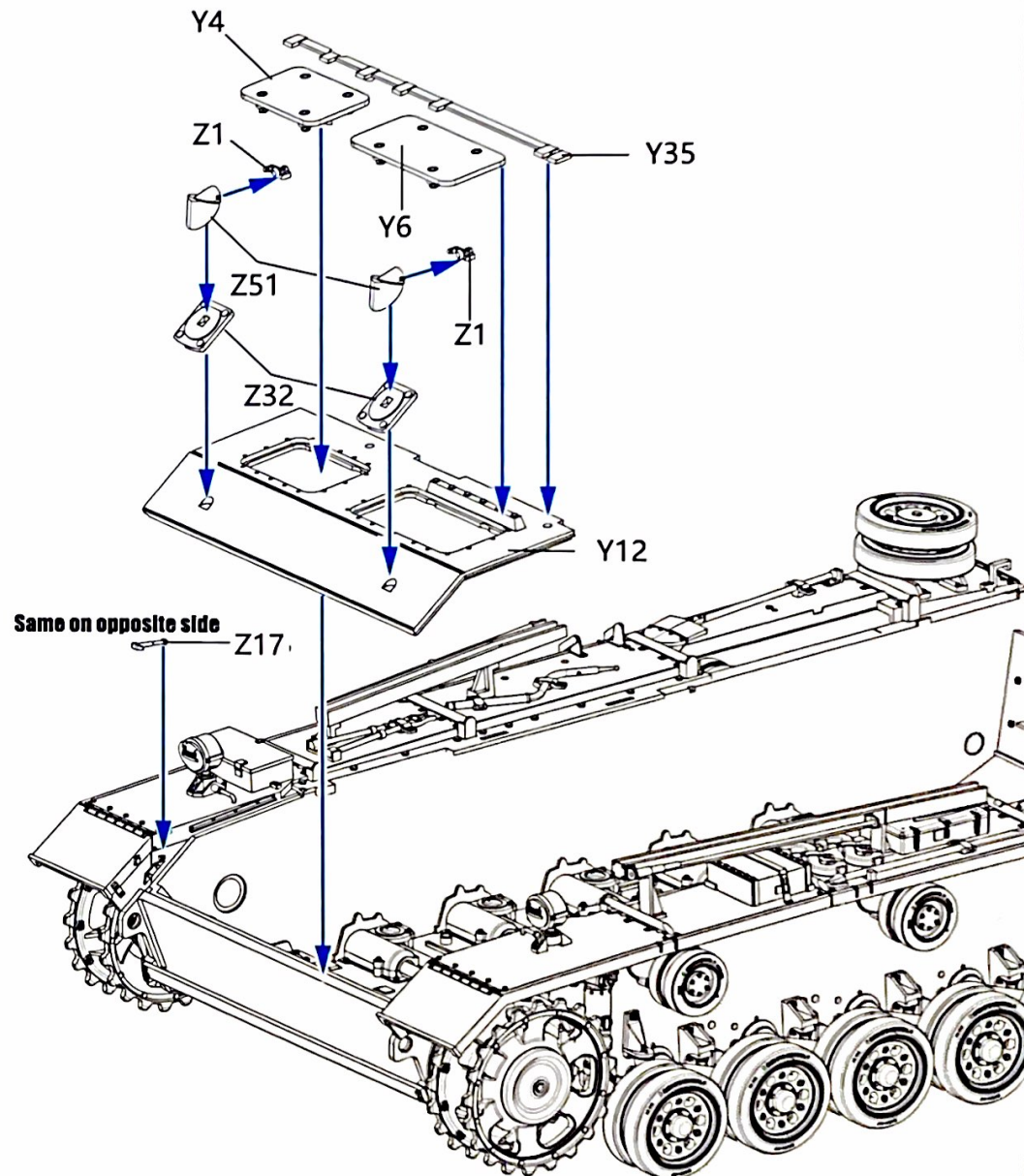
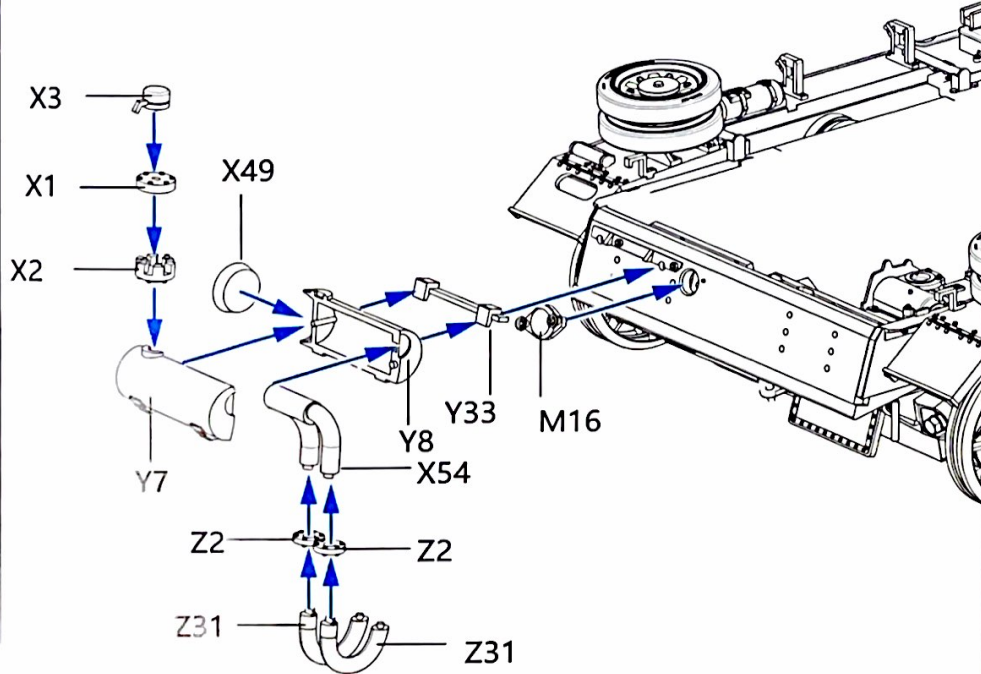
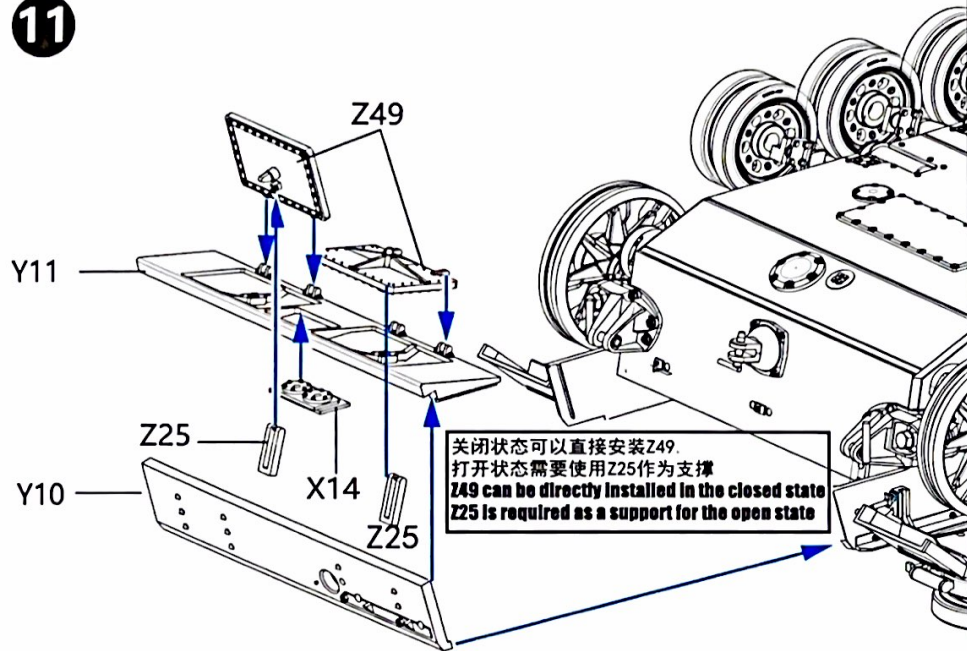

12

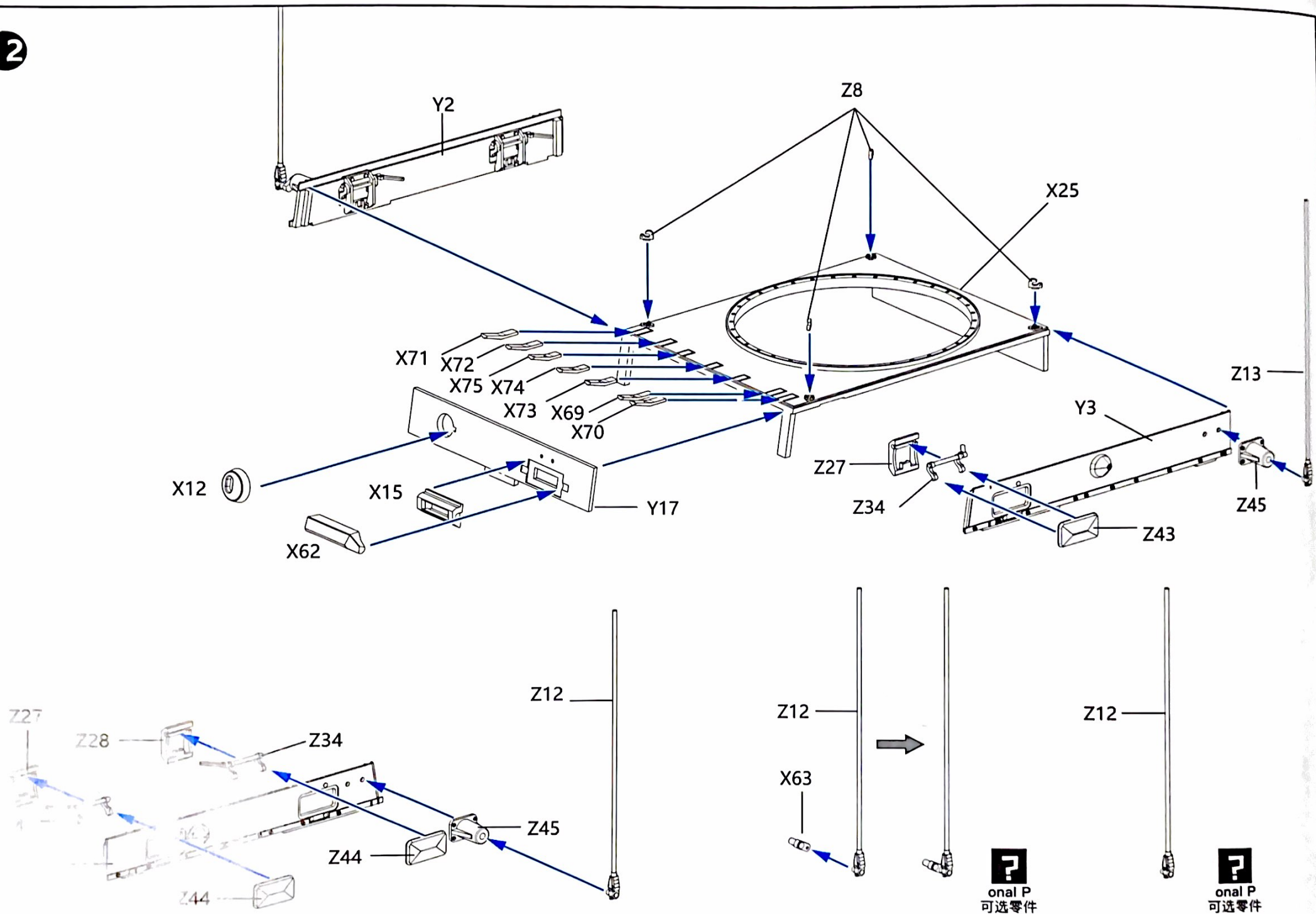

13

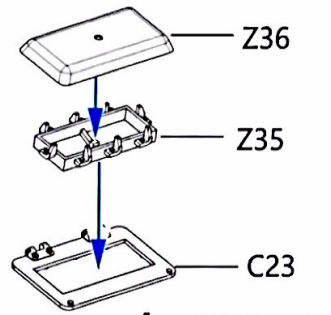
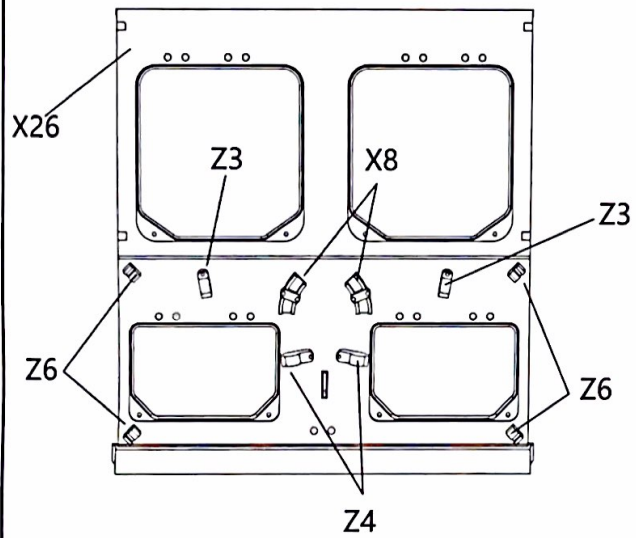

**J Make 2**

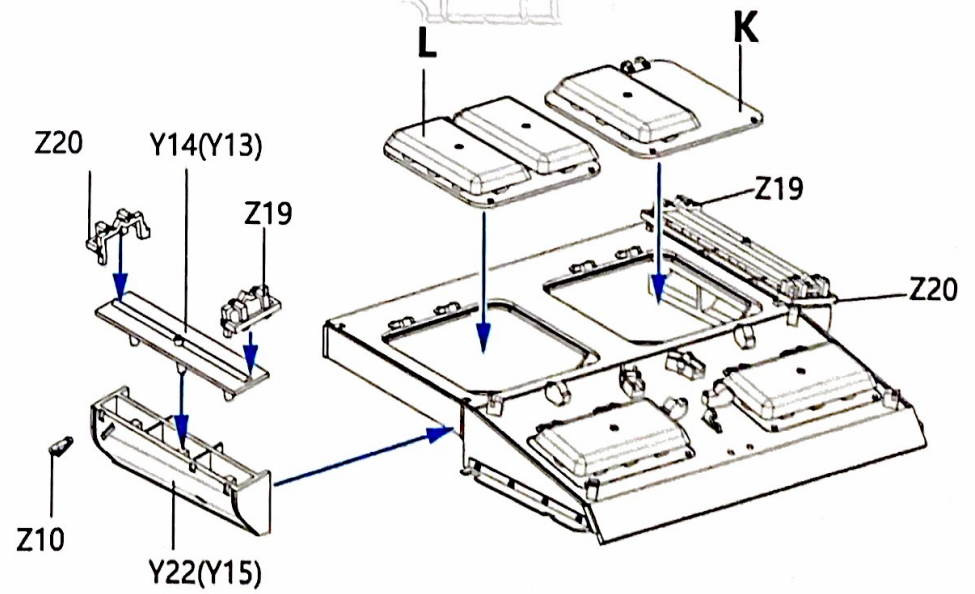
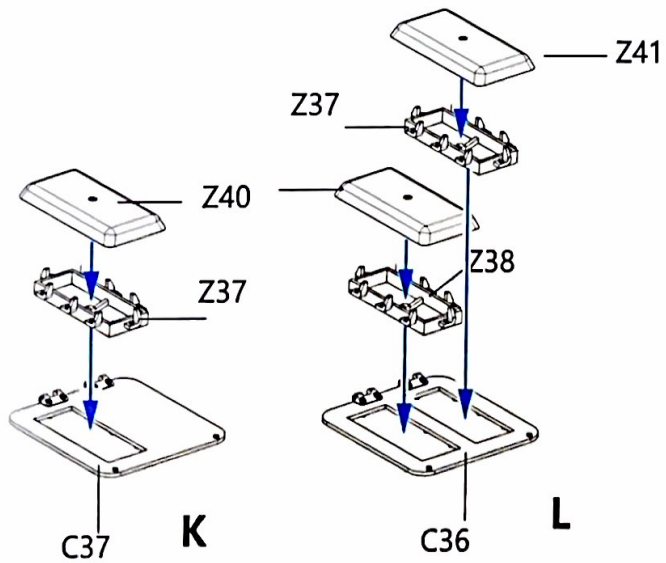
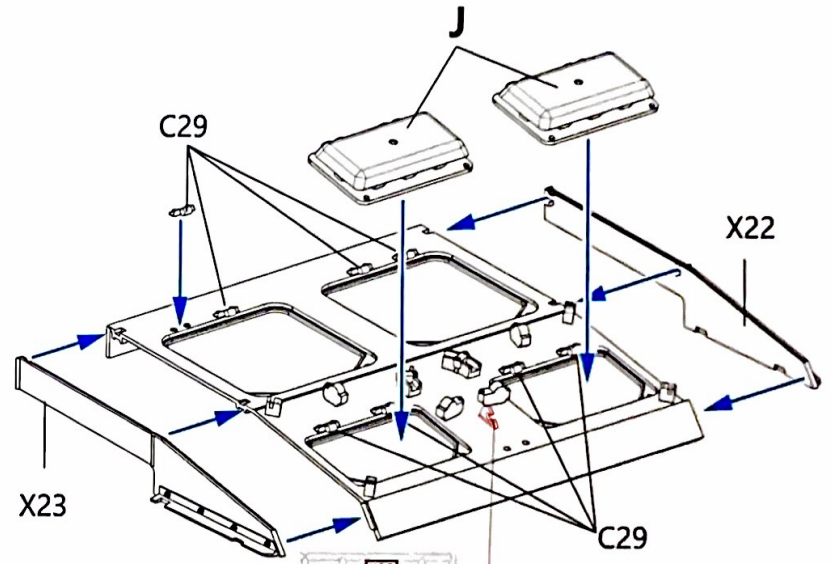

14

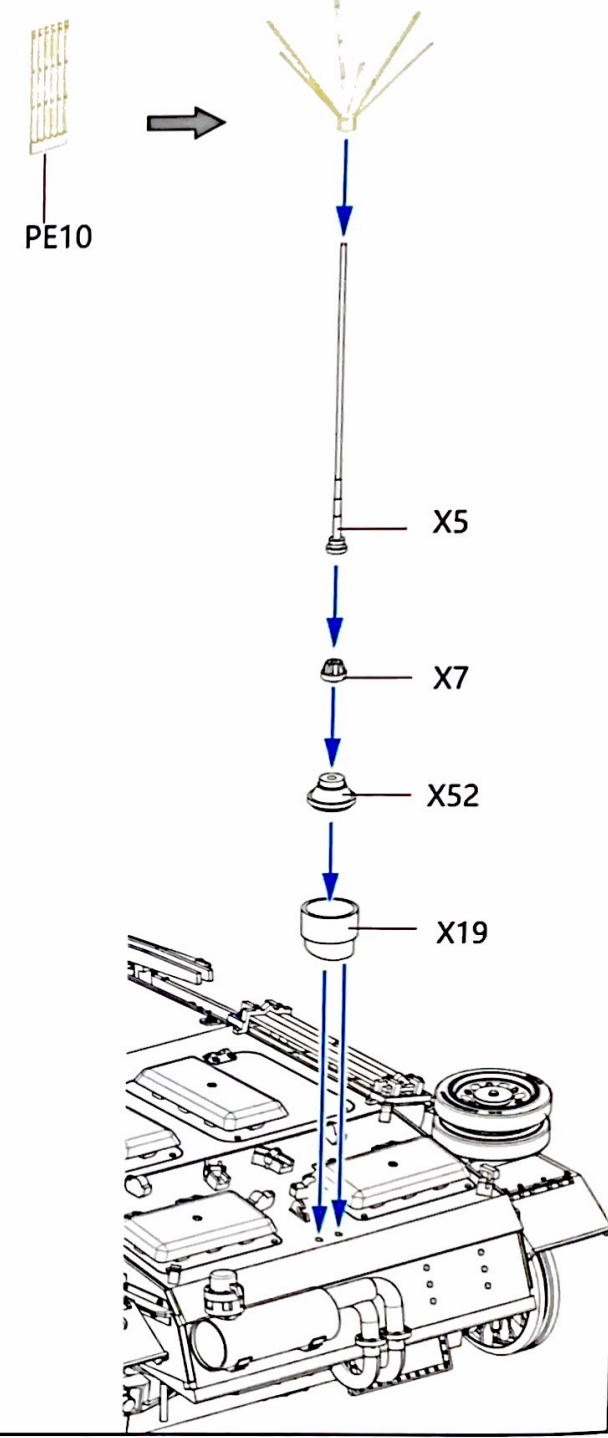
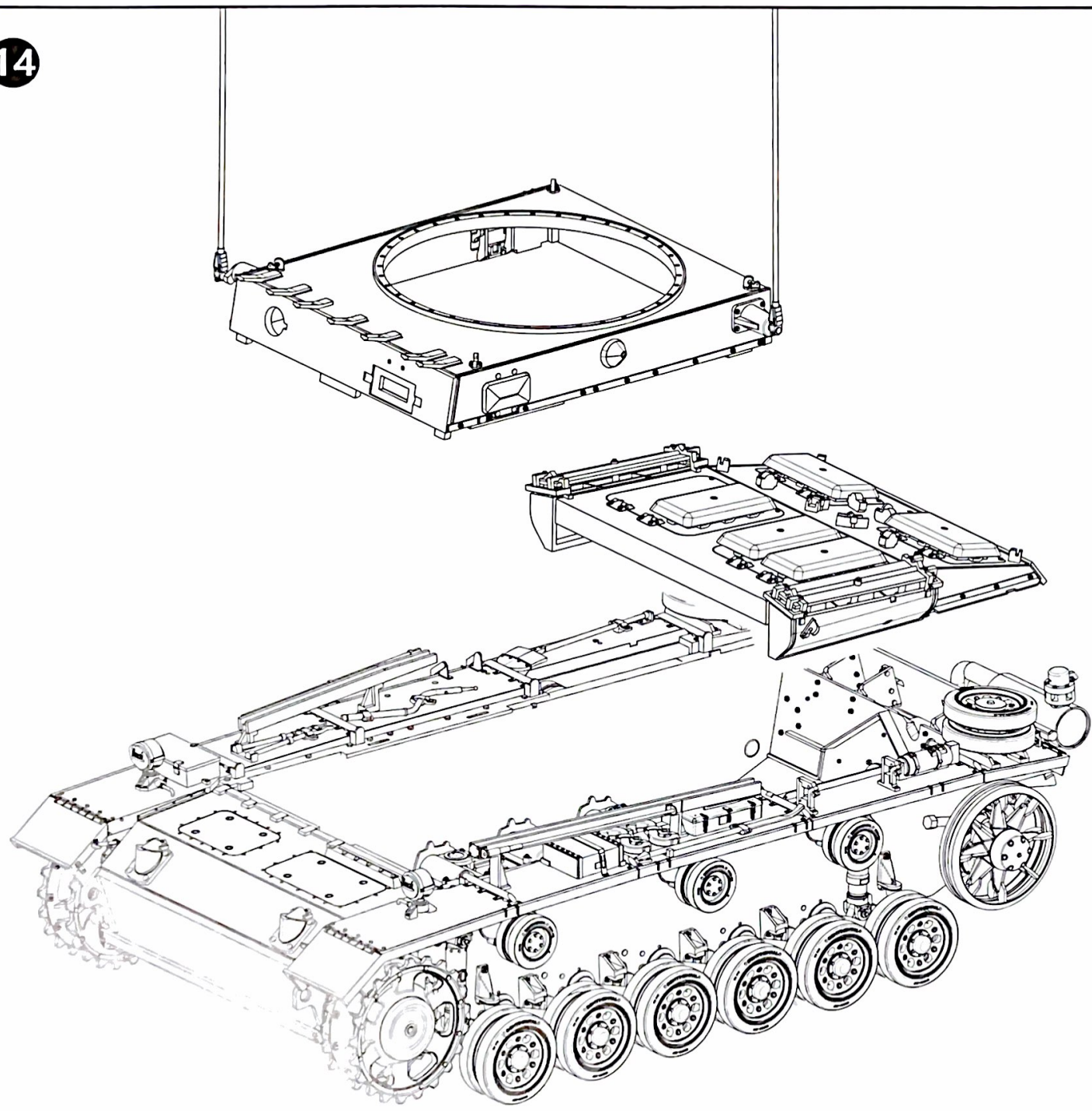

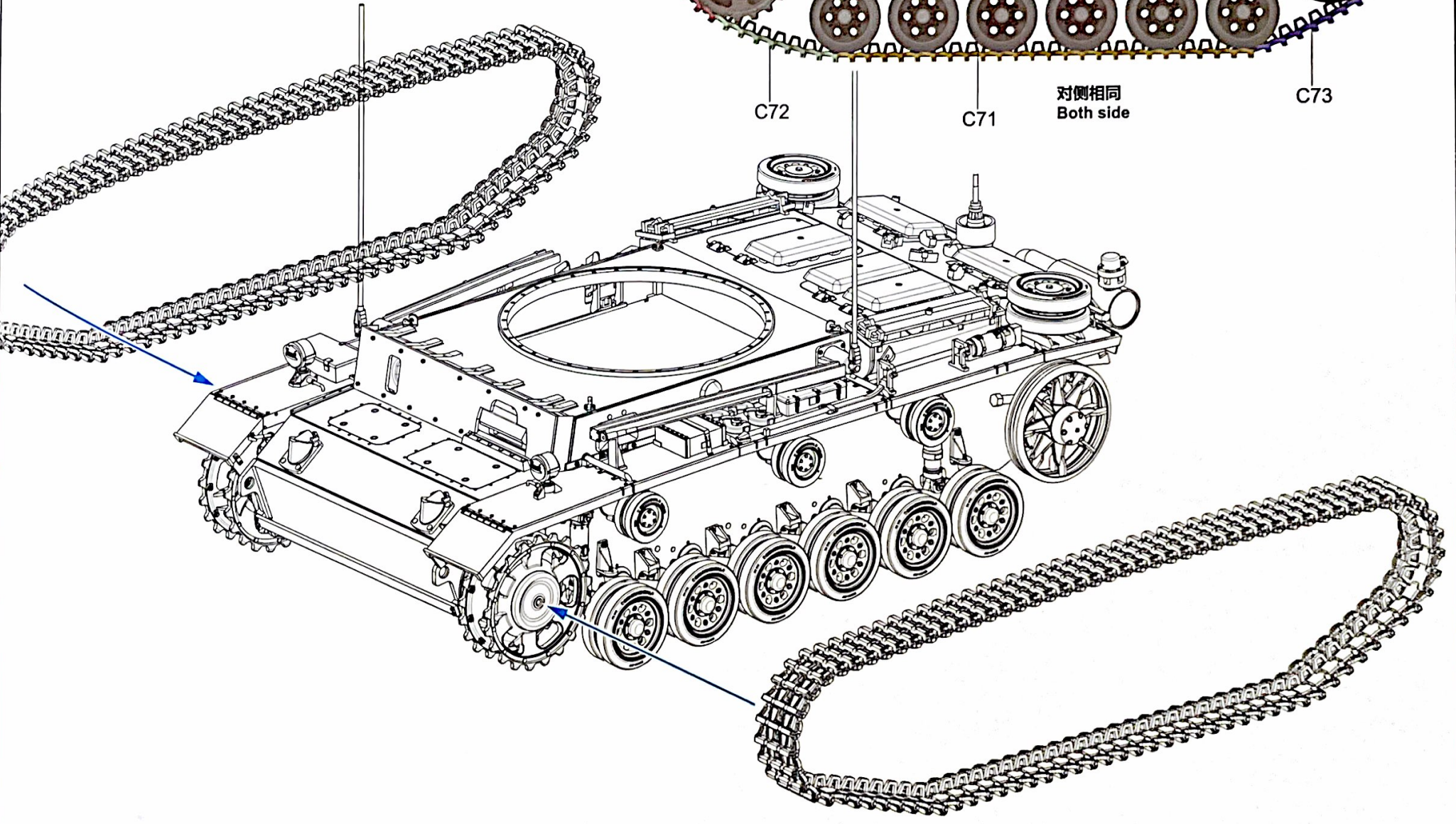
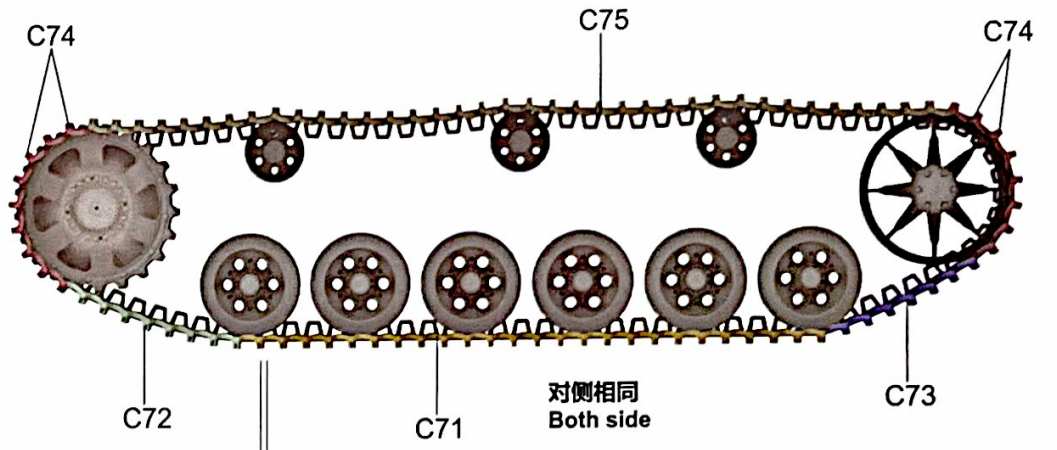

15

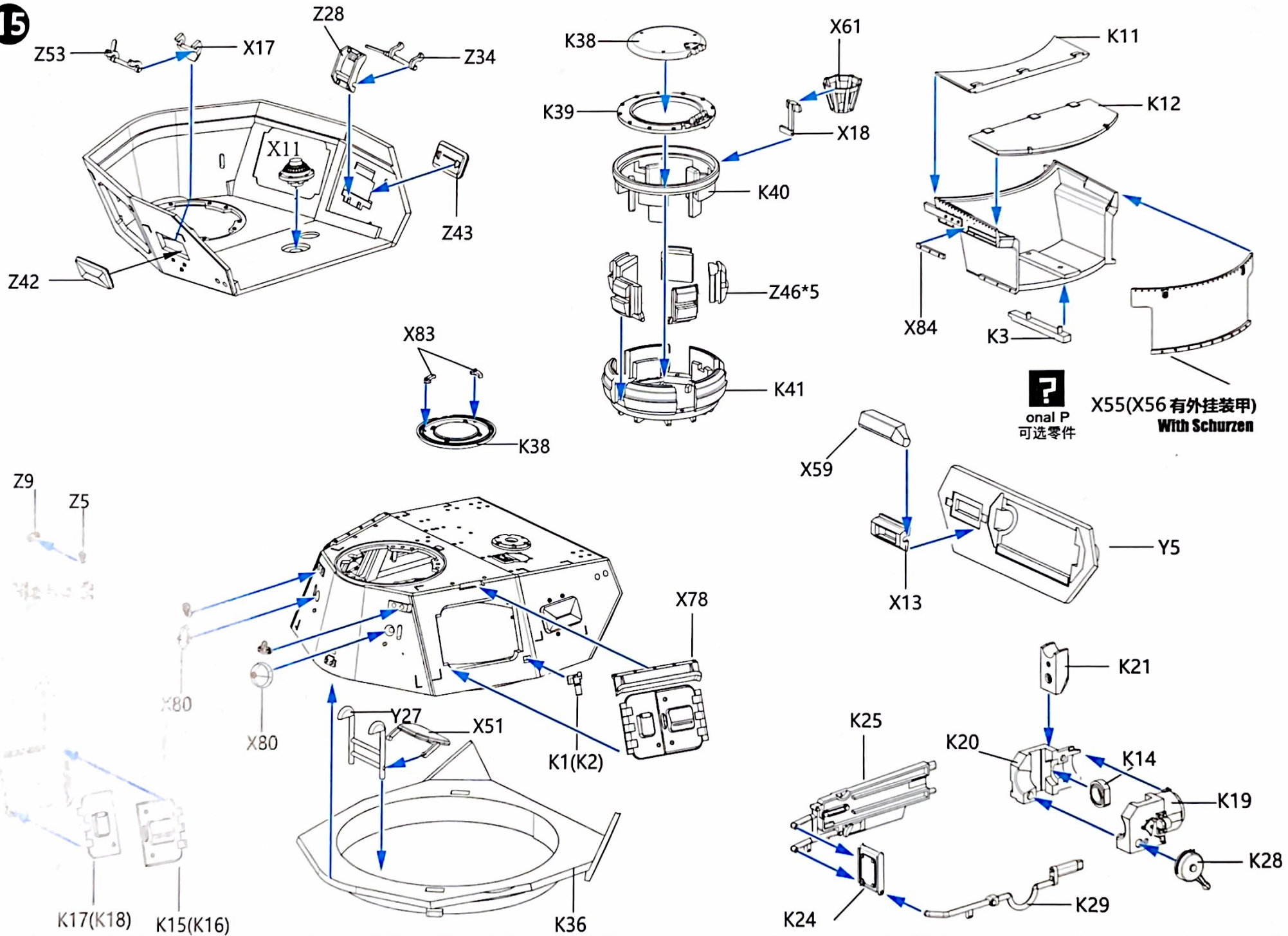

16

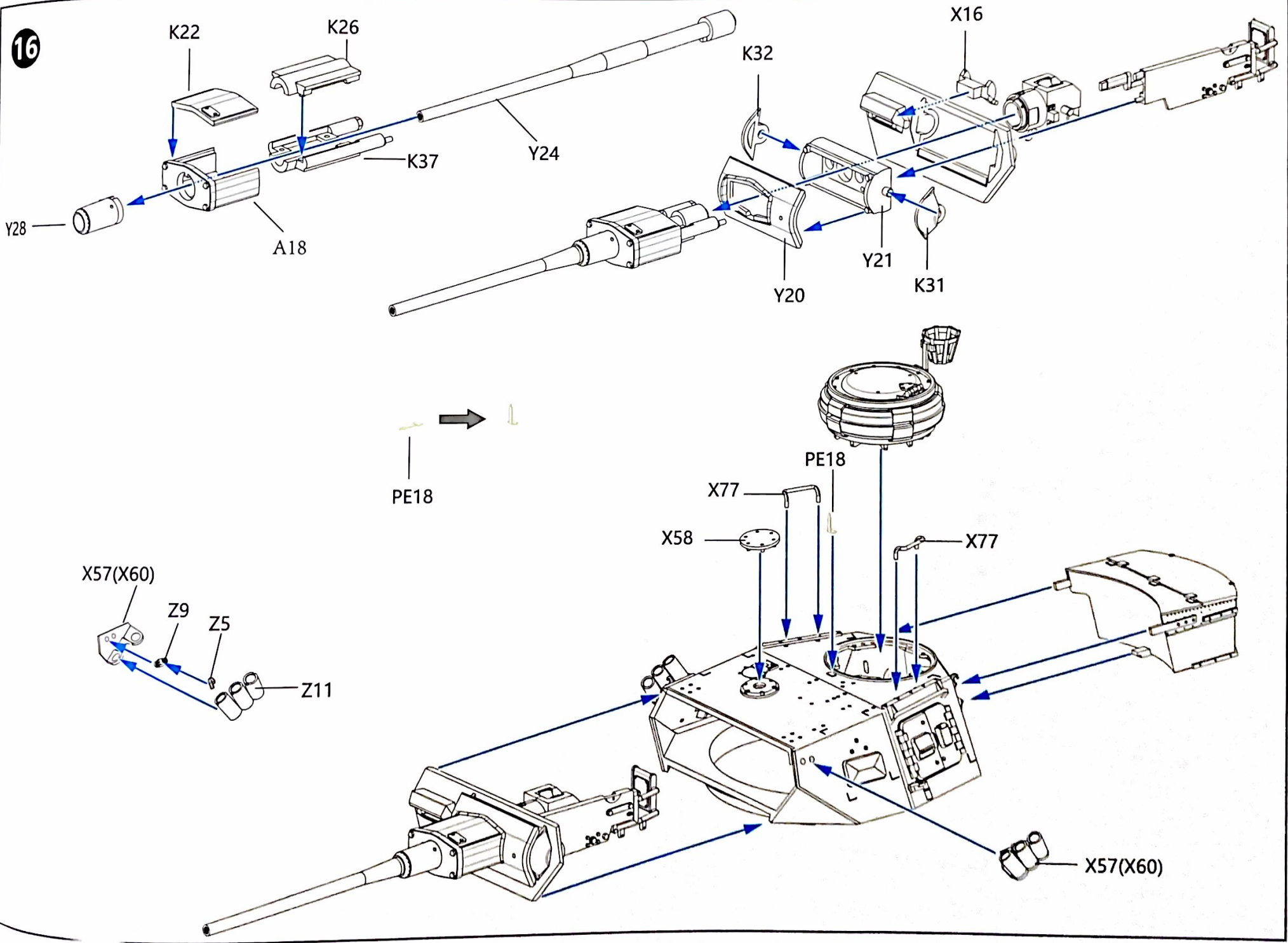

17

有外挂装甲型步骤  
WITH SCHURZEN

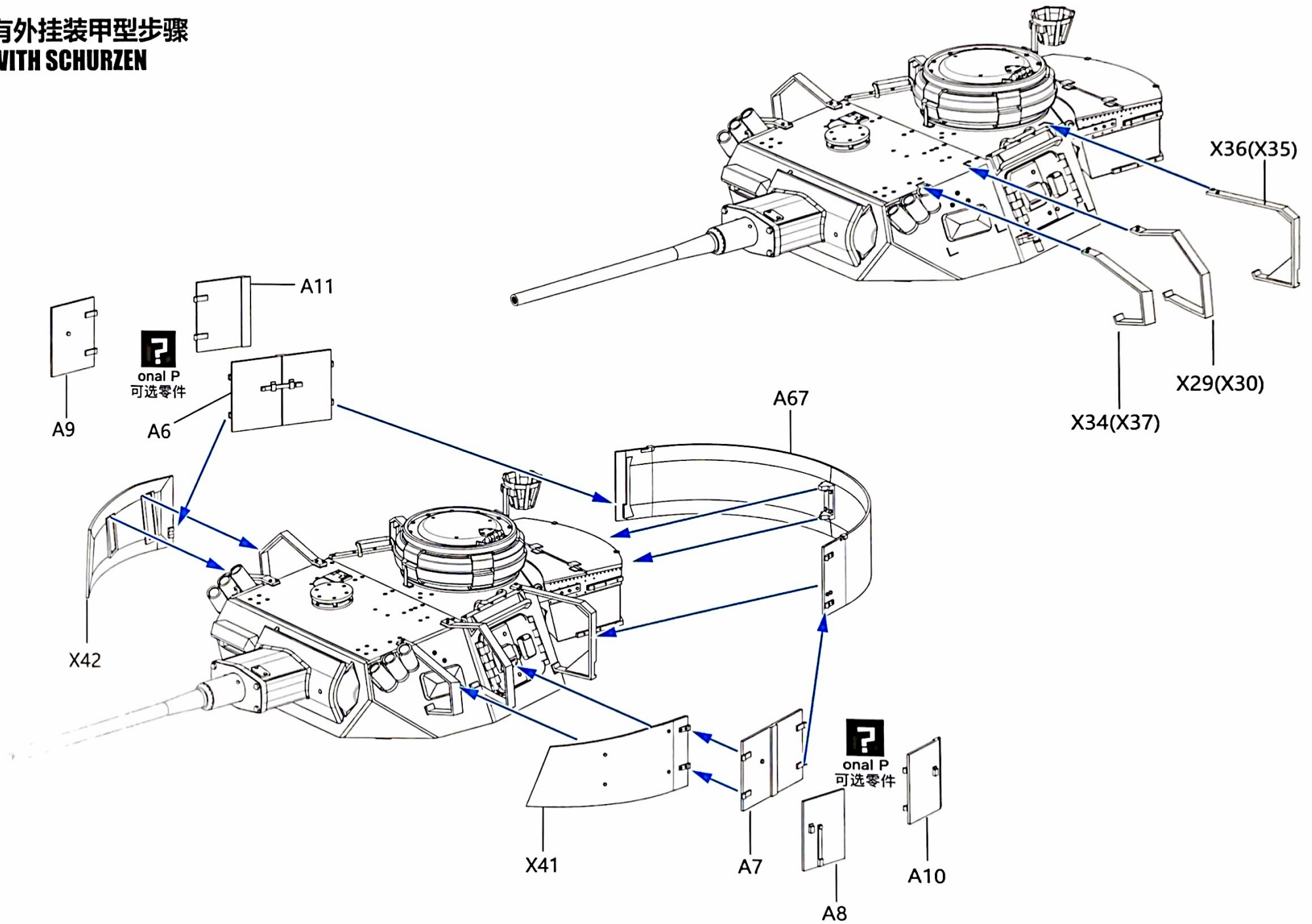

有外挂装甲型步骤 18  
WITH SCHURZEN

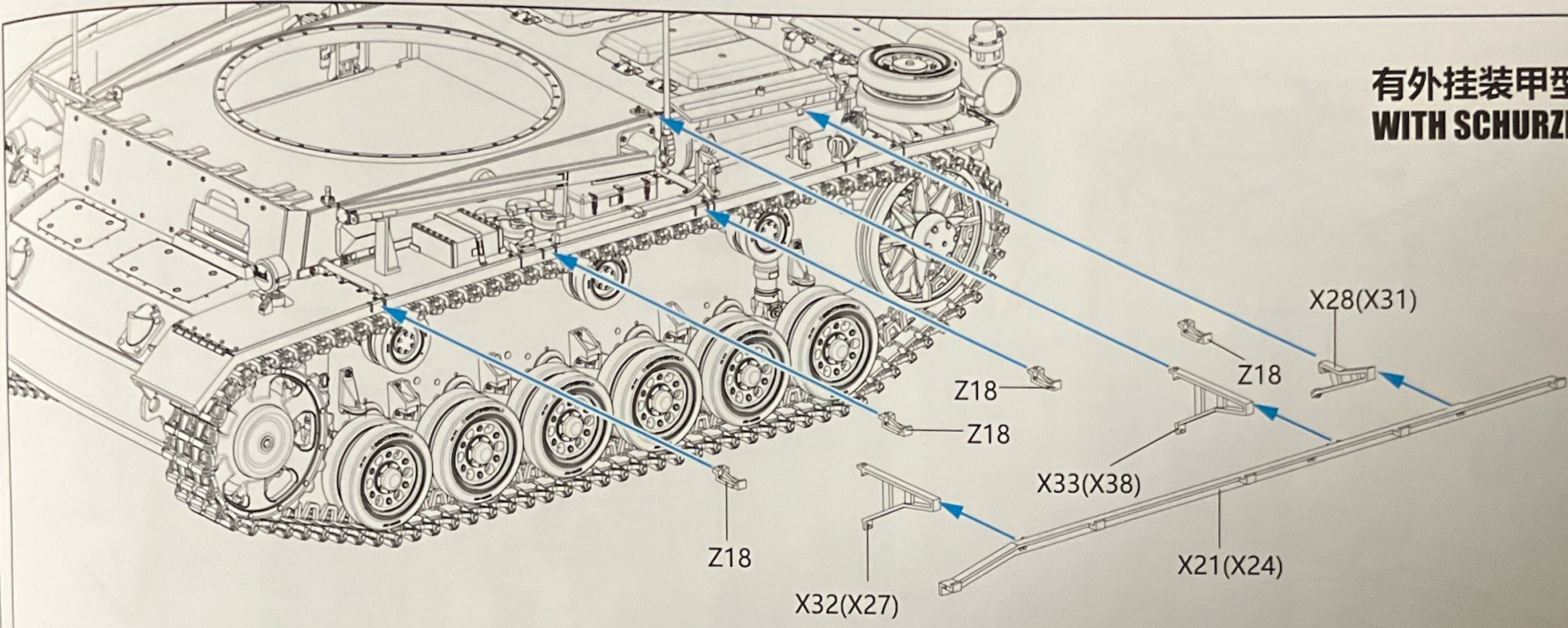

有外挂装甲型步骤 19  
WITH SCHURZEN

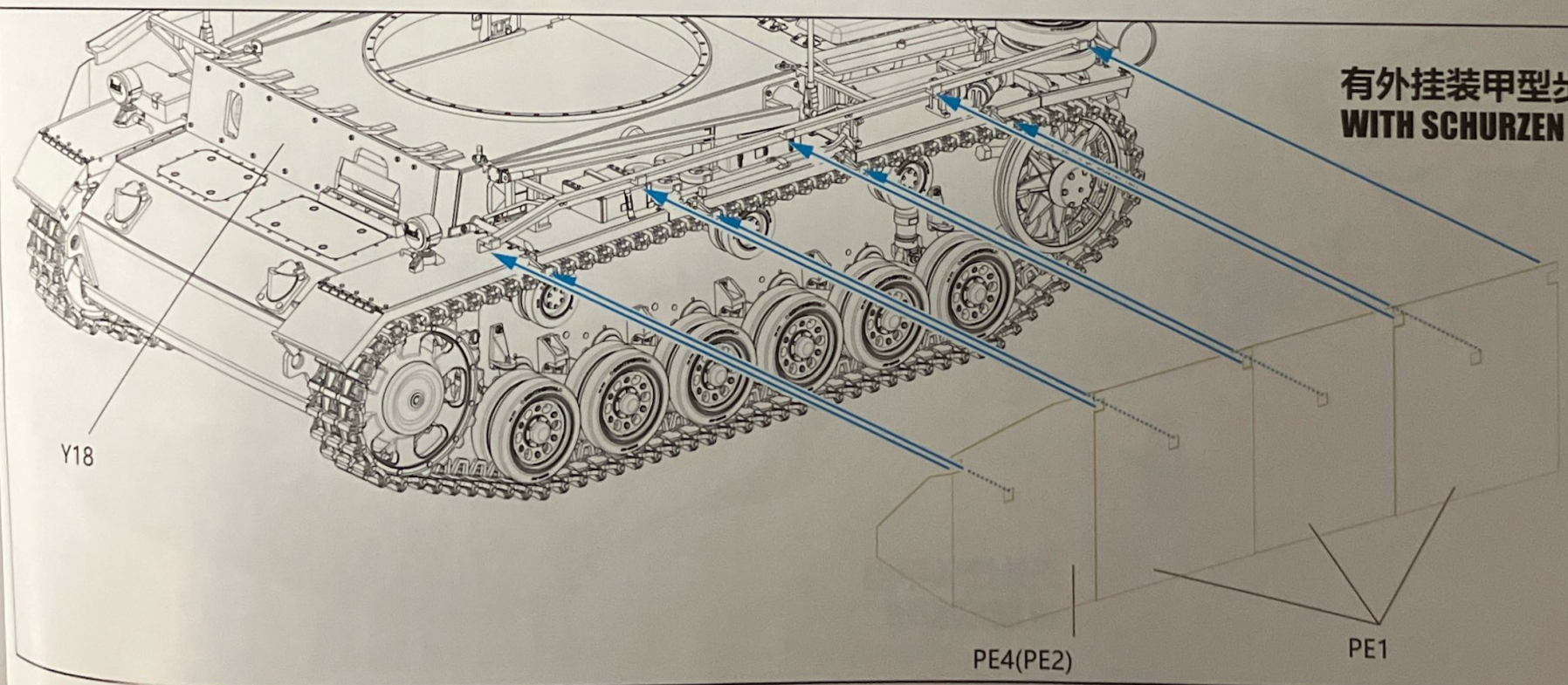

有外挂装甲型  
WITH SCHURZEN

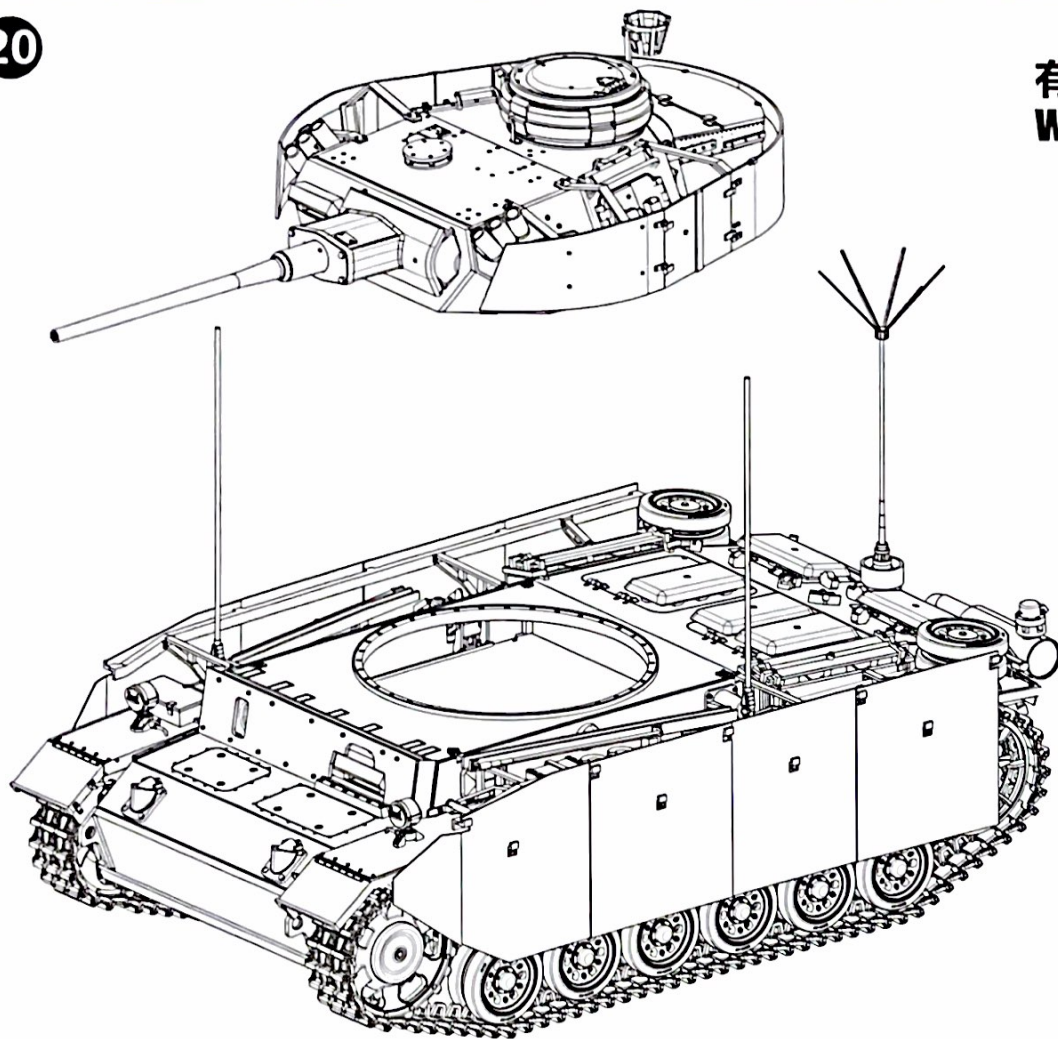

无外挂装甲型  
NO SCHURZEN

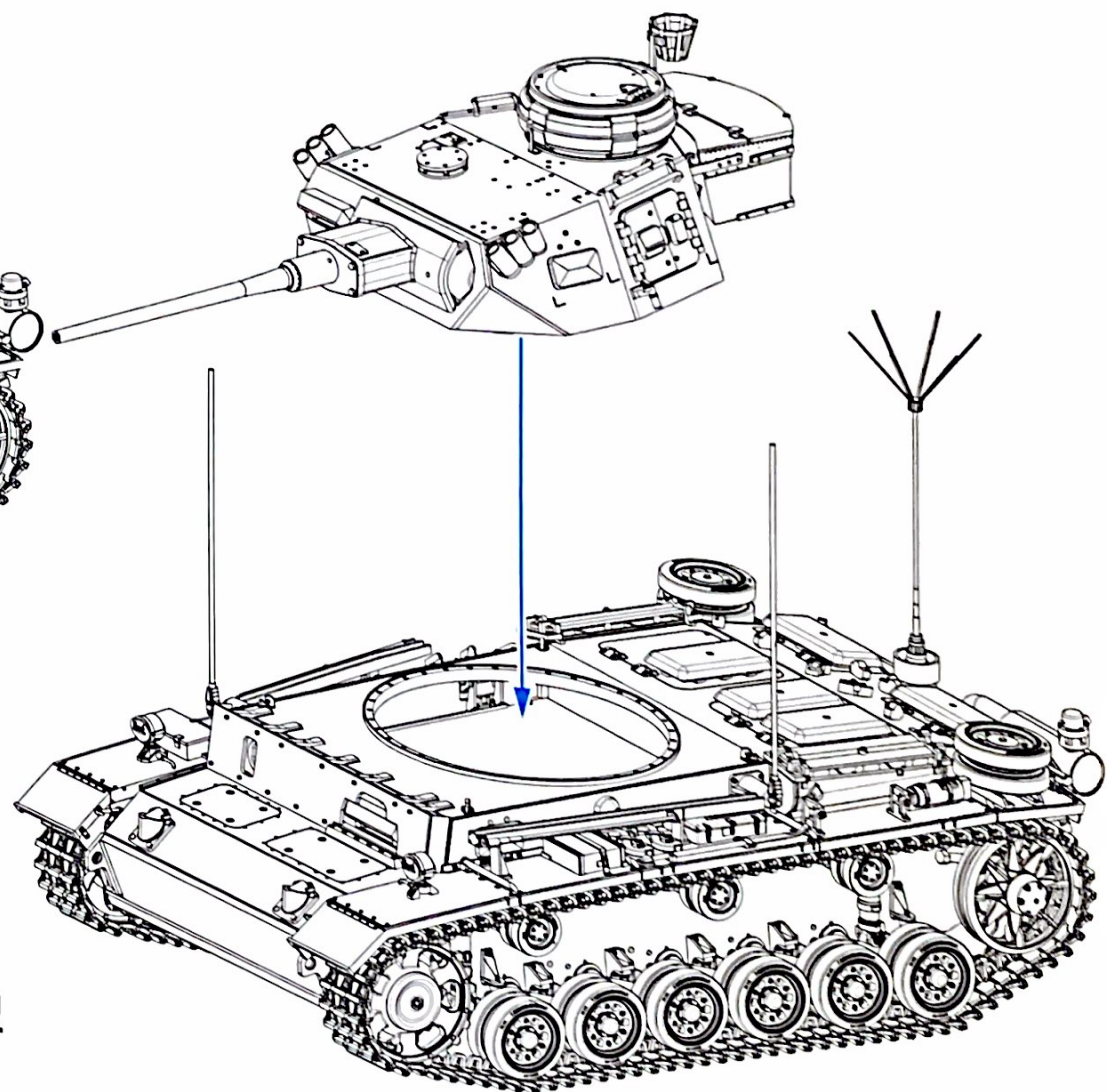

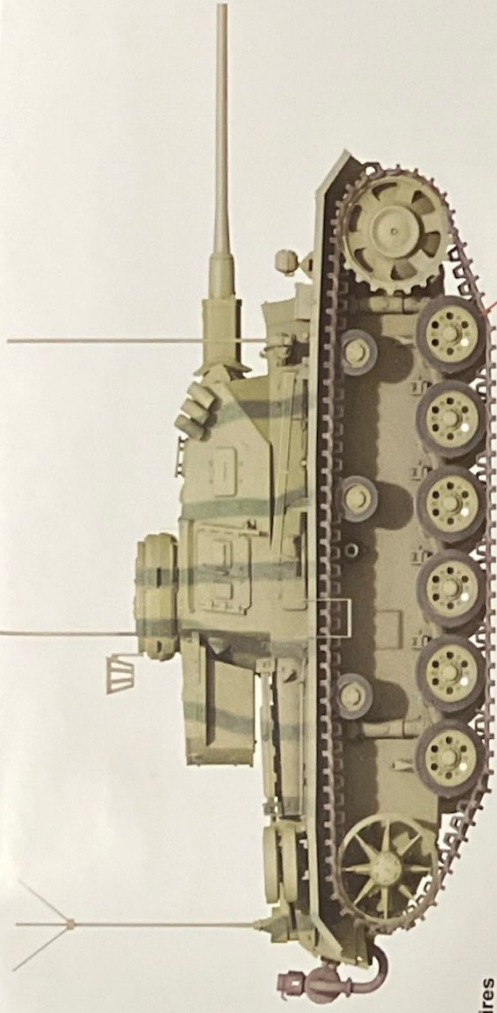

A.MIG-035

Gun Metal

A.MIG-033

Rubber & Tires

A.MIG-035

Dark Tracks

A.MIG-011

RAL 7028 DUNKELGELB AUS '44 DG I

A.MIG-003

RAL 6011 RESEDAGRÜN

A.MIG-033

A.MIG-003

A.MIG-187

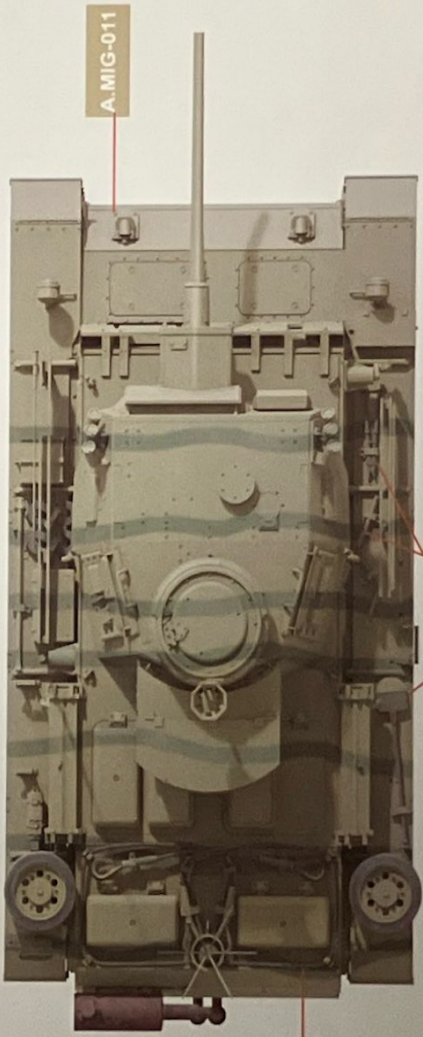

A.MIG-035

A.MIG-011

A.MIG-035



A.MIG-035

Border

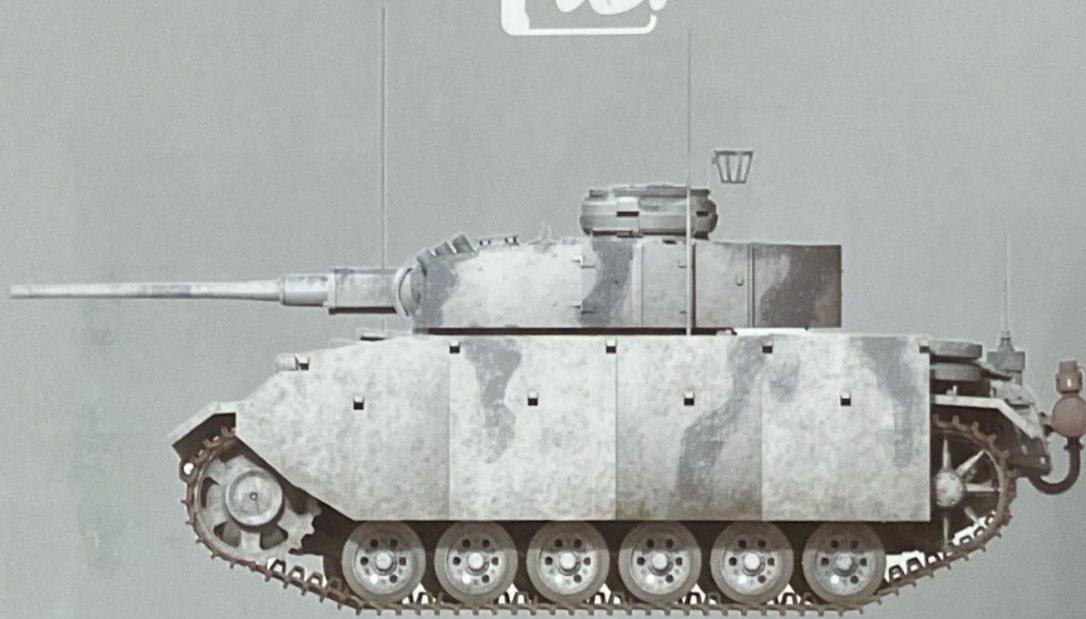

WWW.BORDERMODEL.COM