

35003

產品編號: 35003

scale 1/35

1:35 比例

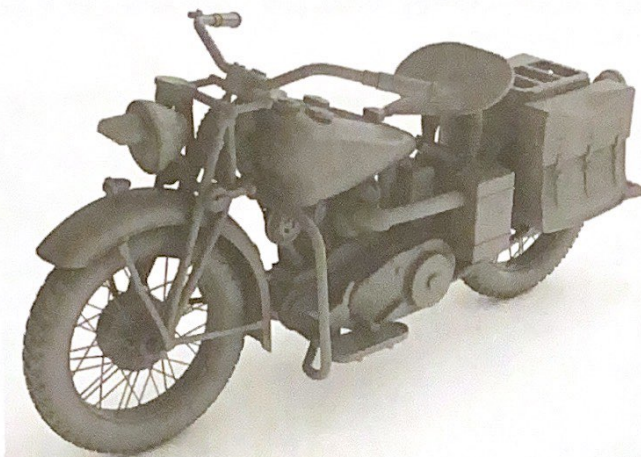

1/35 US Military Motorcycle Indian 741B

Go through this assembly guide and understand it before you start kit assembly
 You can download PDF assembly instruction file from our website to see closely zoomed assembly details
 Use usual plastic kit's cements and tools (not included in the kit)
 Follow painting guide supplied, use only hobby paints
 Work carefully with photo etched parts if included, use C/A glues to assemble them

請您在組裝此產品前仔細閱讀組裝指南;
 請使用通用塑膠模型黏合劑和工具(本產品不附帶);
 本產品所以提供的噴塗指南只適用本於模型;
 如果本產品含有蝕刻套件,請小心仔細處理,請使用C/A膠水組裝;

組み立て前にこの組み立てガイドをご覧ください。
 プラスチックキット専用接着剤と専用工具をご使用ください。(ともにキットには含まれていません)
 塗装ガイドに従ってください。専用塗料をご使用ください。
 エッチングパーツの組み立ては細かいパーツのため注意が必要です。また接着には瞬間接着剤を使用してください。

	cut/remove	切下 / 移除	切断/切り離し
	drill hole	鑽孔	ドリル穴
	no glue	不適用膠水	接着しない
	bend	折彎	折り曲げ
	cyanoacrylate glue	氰基丙烯酸酯膠水	瞬間接着剤
	string or wire	細繩或者金屬絲線	糸または金属線
	rope	繩	ひも
	paint area during assembly (ref. to AMMO colors)	裝配過程中的噴漆區域推薦 (請參考AMMO顏色)	組み立て時の塗装部分 (コード例: AMMOカラー)
	PE - press rivets (lines) from the etched off side	蝕刻片 - 請从蝕刻掉的一側壓铆釘 (线)	ラインやリベット部分を未エッチング面から圧を与える

The Indian Scout is a motorcycle built by the Indian Motor Cycle Company from 1920 to 1949. The 741B was most common Indian motorcycle made for military use in World War II, based on civilian Thirty-Fifty design. Bikes were mainly used by British and Commonwealth forces, and the company sold more than 30,000 units of this motor cycle.

The 640-B, a military version of the Sport Scout, was tested by the US Army and used in the United States, but not shipped overseas. Approximately 2,500 were produced

インディアンスカウトは、1920年から1949年までインディアンモーターサイクル社によって制作されたオートバイです。

741Bは、第二次世界大戦で軍用に使用された最も一般的なインディアンのオートバイで、民間の"サーティーフィフティ"スカウトのデザインを基にしています。このバイクは主に英国軍と連合国軍によって使用され、同社はこのモーターサイクルの30000台以上を販売しました。

スポーツスカウトの軍用バージョンである640-Bは、米国陸軍によってテストされ、米国で使用されましたが、海外には出荷されていません。

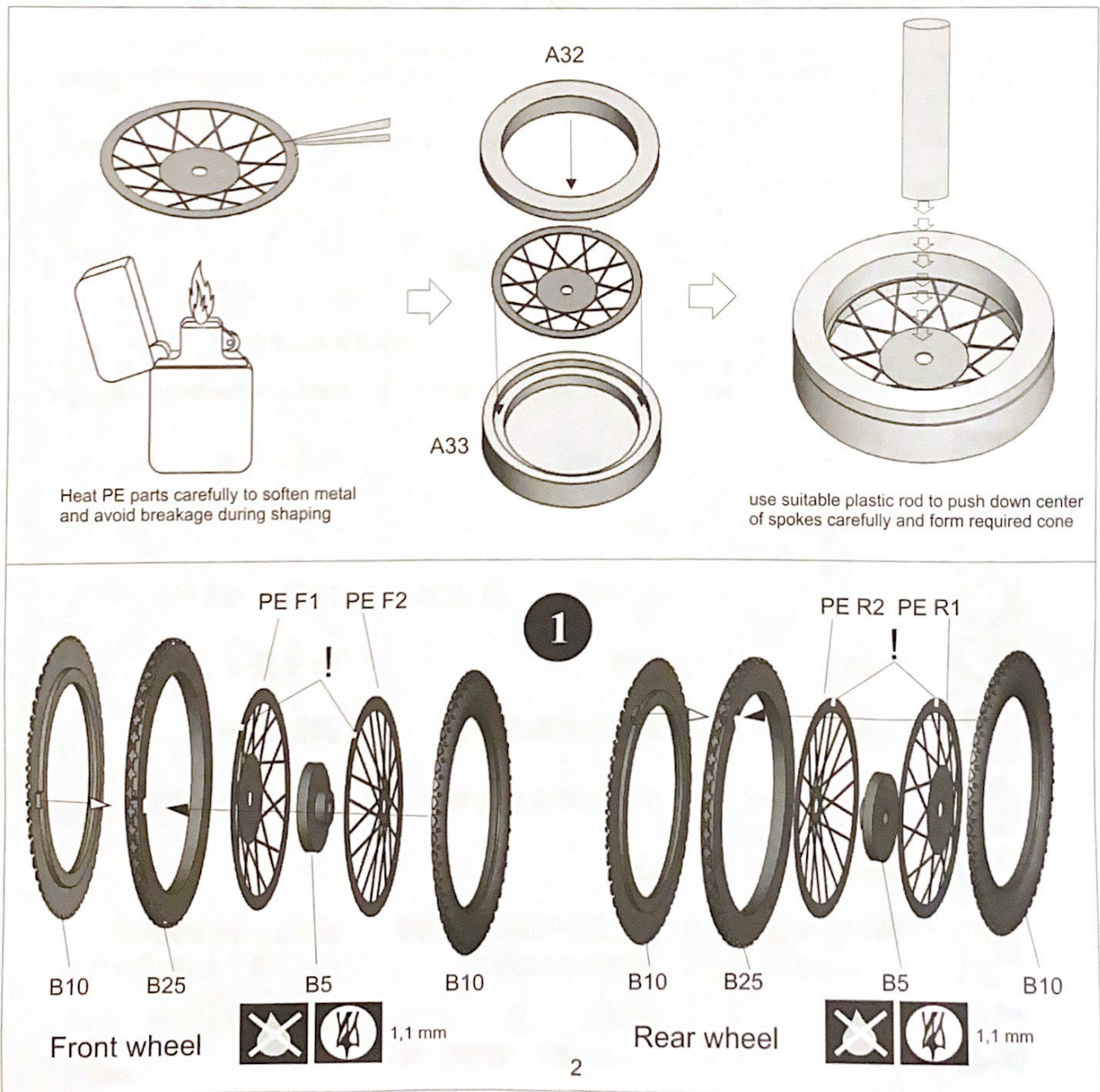

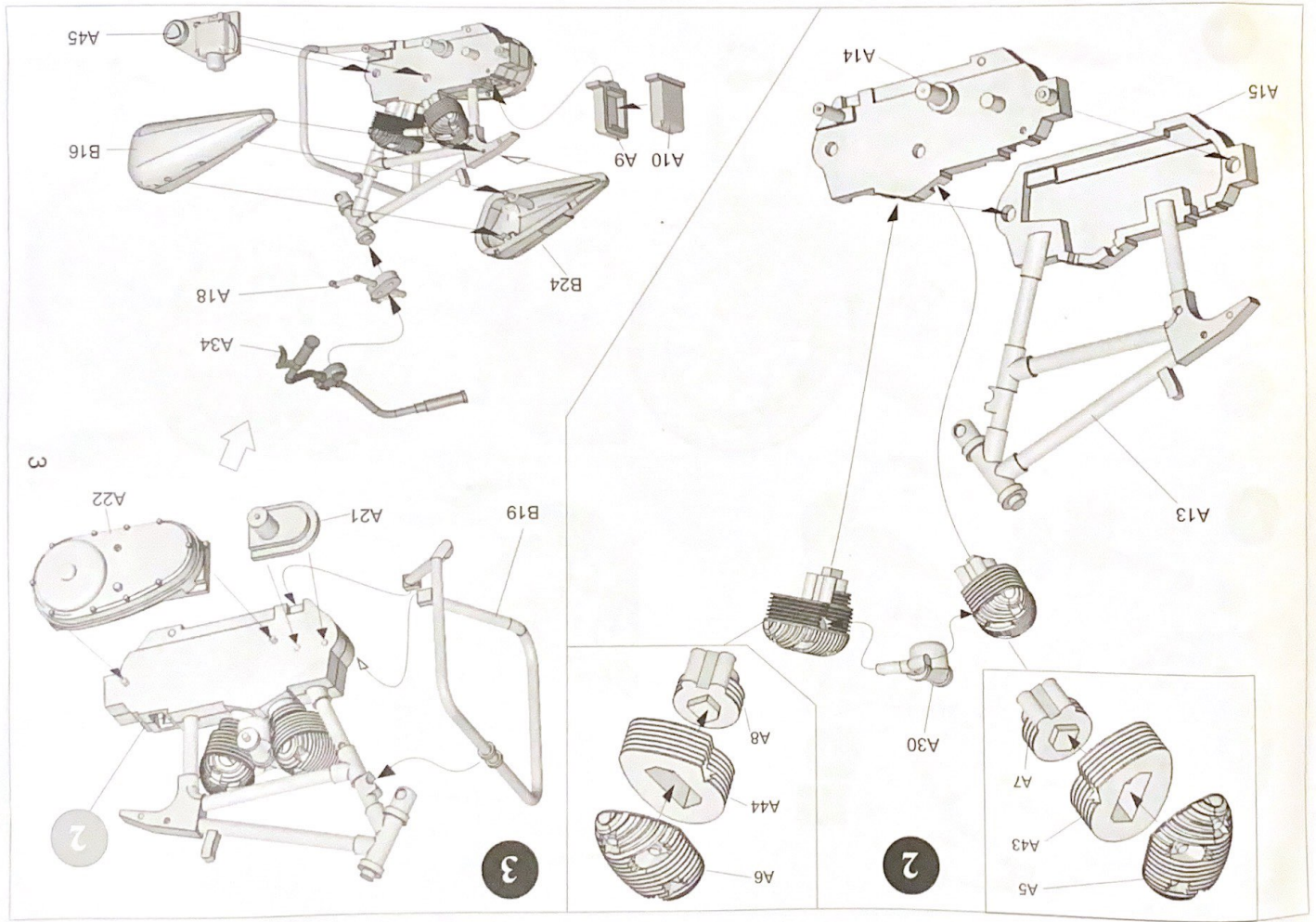

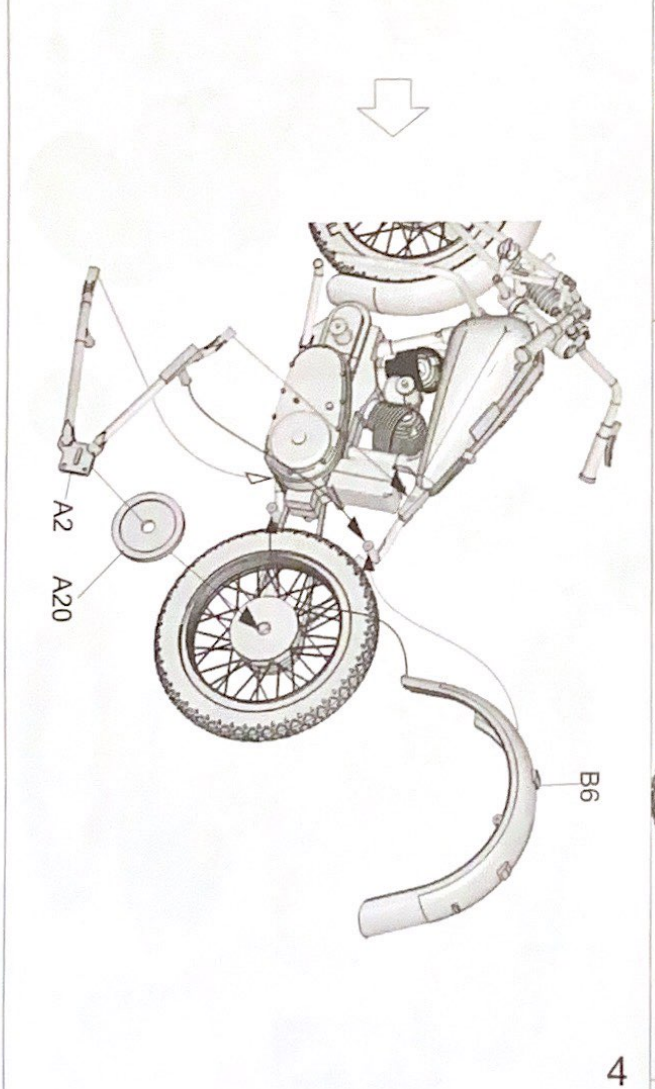
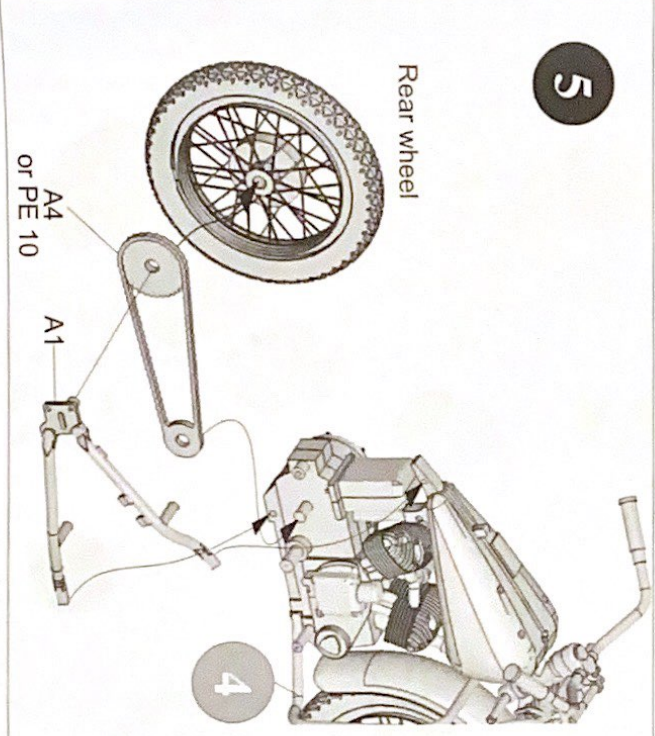
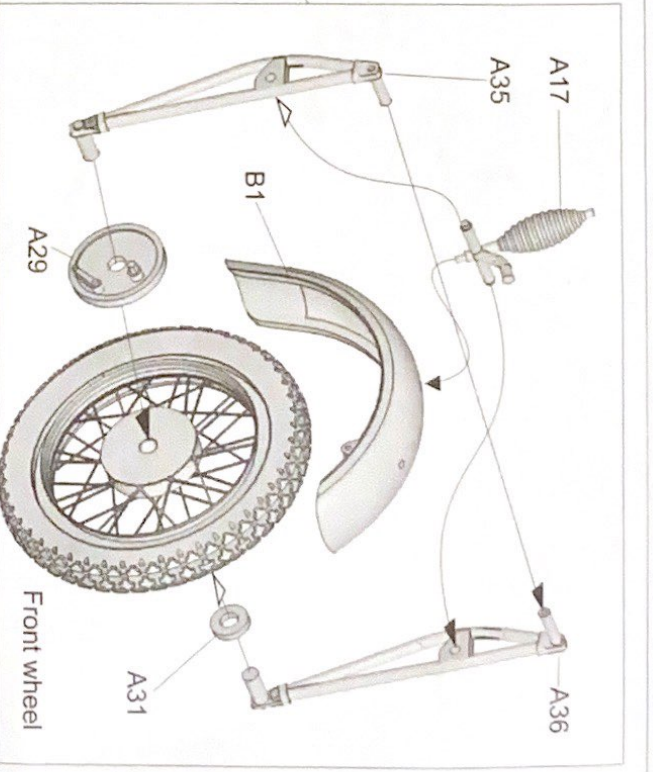
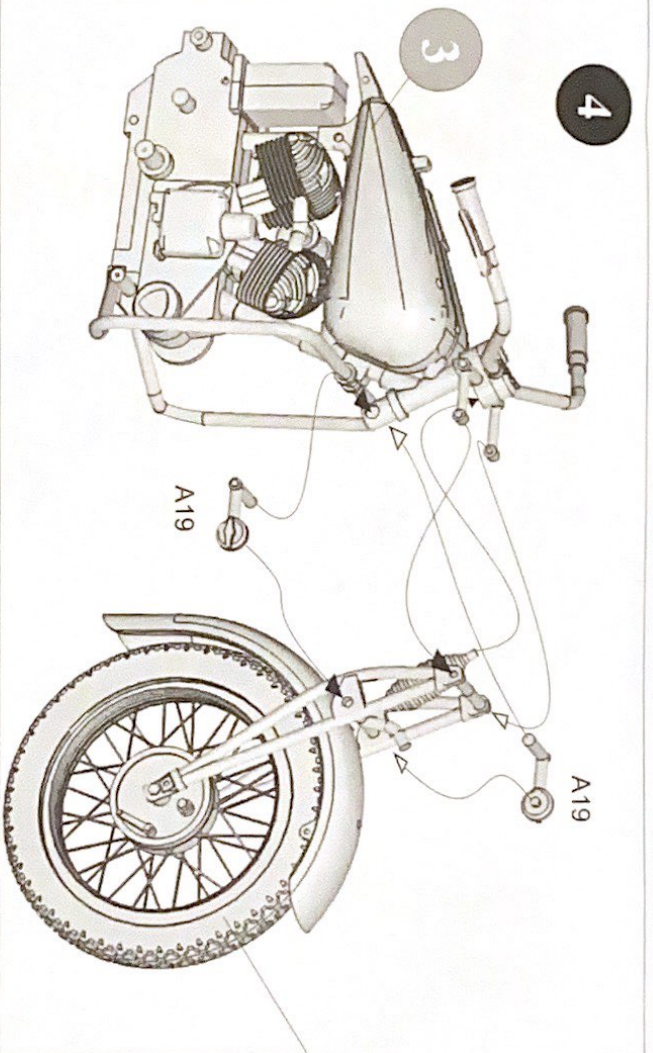

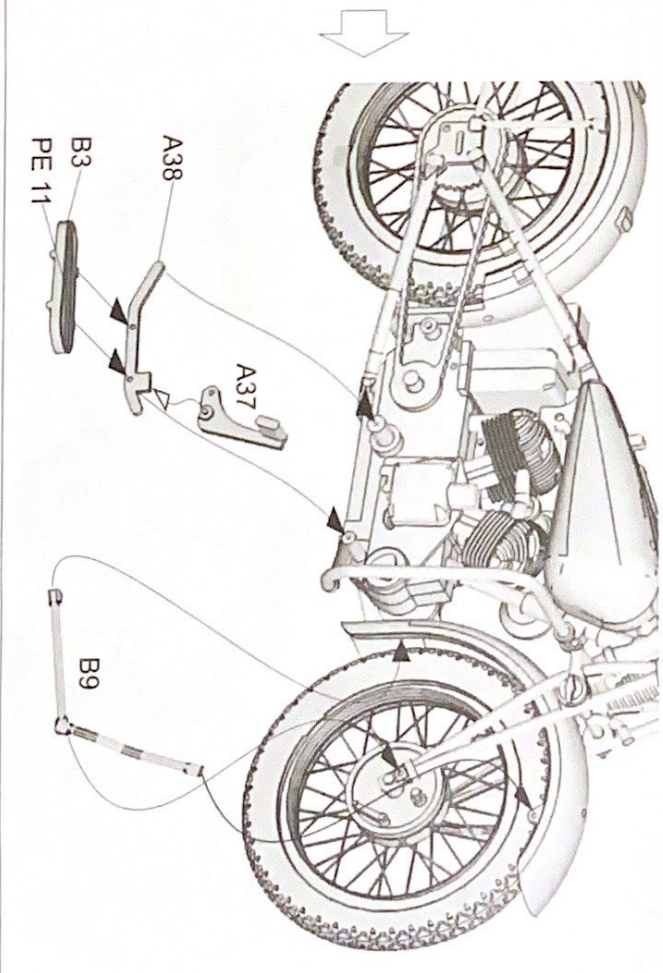
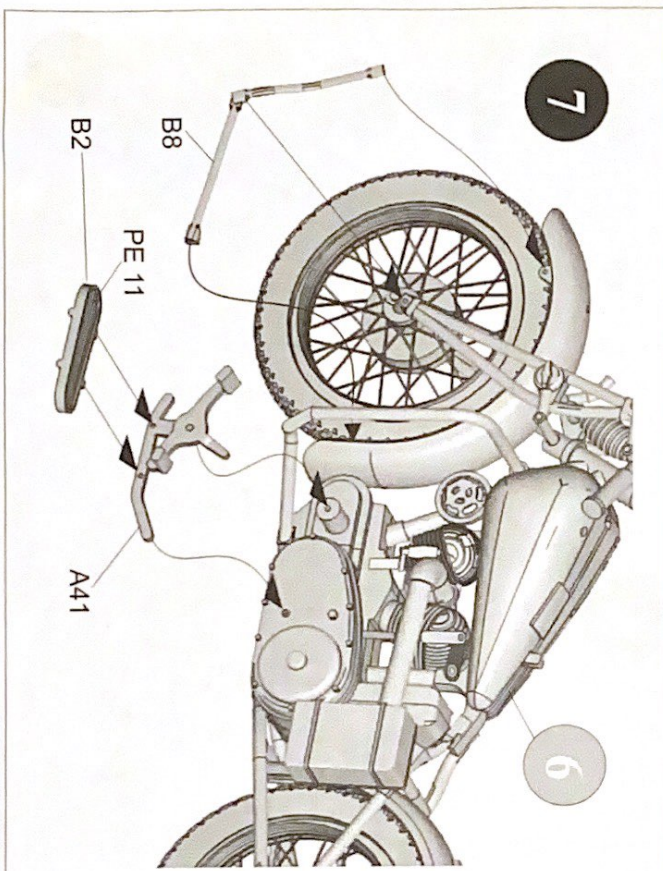
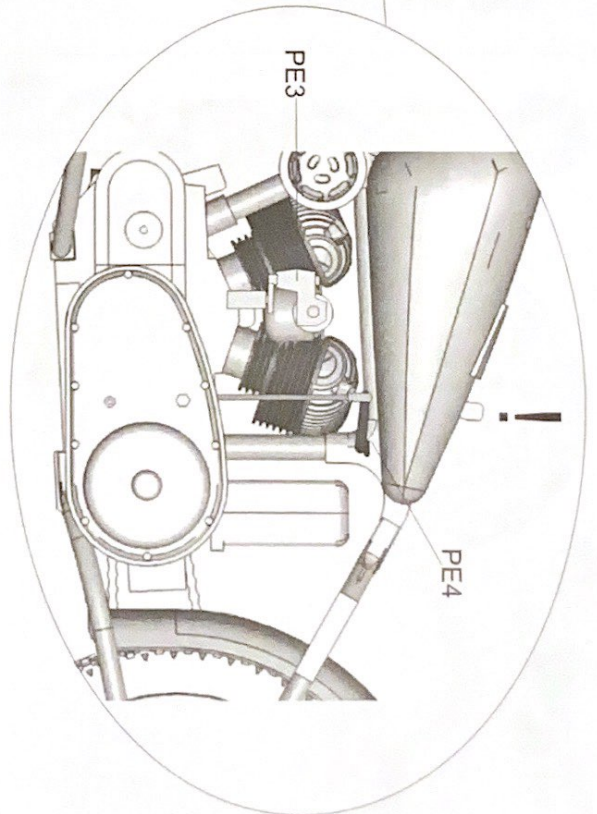
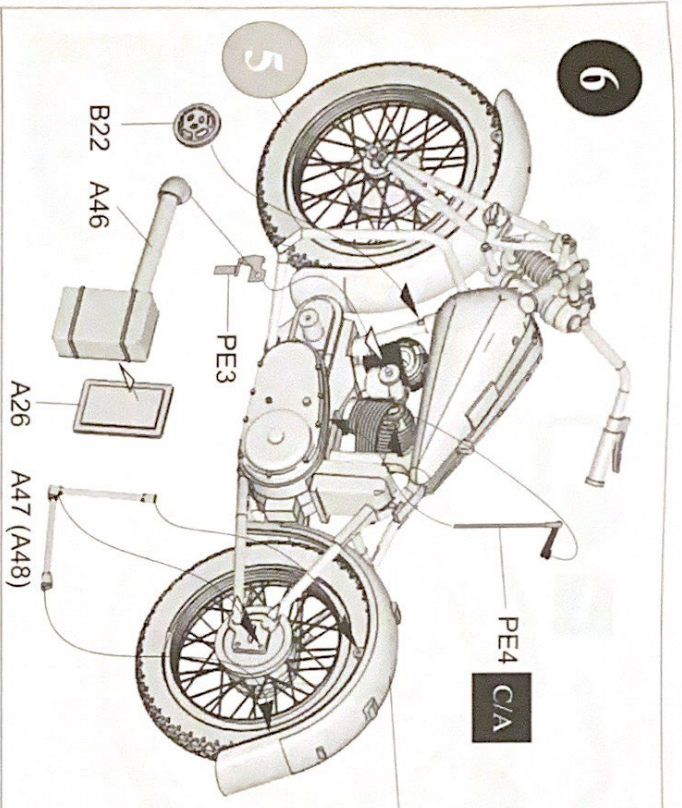

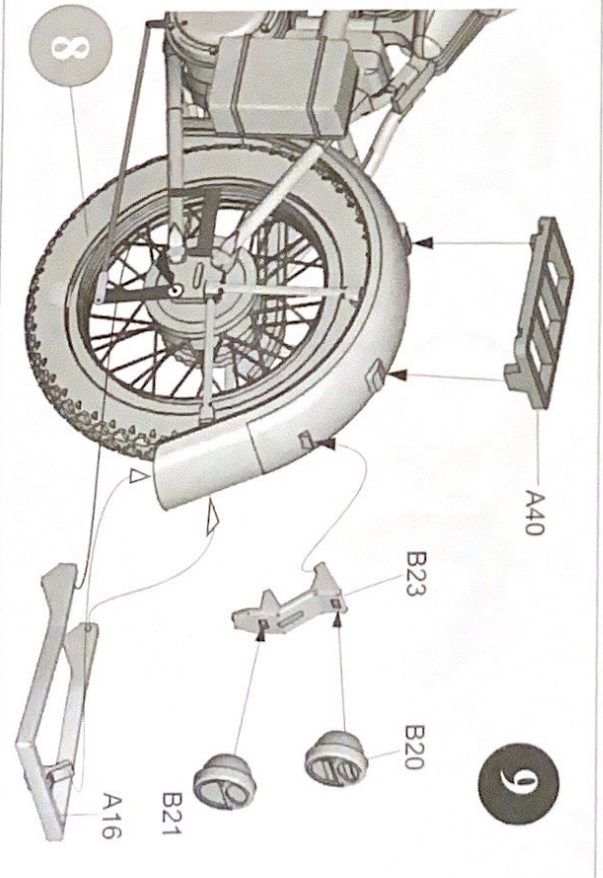
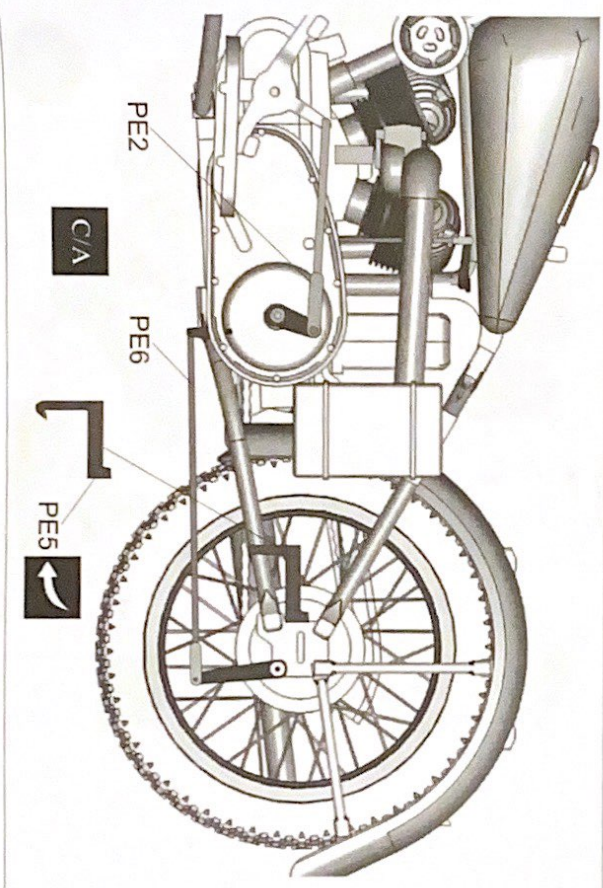
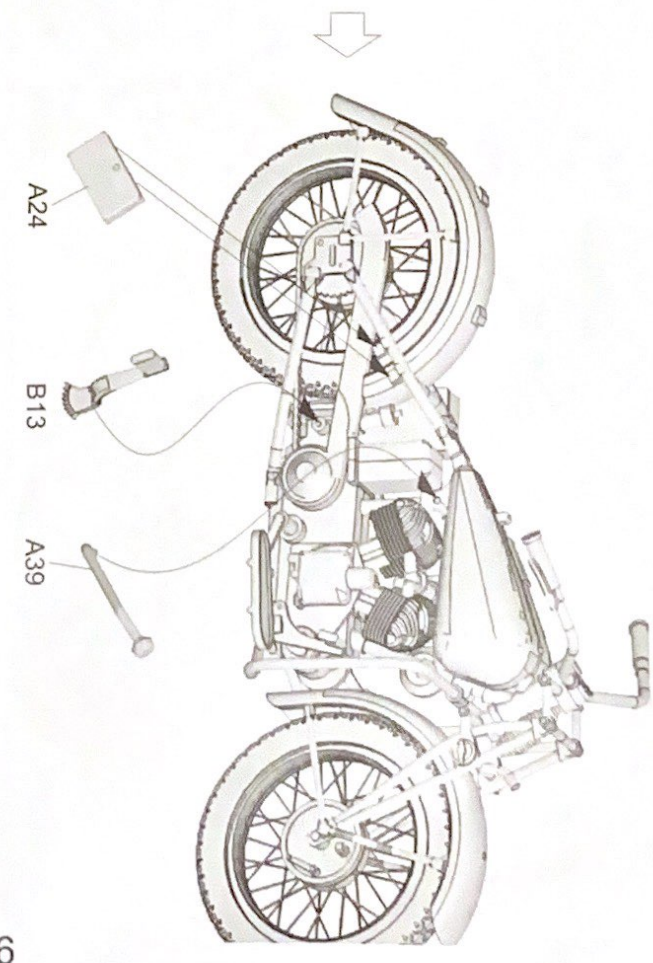
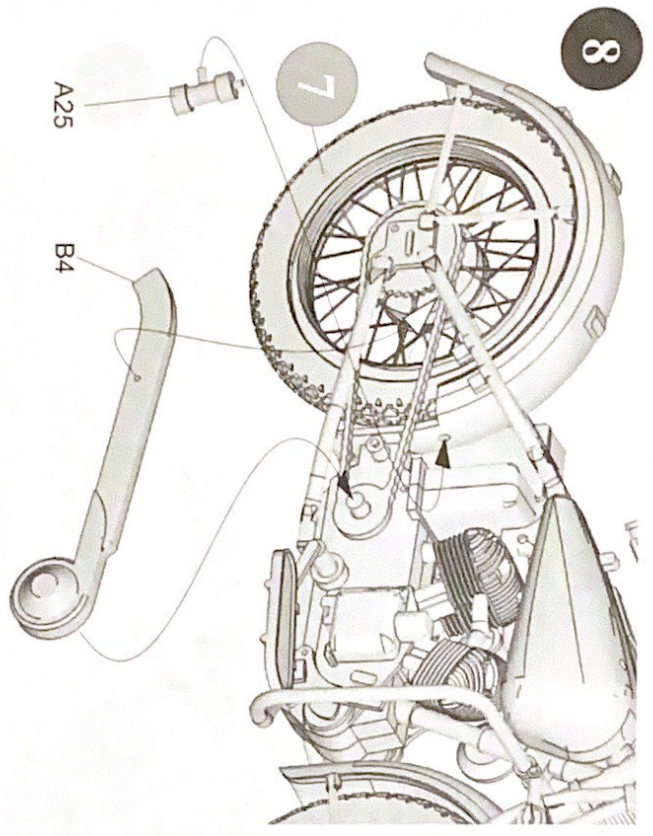

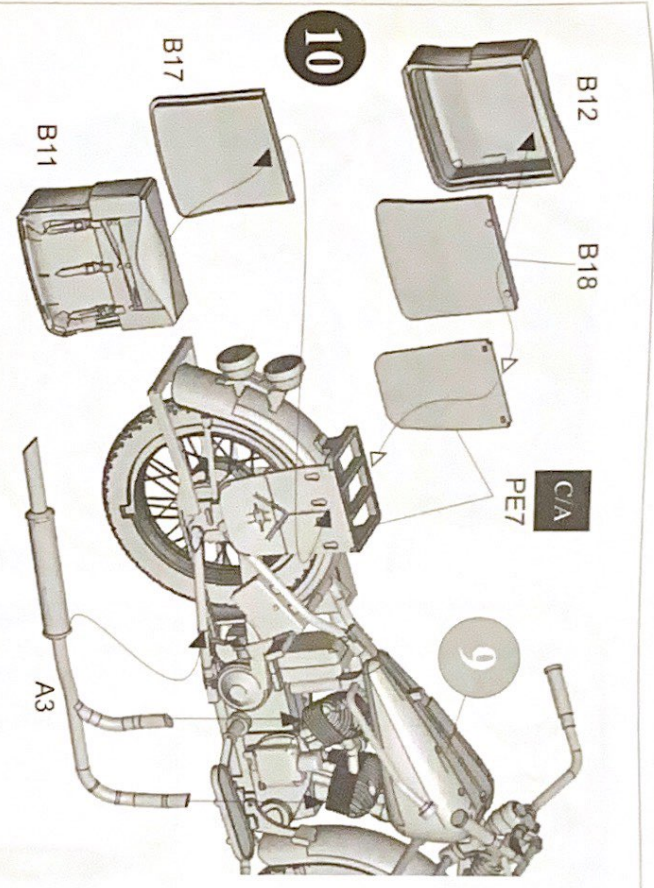

10

B12

B18

CA

9

A12

B7 or PE9

A11

B7 or PE9

?

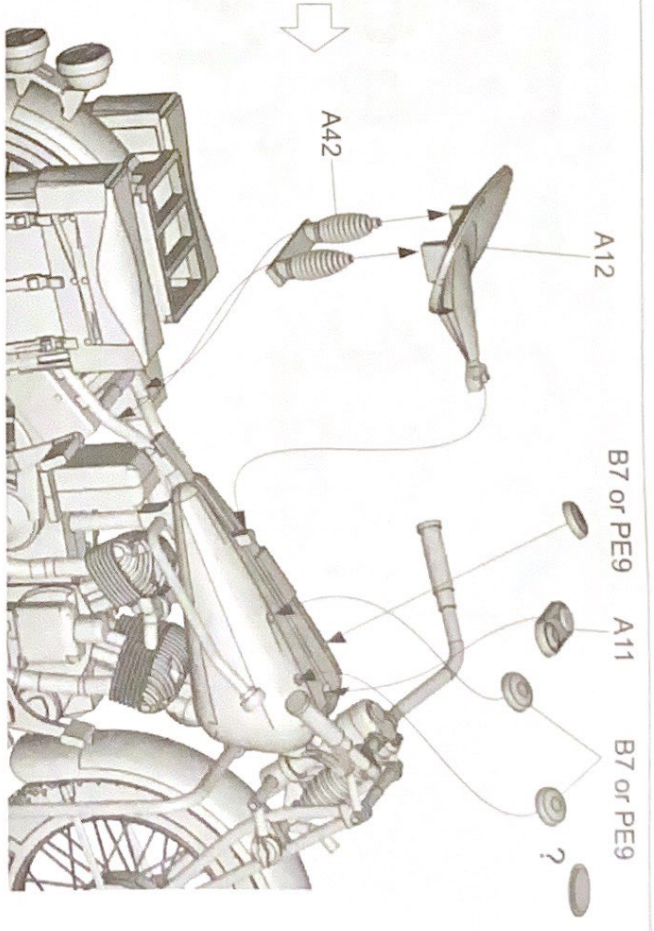

7

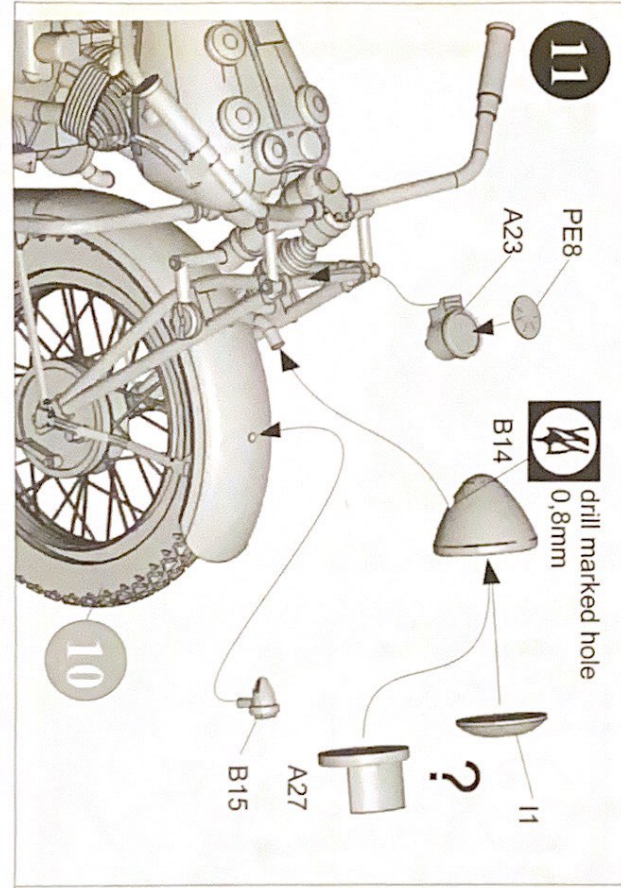

11

PE8

A23

CA

drill marked hole
0,8mm

B14

?

I1

A27

B15

10

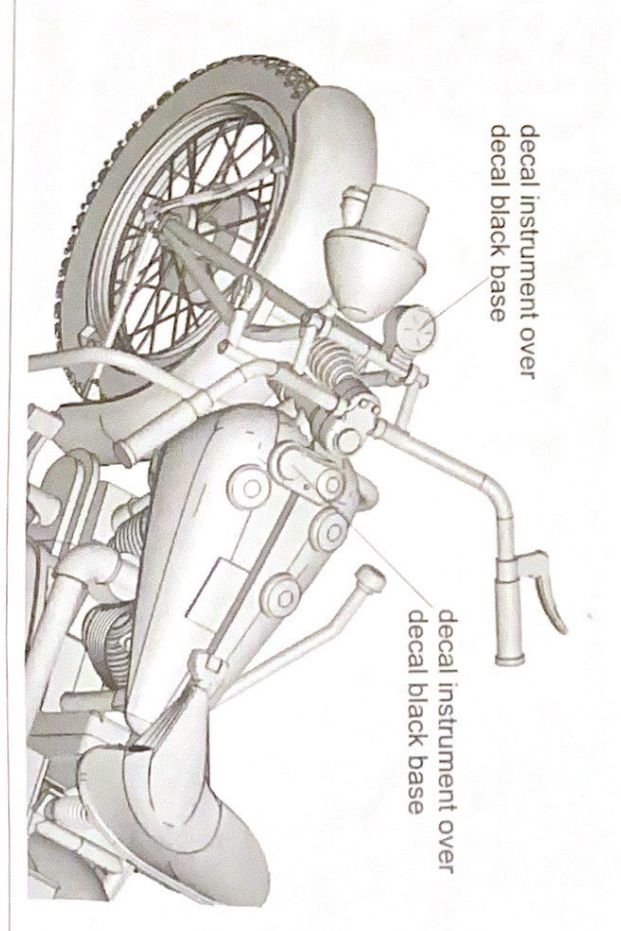

decals instrument over
decals black base

decals instrument over
decals black base

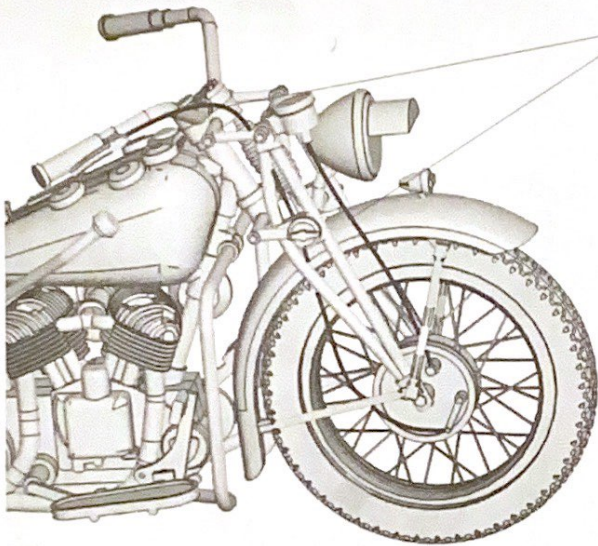

optional detail speed meter and brake linkage



0,2mm

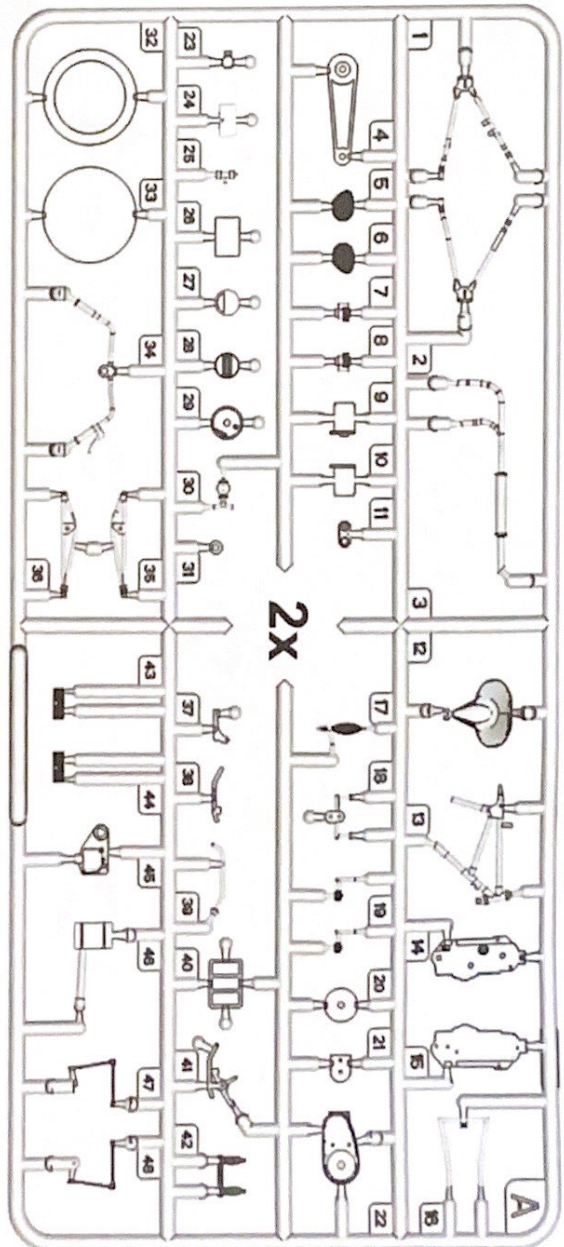
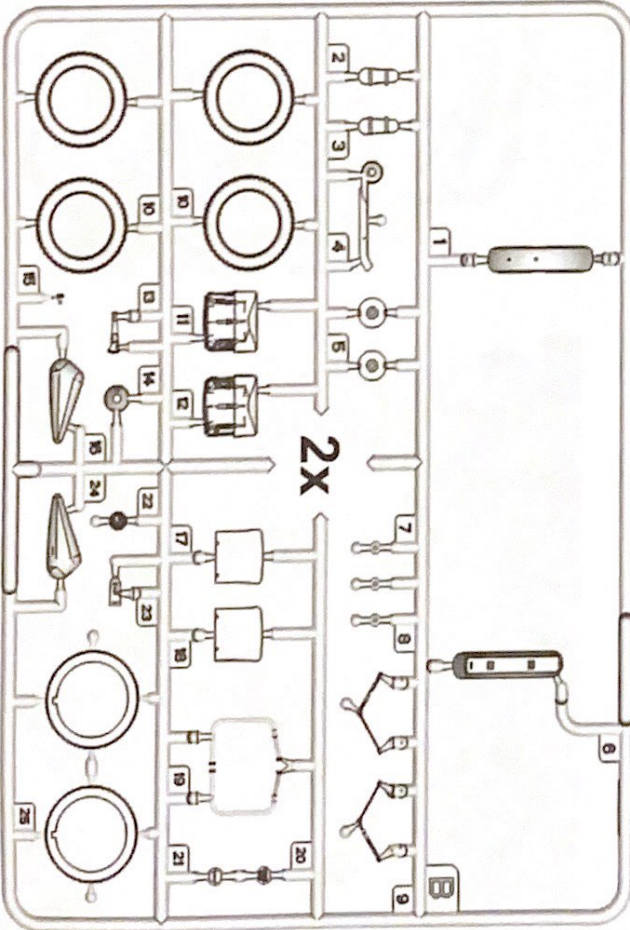

PE sheet x2
Decal sheet x1



www.migjimenez.com



MOTORCYCLE INDIAN 741B

Ref: TM-35003

Painting and Marking Guide

AMIG 033 Rubber & Tires

AMIG 093 Crystal Red

AMIG 094 Crystal Glass

AMIG 133 Red Leather

AMIG 192 Polished Metal

AMIG 194 Matt Aluminium

AMIG 926 Olive Drab Base

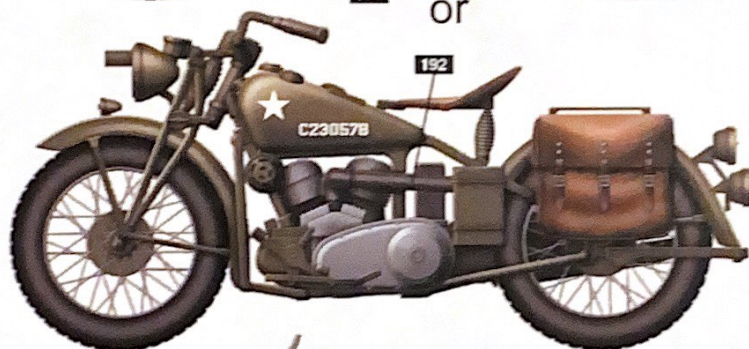

black base + instrument

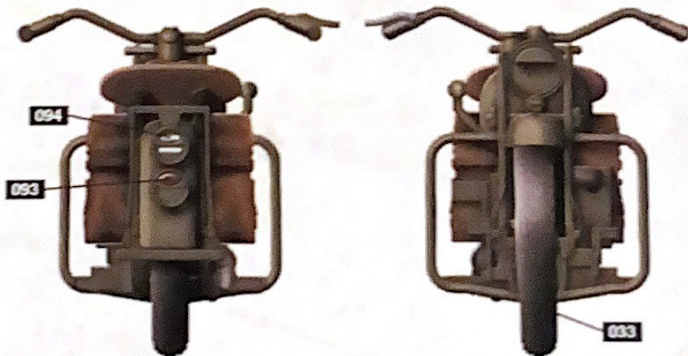
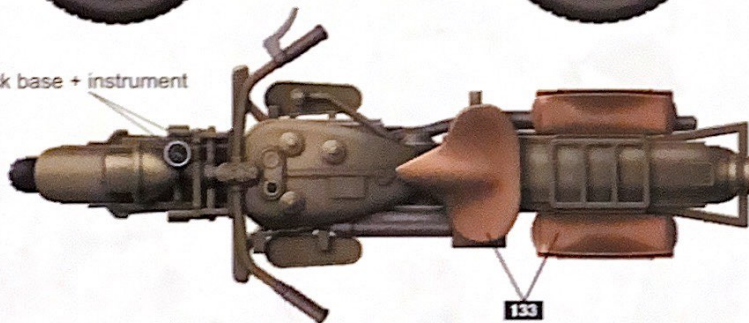

WEATHERING STEPS WITH AMMO PRODUCTS

1 GENERAL PAINT

A.MIG-1005 Dark Green for Green

2 FILTER

A.MIG-1807 TAN for Yellow Green

3 GREASE

A.MIG-1407 Engine Grease

4 DUST

A.MIG-3004 Europe Earth

5 MUD

A.MIG-1704 Heavy Earth

6 MUD SPLASHES

A.MIG-1754 Damp Earth

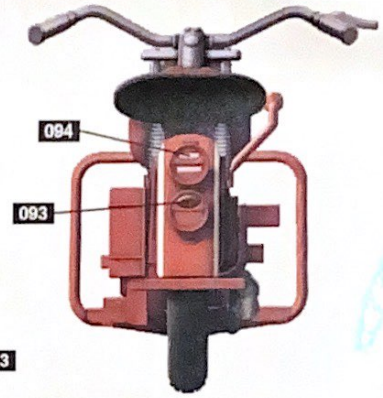
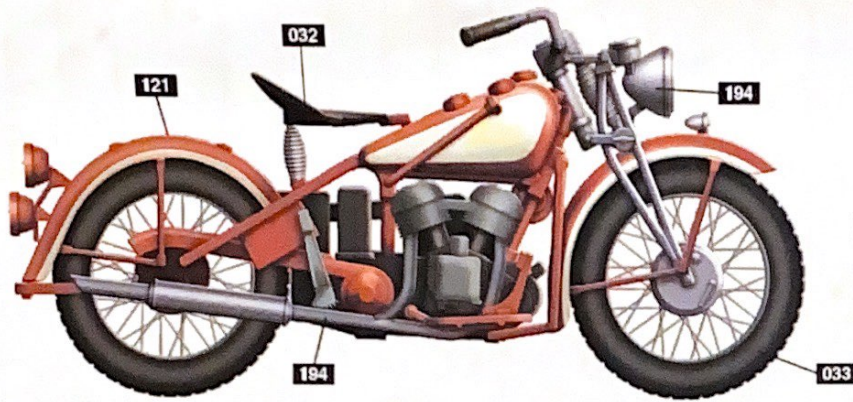

WEATHERING STEPS WITH AMMO PRODUCTS

1 GENERAL WASH

A.MIG-1002 Track Wash

2 FILTER

A.MIG-1500 Brown for White

3 GREASE

A.MIG-1407 Engine Grime

4 DUST

A.MIG-3004 Europe Earth

5 MUD

A.MIG-1704 Heavy Earth

6 MUD SPLASHES

A.MIG-1754 Damp Earth

A.MIG 032 Satin Black

A.MIG 093 Crystal Red

A.MIG 192 Polished Metal

A.MIG 033 Rubber & Tires

A.MIG 094 Crystal Glass

A.MIG 194 Matt Aluminum

A.MIG 047 Satin White

A.MIG 121 Blood Red

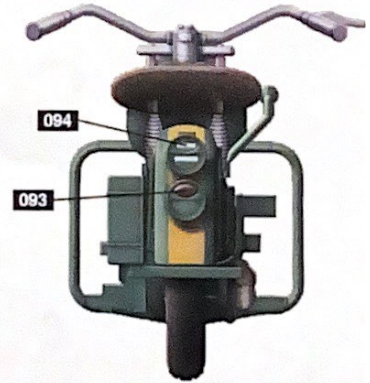
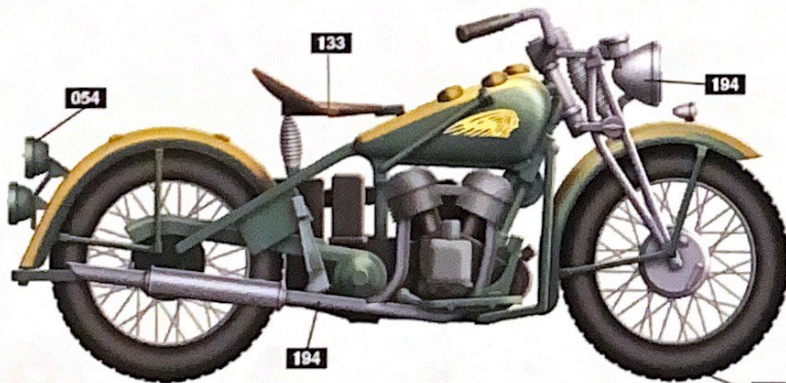

WEATHERING STEPS WITH AMMO PRODUCTS

1 GENERAL WASH

A.MIG-1006 Dark Brown for Green

2 FILTER

A.MIG-1508 Green for Grey Green

3 GREASE

A.MIG-1407 Engine Grime

4 DUST

A.MIG-3004 Europe Earth

5 MUD

A.MIG-1704 Heavy Earth

6 MUD SPLASHES

A.MIG-1754 Damp Earth

A.MIG 033 Rubber & Tires

A.MIG 094 Crystal Glass

A.MIG 192 Polished Metal

A.MIG 054 Signal Green

A.MIG 125 Satin Yellow

A.MIG 194 Matt Aluminum

A.MIG 093 Crystal Red

A.MIG 133 Red Leather